

Retail Unit 2[5]

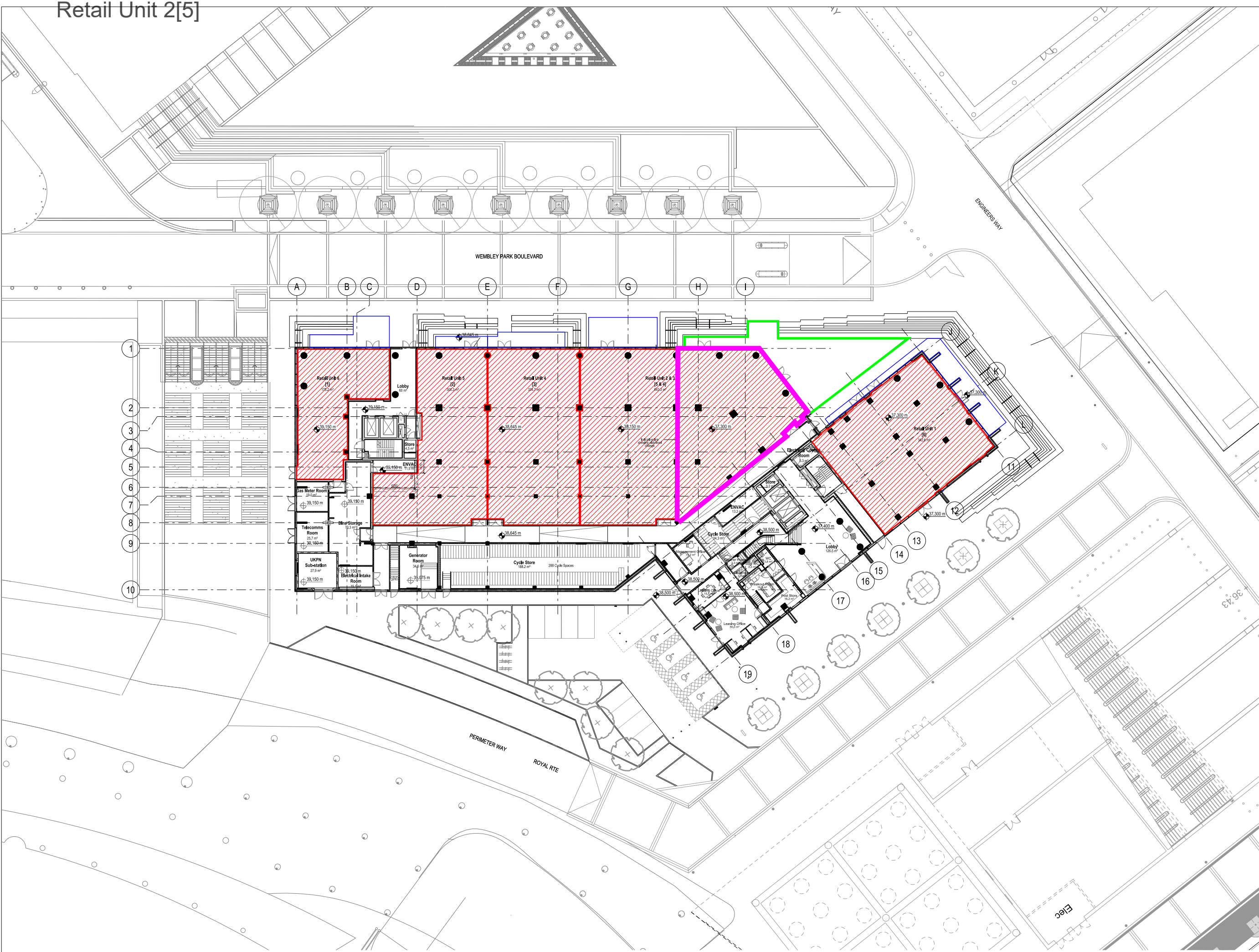

**Drawing Record**

Rev	Date	By	Comments	Checked
P01	08.01.2019	AV	FIRST ISSUE	LP

**KEY:**

- ALCOHOL LICENSED UNITS
- EXTERNAL LICENSED AREAS

Key Plan

**SIGNIFICANT HEALTH AND SAFETY RISKS (UNUSUAL AND DIFFICULT TO MANAGE ONLY)**

It is assumed that all works will be carried out by a competent contractor working where appropriate, to an approved method statement. In addition to the hazards/risks normally associated with the types of work detailed on this drawing, note the following:

**PRELIMINARY**

Client

QUINTAIN ESTATES

Consultants

**leslie jones architecture**

Suite 3.02 Grand Union Studios  
332 Ladbroke Grove  
London W10 5AD

Telephone 020 7255 1150  
E-mail admin@leslie-jones.co.uk

Job Title

WEMBLEY RETAIL CURATION

Drawing Title

WEMBLEY  
W03  
UNIT 3 SITE PLAN  
ALCOHOL LICENSED AREAS

Scale @ A3	Date	Drawn	Checked
1:500	JAN 2019	AV	LP

Job No.	Drawing No.	Revision
3 6 7 4	A T (0, 3)	1, 3, 8, 0, 0 P, 0, 1

