

Police additional evidence



Photos taken 23/10/18 Outside the front with residential windows open above. Nuisance control; Officer standing in smoking area, this would also have to accommodate customers queuing to enter.

Police additional evidence



Reception area where promoter, door supervisors will be located for searching, payment and the applicants suggested use of an ID scanner.

Police additional evidence



Reception area showing the narrow and steep stair in to the basement, main area of the venue.

Police additional evidence



Narrow steep staircase taken from the bottom, only one handrail. No lighting. To avoid slips and trips mixed with alcohol consumption the steps are only suitable for one direction footfall.

Police additional evidence



Base of the steps

Police additional evidence

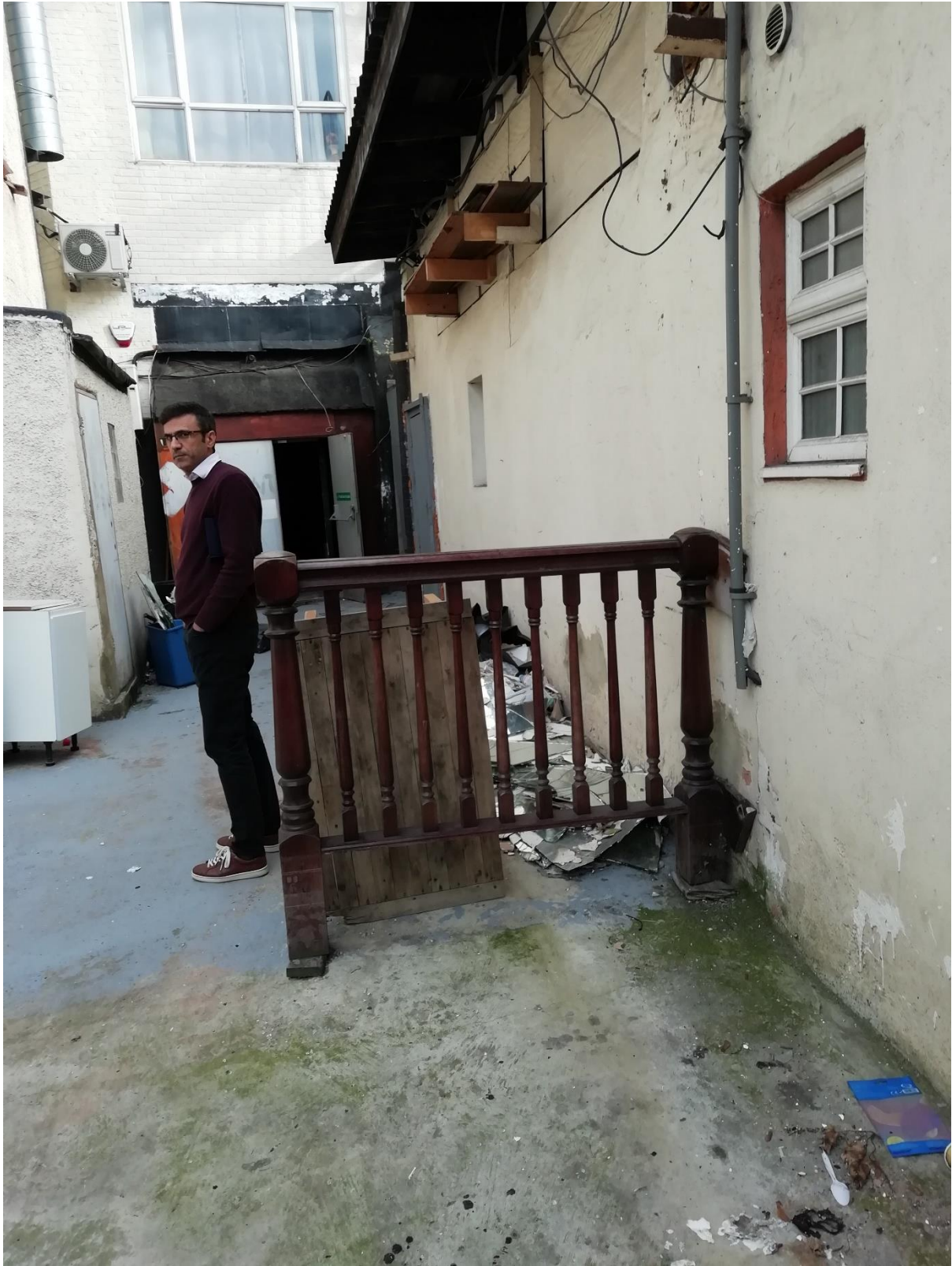

Rear of the premises. Fire door open. Residential windows above and to the sides.

Police additional evidence



Residential properties rear of premises

Police additional evidence



Residential window on ground floor, kitchen area

Police additional evidence



Residential flats two floors above the venue

Police additional evidence



Residential flats one floor above the venue

Police additional evidence

Premises licence review application submitted by Police and heard by the Licensing committee on 13th July 2017. See attached decision notice including vast list of conditions that could not be maintained in order to uphold the licensing conditions.

Final review application submitted by Police on 18th December 2017. This application was heard on 7th February 2018 and the Licensing Committee decided to REVOKE the premises licence.

An appeal was lodged to Brent Magistrates Court on 26th February 2018. This appeal was withdrawn by the premises licence holder before the case could be heard. The licence was revoked.

Police additional evidence