

PROPOSED LICENSING PLAN

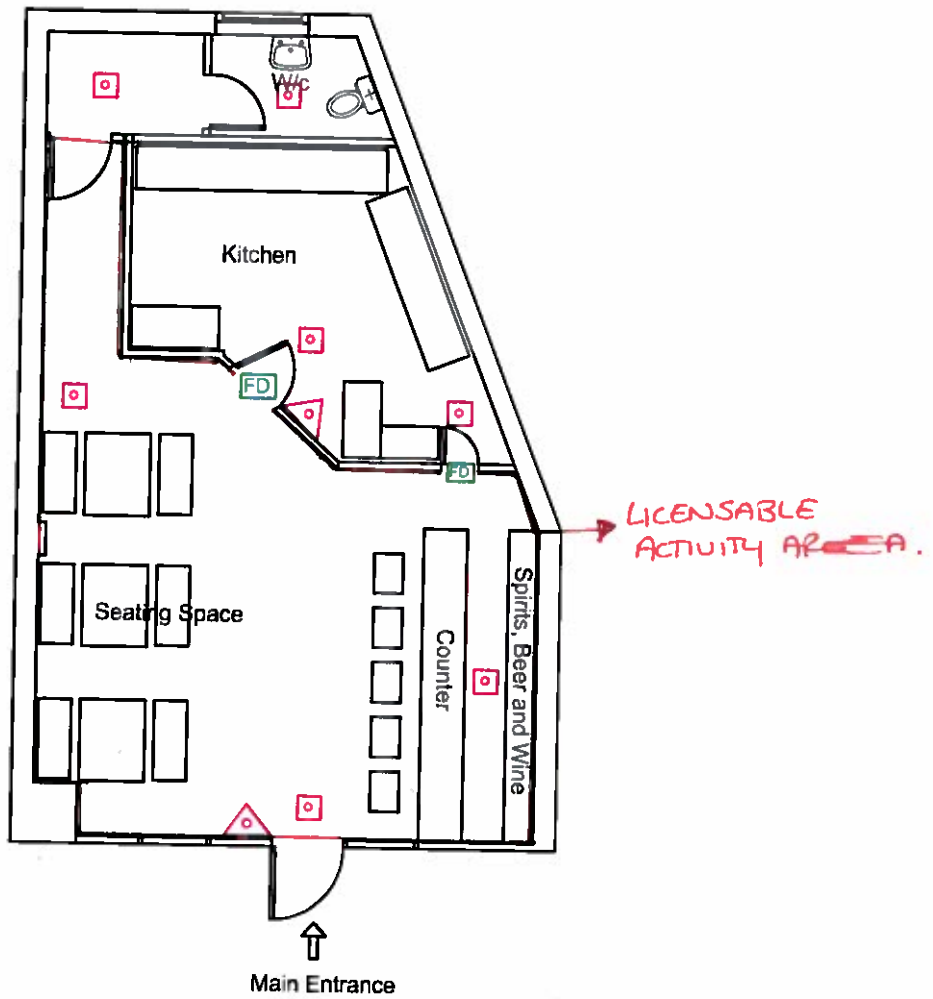

Property Address:
5 Heather Park Drive Parade
Wembley
HA0 1SL

Drawing no: P/HBS/127		Date: 16th April 2018	
Key		Scale: 1:100 Paper: A4	
△		FIRE EXTINGUISHER	
F22		FIRE EXIT SIGNS	
□		EMERGENCY LIGHTING	
FD		FIRE CHECK DOOR	
📷		CCTV CAMERAS	
CCTV RECORDING 31 DAYS			
SHUTTERS PROVIDED			
ALARM SYSTEM TO AQISPEC OR SIMILAR FITTED			