

Appendix A

Proposed controlled parking zone – Dorchester Way Area

Our ref: TP 831 - BS

July/ August 2009



Dear Resident / Business,

Brent Council is considering introducing a controlled parking zone (CPZ) in the Dorchester Way area to improve road safety, improve access for pedestrians and cyclists, and provide easier access to parking in the area. This is in response to concerns received from local residents and businesses in recent years.

As a resident/business of the area from which complaints have been received you are asked to indicate on the attached questionnaire, whether you now wish to be included within the proposed DW CPZ. Please therefore complete the questionnaire and return it in the **FREEPOST** envelope enclosed by **Wednesday 5th August 2009**.

The result of the consultation along with officers' recommendations will be reported to the September 2009 Highways Committee meeting for a decision. Once a decision is made an information letter will be delivered to the area informing you of the details of that decision.

A draft design of the parking arrangements for the proposed area has been prepared and will be on display at the **Kingsbury Library, Kingsbury Road, Kingsbury London NW9 9HE** from Wednesday 1st July 2009 until Wednesday 5th August 2009. Council officers will be in attendance in the Library on the following days to discuss the proposals and answer any questions you may have:

DATE	Library	TIME
Monday 13 th July 2009	Kingsbury	5pm – 8pm
Thursday 16 th July 2009	Kingsbury	5pm – 8pm

Please be assured that a CPZ will only be implemented if there is majority support otherwise the Council will not proceed. ***If majority support is identified the CPZ will be progressed for implementation.***

A brief guide of how CPZ's operate is provided below:

- All the kerbside space will be controlled. Yellow lines will be introduced to control road junctions (double yellows) and vehicular accesses (single yellows). This will prevent obstructive parking on junctions and across driveways. It will also improve accessibility for pedestrians, the disabled, emergency services and refuse collection.
- Parking will be either in permit holder, pay & display or shared use (permit & ticket holder) bays. Residents will need to purchase permits if they, or their visitors, wish to park in the designated bays during the scheme's operational hours. Permit charges are shown overleaf.
- Blue Badge holders may park their vehicle without payment and without time limit in a permit holders bay provided that a valid disabled persons' badge is displayed
- 'Pay & Display' parking will be between 1 to 4 hours maximum stay and the current cost of parking in these bays will be from 40 pence for 20 minutes to £6 for up to 4 hours.
- The CPZ is intended to give the permit holders priority use of the parking spaces during the scheme operational times, but does not necessarily guarantee a parking space. Only the Zone permit holders will be entitled to park in any street within the zone, but not in any other

Appendix A – Contin.

- zone. Similarly, permit holders from other zones will not be entitled to park in your Zone. The zoning helps to manage local demand for parking, especially in the roads close to shopping areas; a larger zone may encourage permit holders to drive and park within the zone in bays near shops or rail stations, thereby inconveniencing residents close to these amenities.

Type of Permit	Controlled Parking Zone Permit Charges		
	1 Year Charge	6 Months Charge	3 Months Charge
1st Resident Permit • Electric Vehicle • Vehicle up to 1200 cc registered before 1 st April 2001 • DVLA bands A & B (CO ₂ emissions up to 120 g/km) for vehicles registered after 31 st March 2001 (Only vehicle registration document / logbook is accepted as the proof of engine size/emissions) All other vehicles	FREE	FREE	FREE
2nd Resident Permit	£ 50	£ 31	£ 18.50
3rd Resident Permit	£ 75	£ 43.50	£ 24.75
Visitor Household Permit	£ 100	£ 56	£ 31
Business Livered Permit	£ 100	£ 56	£ 31
Business Permit	£ 180	£ 100	£ 60
Doctor's Exempt Permit	£ 300	£ 160	£ 90
Temporary Permit	£ 150 per year		
Replacement Permit (Lost, stolen or defaced permit)	£ 5 per month		
Change of Vehicle	£ 5 per re-print.		
	First two changes are free of charge. There after, £ 5 per change.		

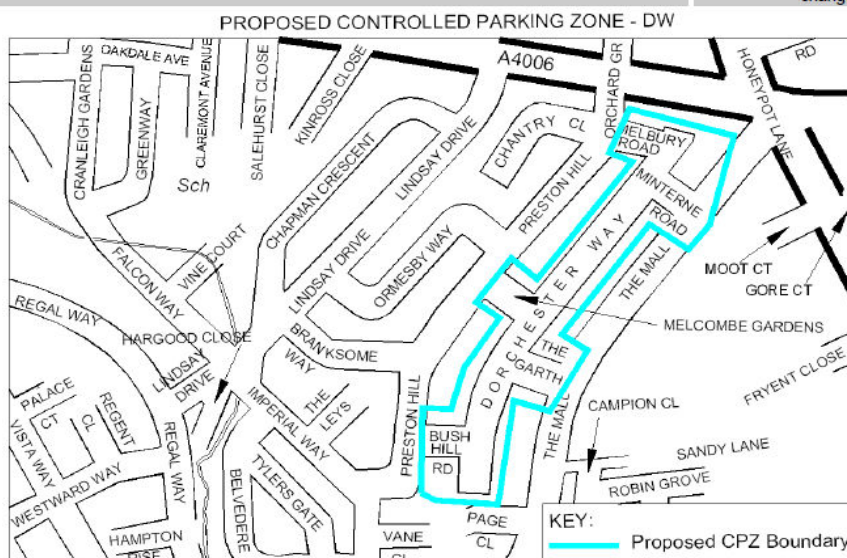

If you require any further information or wish to discuss any specific issue please contact us on 0208 937 5132/ 5199.

If you require this document in larger print please telephone
0208 937 5132 / 5185

Brent
Building a better borough



Appendix A – Contin.

Our ref: TP 831-BS

July / August 2009

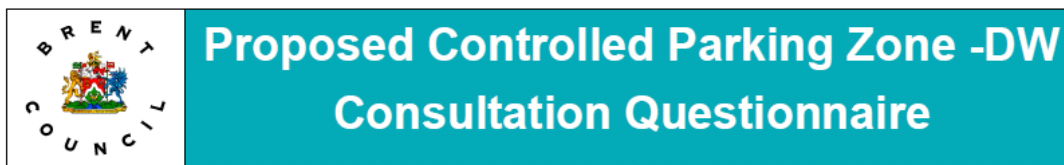

Dear Resident / Business,

Proposed Controlled Parking Zone DW Consultation

The Council is seeking your views on whether you would like to be included in the proposed controlled parking zone (CPZ) DW. Please take the time to read and respond to the attached consultation questionnaire.

The information you provide will be treated confidentially and will be used solely by the London Borough of Brent. Please complete the questionnaire and return it in the **FREEPOST** envelope enclosed, to reach us by **Wednesday 5th August 2009**. Alternatively, post it to **London Borough of Brent, Transportation Service Unit, Brent House, 349-357 High Road, Wembley, Middlesex, HA9 6BZ**.

PLEASE PRINT CLEARLY.

The consultation results will be available to view on the council's website. Please go to www.brent.gov.uk/consultation to view the results which will be available within one month of the closing date.

**If you require this document in larger print please
Telephone 0208 937 5132 or 5185**

Brent



Proposed Zone E extension

Our ref: TP 511 - SN

June / July 2009



Proposed Extension to the existing Controlled Parking Zone E

Dear Resident,

Brent Council introduced Controlled Parking Zone E in October 1999 after successful consultation with local residents and businesses. The scheme has helped considerably to ease the flow of traffic and have provided readily available short-term parking for shoppers. In addition, the long-term non - residential parking have been removed from residential roads within the CPZ where permit parking has been implemented.

However, a number of complaints have been received from residents outside the CPZ about long-term parking displacing into their roads. These residents have requested that they want to be included in a CPZ. The Highways Committee has therefore agreed to consult you on CPZ proposals for your streets, which would be an extension of the existing zone E as shown on the map overleaf.

As a resident/business of the area from which complaints have recently been received you are requested to indicate on the attached questionnaire, whether you now wish to be included in **zone E which operates between 8.00am to 9.00pm, Monday to Sunday**. Please therefore complete and return the questionnaire by **Friday 24th July 2009**, using the freepost facility.

A draft scheme has been designed for the area which will be on display at the Ealing Road Library, and will be available for inspection from 23rd June 2009 to 24th July 2009. Council Officers will be in attendance to answer any questions you may have on the following dates and times:

Wednesday 24th June 2009 from Noon to 3pm
Saturday 27th June 2009 from 2pm to 5pm
Thursday 2nd July 2009 from 6pm to 8pm

A brief reminder of how CPZ's operate generally is provided below:

- All the kerbside space will be controlled. Yellow lines will be introduced to control road junctions (double yellows) and vehicular accesses (single yellows). This will prevent obstructive parking on junctions and across driveways. It will also improve accessibility for pedestrians, the disabled, emergency services and refuse collection.
- Parking will be either in permit holder, pay & display or shared use (permit & ticket holder) bays. Residents will need to purchase permits if they, or their visitors, wish to park in the designated bays during the scheme's operational hours. Permit charges are shown overleaf.
- Blue Badge holders may park their vehicle without payment and without time limit in a permit holders bay provided that a valid disabled persons' badge is displayed.
- 'Pay & Display' parking will be between 1 to 4 hours maximum stay and the current cost of parking in these bays will be from 40 pence for 20 minutes to £6 for up to 4 hours.
- The CPZ is intended to give the permit holders priority use of the parking spaces during the scheme operational times, but does not necessarily guarantee a parking space. Experience with CPZ's introduced elsewhere in the Kilburn and Willesden area has shown that residents are generally able to park close to their homes, even where there is a high density of residents.
- Only the Zone permit holders will be entitled to park in any street within the zone, but not in any other zone. Similarly, permit holders from other zones will not be entitled to park in your Zone. The zoning helps to manage local demand for parking, especially in the roads close to shopping areas; a larger zone may encourage permit holders to drive and park within the zone in bays near shops or rail stations, thereby inconveniencing residents close to these amenities.

If you require any further information on the existing CPZs or wish to discuss any specific issue please contact us on 0208 937 5124 / 5132.

Appendix B Contin.

Controlled parking zone permit charge

Type of Permit	1 Year	6 Months	3 Months
	Charge	Charge	Charge
1st Resident Permit			
<ul style="list-style-type: none"> • Electric Vehicle • Vehicle up to 1200 cc registered before 1st April 2001 • DVLA bands A & B (CO₂ emissions up to 120 g/km) for vehicles registered after 31st March 2001 (Only vehicle registration document / logbook is accepted as the proof of engine size/emissions)	FREE	FREE	FREE
All other vehicles	£ 50	£ 31	£ 18.50
2nd Resident Permit	£ 75	£ 43.50	£ 24.75
3rd Resident Permit	£ 100	£ 56	£ 31
Visitor Household Permit	£ 100	£ 56	£ 31
Business Livered Permit	£ 180	£100	£ 60
Business Permit	£ 300	£ 160	£ 90
Doctor's Exempt Permit	£ 150 per year		
Temporary Permit	£ 5 per month		
Replacement Permit (Lost, stolen or defaced permit)	£ 5 per re-print.		
Change of Vehicle	First two changes are free of charge. There after, £ 5 per change.		

Proposed extension to the existing E CPZ

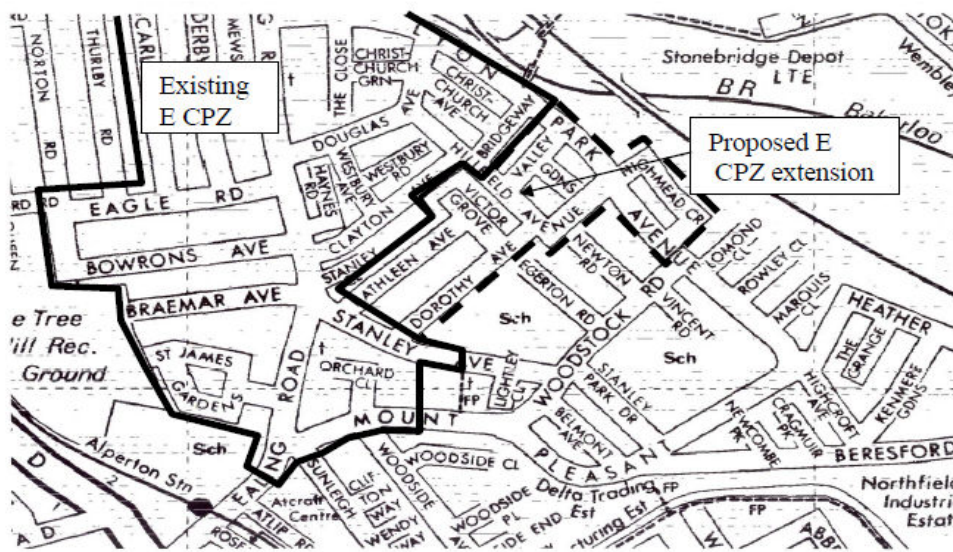

**IF YOU REQUIRE THIS DOCUMENT IN LARGER PRINT PLEASE TELEPHONE
0208 937 5132/5185**



Brent – Building a better borough

Appendix B Contin.

June / July 2009



Consultation Questionnaire

Please complete and return

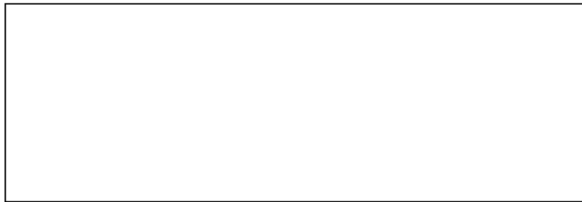

Dear Resident,

Proposed extension to the existing Controlled Parking Zone E

The Council would be pleased to hear your views on the proposed scheme. Please take the time to read and respond to the attached consultation information.

The information you provide will be treated confidentially and will be used solely by the London Borough of Brent. Please complete this questionnaire and return it in the **FREEPOST** envelope enclosed, to reach us by **Friday 24th July 2009**. Alternatively, post it to **London Borough of Brent, Transportation Service Unit, Brent House, 349-357 High Road, Wembley, Middlesex, HA9 6BZ**.

PLEASE PRINT CLEARLY.

Only one reply per household will be accepted and or one member of staff for each company / business is required to reply. Please note photocopies will not be accepted.

Yours sincerely

Phil Rankmore
Director of Transportation (Acting)

**IF YOU REQUIRE THIS DOCUMENT IN LARGER PRINT
PLEASE TELEPHONE 020 8937 5132 / 5185**

Appendix B Contin.

Proposed Zone SH extension

June / July 2009

Our ref: TP829 - AT



Public Consultation

Proposed extension to the existing Controlled Parking Zone SH

Brent Council introduced controlled parking zone SH in two phases after successful consultation with local residents and businesses. The original scheme which included Rosebank Avenue and Fernbank Avenue was introduced in December 2003. It was extended to include Maybank Avenue in November 2005 thereafter.

However, a number of complaints have been received from residents outside the CPZ about long-term parking displacing into their roads. These residents have requested that they want to be included in a CPZ. The Highways Committee has therefore agreed to consult you on CPZ proposals for your streets, which would be an extension of the existing zone SH as shown on the map overleaf.

As a resident/business of the area from which complaints have recently been received you are requested to indicate on the attached questionnaire, whether you now wish to be included in **zone SH which operates between 8.00am to 6.30pm, Monday to Saturday**. Please therefore complete and return the questionnaire by **Friday 24th July 2009**, using the freepost facility.

A draft scheme has been designed for the area which will be on display at Barham Park Library and will be available for inspection **from 9th of July to 24th of July 2009**. Council officers will be in attendance to answer any questions you may have on the following dates:

Thursday 9th July 2009 from 5.30pm – 7.30pm
Saturday 11th July 2009 from 1.00pm – 4.00pm

A brief reminder of how CPZ's operate generally is provided below:

- All the kerbside space will be controlled. Yellow lines will be introduced to control road junctions (double yellows) and vehicular accesses (single yellows). This will prevent obstructive parking on junctions and across driveways. It will also improve accessibility for pedestrians, the disabled, emergency services and refuse collection.
- Parking will be either in permit holder, pay & display or shared use (permit & ticket holder) bays. Residents will need to purchase permits if they, or their visitors, wish to park in the designated bays during the scheme's operational hours. Permit charges are shown overleaf.
- Blue Badge holders may park their vehicle without payment and without time limit in a permit holders bay provided that a valid disabled persons' badge is displayed.
- 'Pay & Display' parking will be between 1 to 4 hours maximum stay and the current cost of parking in these bays will be from 40 pence for 20 minutes to £6 for up to 4 hours.
- The CPZ is intended to give the permit holders priority use of the parking spaces during the scheme operational times, but does not necessarily guarantee a parking space. Experience with CPZ's introduced elsewhere in the Kilburn and Willesden area has shown that residents are generally able to park close to their homes, even where there is a high density of residents.
- Only the Zone permit holders will be entitled to park in any street within the zone, but not in any other zone. Similarly, permit holders from other zones will not be entitled to park in your Zone. The zoning helps to manage local demand for parking, especially in the roads close to shopping areas; a larger zone may encourage permit holders to drive and park within the zone in bays near shops or rail stations, thereby inconveniencing residents close to these amenities.

If you require any further information on the existing CPZs or wish to discuss any specific issue please contact on 0208 937 5372 / 5132.

Appendix C Contin.

Current controlled parking zone permit charge

Type of Permit	1 Year	6 Months	3 Months
	Charge	Charge	Charge
1st Resident Permit • Electric Vehicle • Vehicle up to 1200 cc registered before 1 st April 2001 • DVLA bands A & B (CO ₂ emissions up to 120 g/km) for vehicles registered after 31 st March 2001 (Only vehicle registration document / logbook is accepted as the proof of engine size/emissions)	FREE	FREE	FREE
All other vehicles	£ 50	£ 31	£ 18.50
2nd Resident Permit	£ 75	£ 43.50	£ 24.75
3rd Resident Permit	£ 100	£ 56	£ 31
Visitor Household Permit	£ 100	£ 56	£ 31
Business Livered Permit	£ 180	£100	£ 60
Business Permit	£ 300	£ 160	£ 90
Doctor's Exempt Permit	£ 150 per year		
Temporary Permit	£ 5 per month		
Replacement Permit (Lost, stolen or defaced permit)	£ 5 per re-print.		
Change of Vehicle	First two changes are free of charge. There after, £ 5 per change.		

Consultation Area

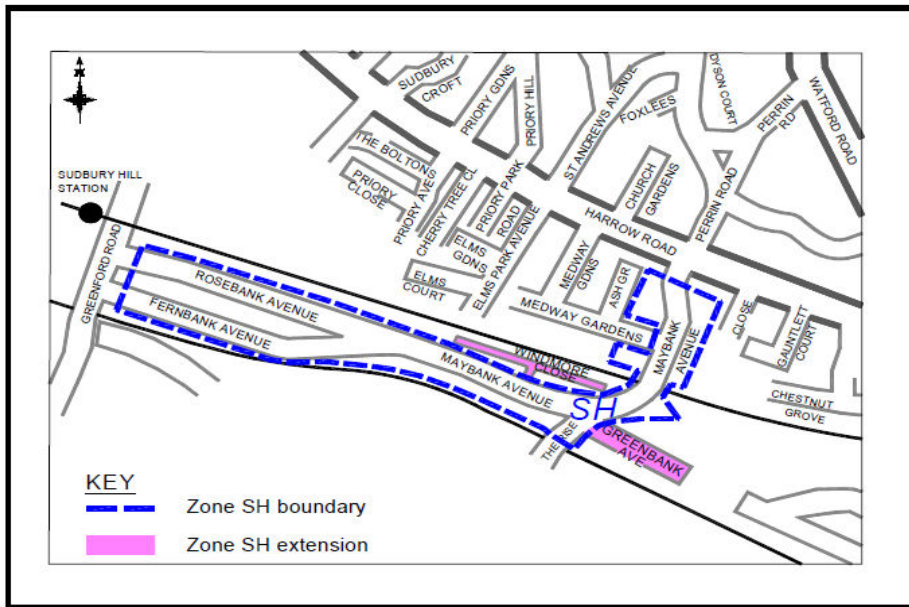

**If you require this document in larger print please telephone
0208 937 5132**



Appendix C Contin.

Our ref: TP 829 **Zone SH extension**

June – July 2009



Consultation Questionnaire

Please complete and return

A large, empty rectangular box with a thin black border, intended for the respondent to provide their answers to the questionnaire.

Dear Sir or Madam,

Proposed Extension to the existing Controlled Parking Zone SH

The Council would be pleased to hear your views on the proposed scheme. Please take the time to read and respond to the attached consultation information. You will find the details of the proposed scheme in the attached Public Consultation document.

The information you provide will be treated confidentially and will be used solely by the London Borough of Brent. Please complete this questionnaire and return it in the **FREEPOST** envelope enclosed, to reach us by **24 July 2009**. Alternatively, post it to **London Borough of Brent, Transportation Service Unit, Brent House, 349-357 High Road, Wembley, Middlesex, HA9 6BZ**.

Consultation results are available to view on the council's website. Please go to www.brent.gov.uk/consultation to view the results. Results are generally available within one month of the closing date.

Only one reply per household or business will be accepted.

**If you require this document in larger print please
telephone 0208 937 5132 or 5185**

Appendix C Contin.

QUESTION 1

Do you have parking problem?

Yes

No

No Opinion

QUESTION 2

Do you wish to join with the existing Controlled Parking SH Zone?

Yes

No

No Opinion

COMMENTS

Thank you for taking the time to complete this questionnaire