

APPENDIX 5 OPTIONS FOR THE WEST COAST MAIN LINE LINK

Option 1 Low Cost

(under West London Line and on to Dudding Hill freight line) – using existing turnback as proposed by HS2 and flyover/under to join Chiltern alignment

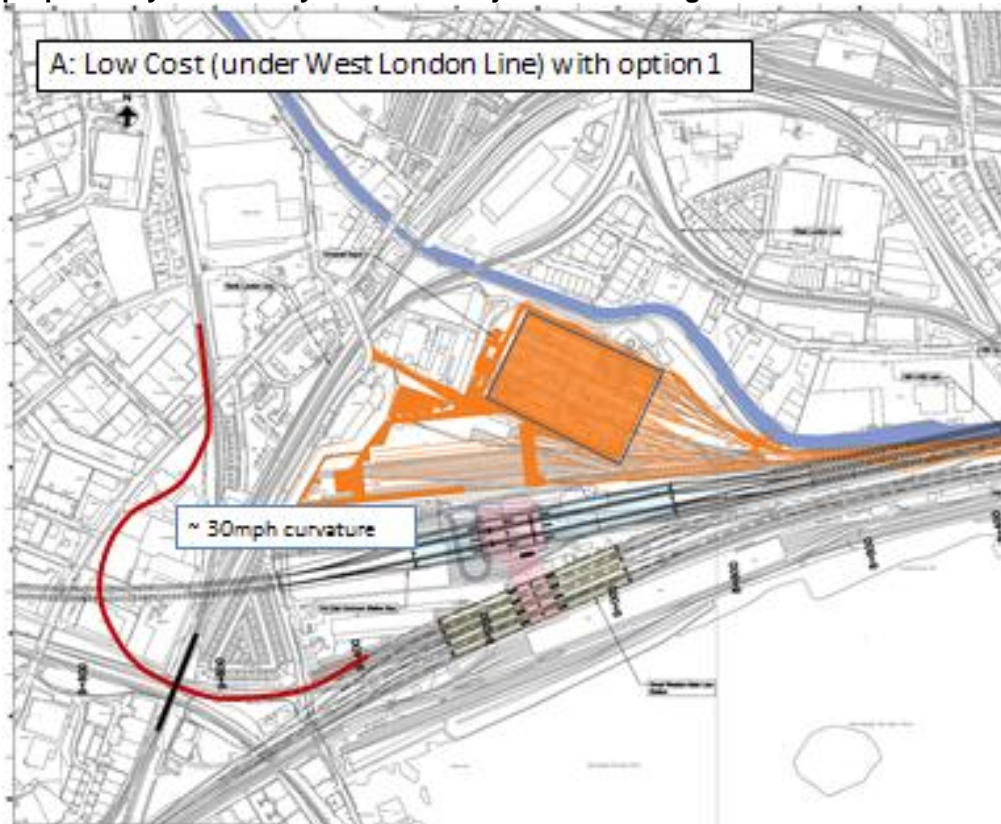

Option 2 – High Cost via Bored Tunnel

B: High Cost (via Bored Tunnel) either option 1 or 2

