

Proposed Ground Floor Plan Kilburn High Road

Staff Safe System Installed
Full External CCTV System Installed

BETTING AREA SHOWN HATCHED

SHOPFRONT NOTES
 NEW BLUE INTERNALLY ILLUMINATED FASCIA SIGNS
 NEW BLUE INTERNALLY ILLUMINATED PROJECTING BOX SIGN
 PILASTERS TO BE POWDER COATED RAL 5013
 NEW BLUE POWDERCOATED ALUMINIUM SHOPFRONT POWDER COATED RAL 5013 AND SILVER ANODISED ENTRANCE DOOR
 CORPORATE WINDOW DISPLAY BOARDS
 10.8mm LAMINATED SAFETY GLASS TO SHOPFRONT AND 6.8mm LAMINATED SAFETY GLASS TO ENTRANCE DOOR
 STALL RISER TO BE POWDER COATED RAL 5013



Proposed Shopfront Elevation Kilburn High Road



Proposed Shopfront Elevation Glengall Road

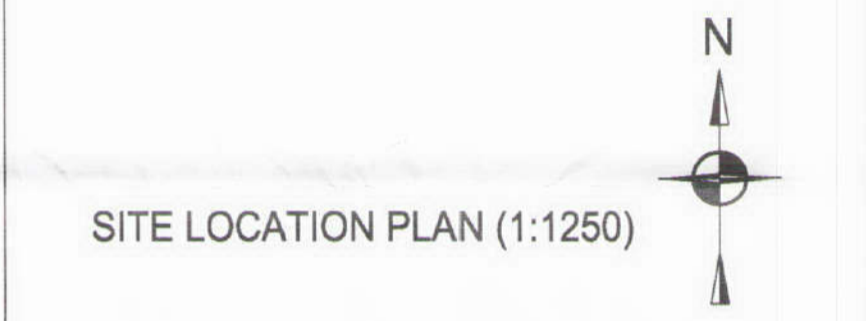
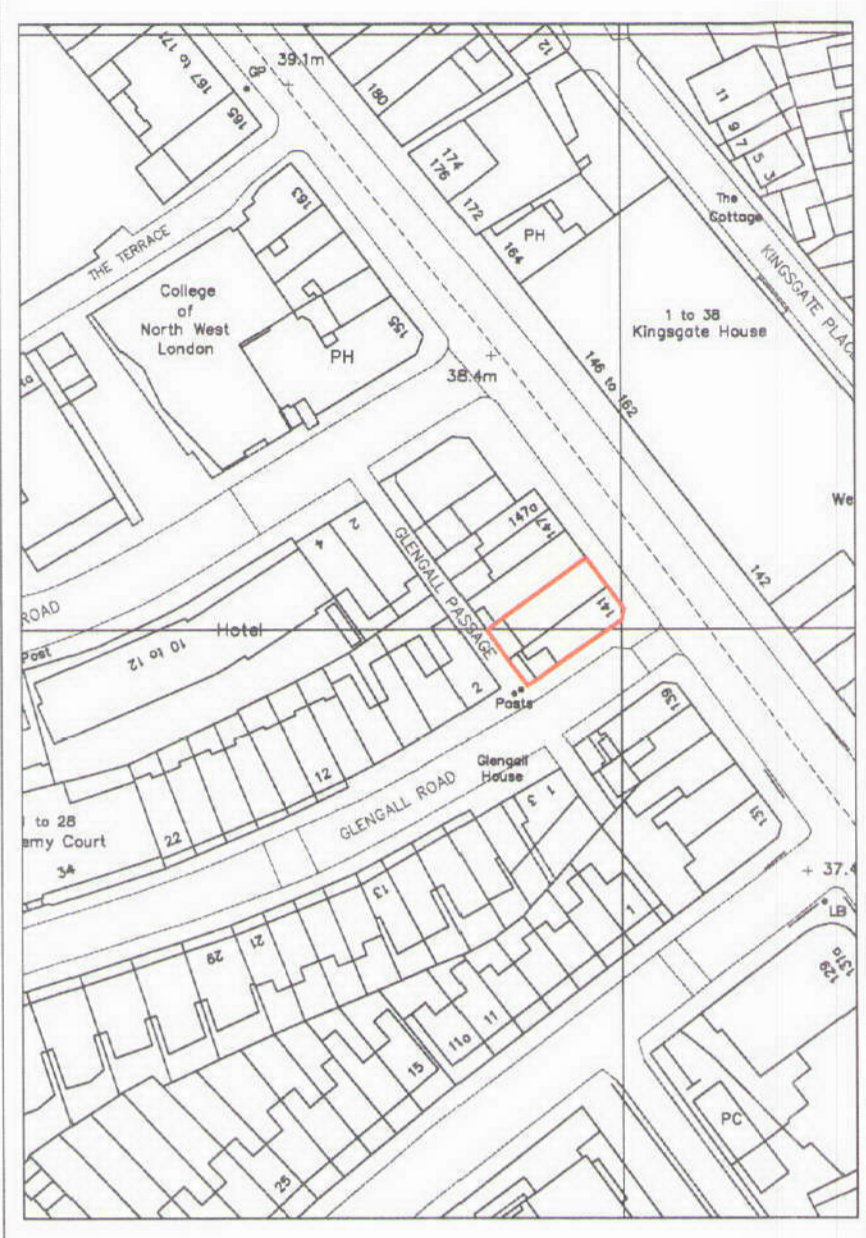
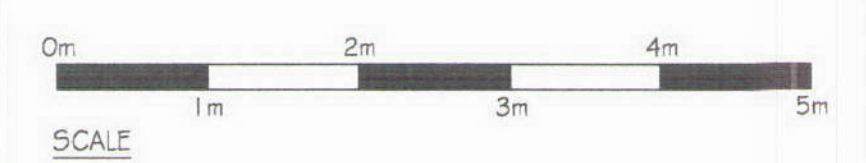

SITE LOCATION PLAN (1:1250)

DESCRIPTION	DATE	TECH

PROPOSED	
GROSS UNIT AREA	2190 sqft
GROSS CUSTOMER AREA	sqft
NET CUSTOMER AREA	sqft
NEWSPAPER DISPLAY AREA	L.ft
DO NOT SCALE OFF THIS DRAWING	

William HILL
ORGANIZATION PLC.

Site: 141/143 KILBURN HIGH ROAD
KILBURN LONDON
NW6 7HT GLENGALL

Description:
PROPOSED PLAN AND ELEVATIONS

Date: 21/09/2012 Scale: 1:50@A1 1:100@A3
 Drawn: CRISTINA DI NOIA PM: MICHAEL MURPHY
 Drawing Number:
PROV/W/RF/112801/601