

**KEY**

- 1 EXHIBIT WALL**  
Built-in exhibition wall to showcase heritage and library events, also a feature point of the Ground Floor Library to guide the community to the main part of the Library on the Mezzanine
- 2 STAIRS**  
New self supporting stairs leading up to the Mezzanine
- 3 INTEGRATED SEATING**  
Seating and planting will provide the stairs with activity and energy, creating a focal point to guide the community to the Mezzanine
- 4 FLEXIBLE SEATING**  
Seating arrangements for collaboration space. Loose furniture and be reconfigured to suit the needs of the space

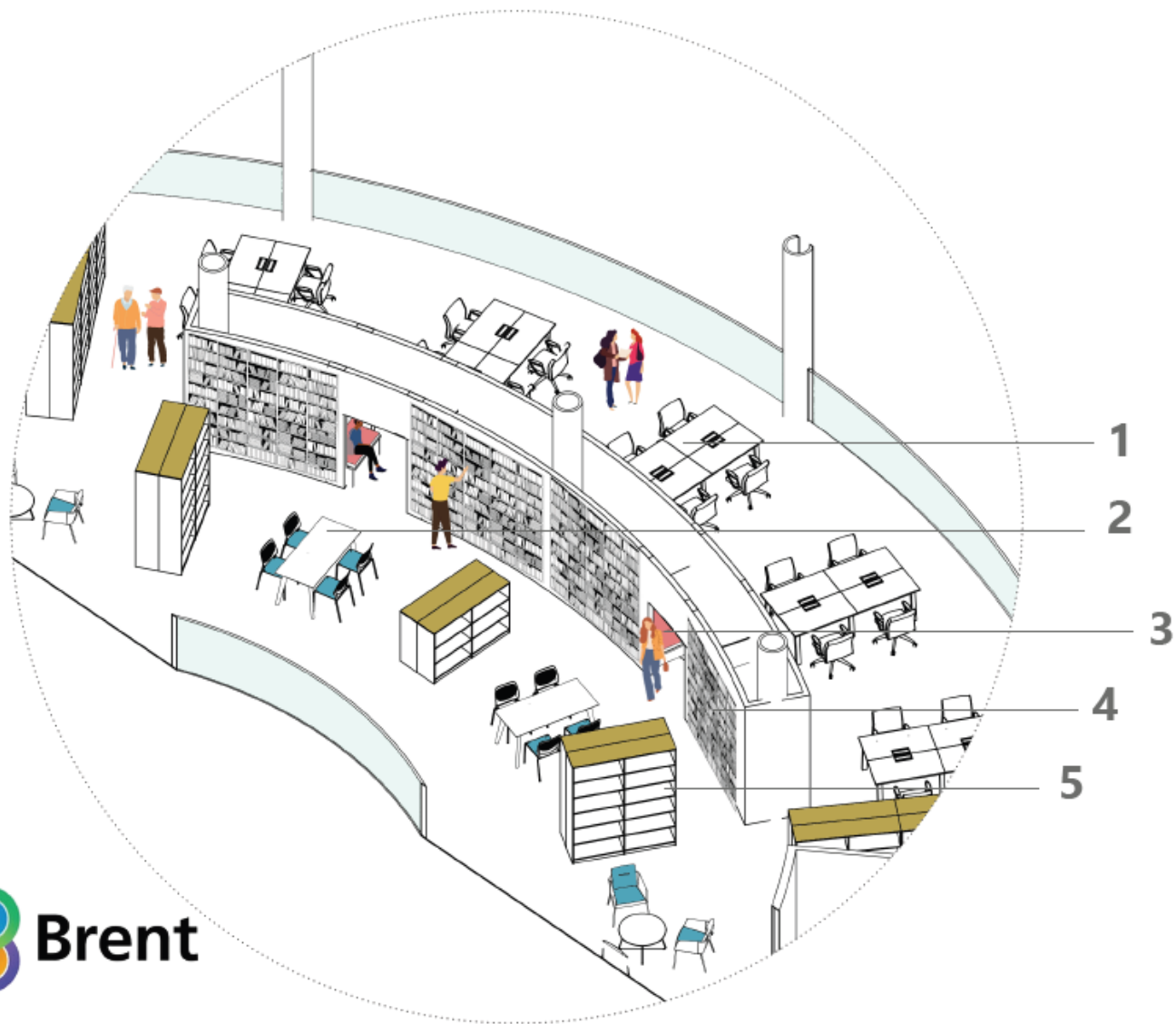



**KEY**

- 1 COMPUTER RESOURCES**  
Computer desks surround the curve of the mezzanine
- 2 COLLABORATION SEATING**  
Gives the opportunity to reconfigure the space, Areas for studying and collaboration
- 3 PASS-THROUGH BENCH SEATING**  
Pass-throughs have bench seating, lending to cozy areas to read
- 4 BOOK WALL**  
Built-in book wall to provide ample storage for the Library's over 40,000 books. Pass-throughs lead to the computer resource area.
- 5 BOOKCASES**  
High-level bookcases provide areas of separation within collaboration areas





# Optimisation Stairs



## STRATEGIES

### 01 Existing Stairs

The existing stairs have proven to be an accessibility problem. They can be difficult to navigate and in general, most people choose to avoid taking them and take the lift instead. To improve wellness, we propose the installation of a staircase that is engaging for the users.

### 02 Seating integrated around the staircase

Creating a focal point around the staircase will attract users to choose the stairs over the lift. Adding in seating and integrating plants will provide the staircase with energy and activity and a sense of wellness. This creates a natural transition space within the Library's multi-functional strategy.

### 03 Draw users up the stairs

To increase the attraction to the Library spaces, we propose to attract users up the stairs by adding in feature walls, using digital technology or showcasing event signage or popular books. Integrated lighting can be used to highlight media on the feature wall.

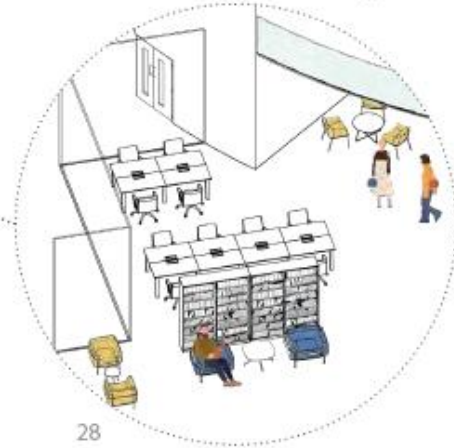
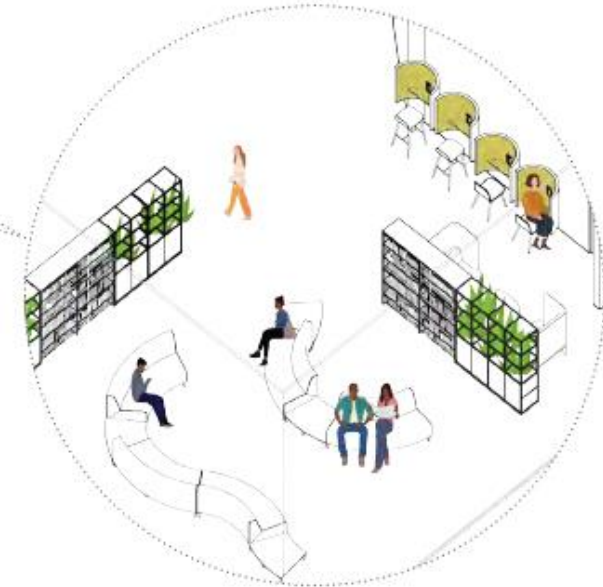
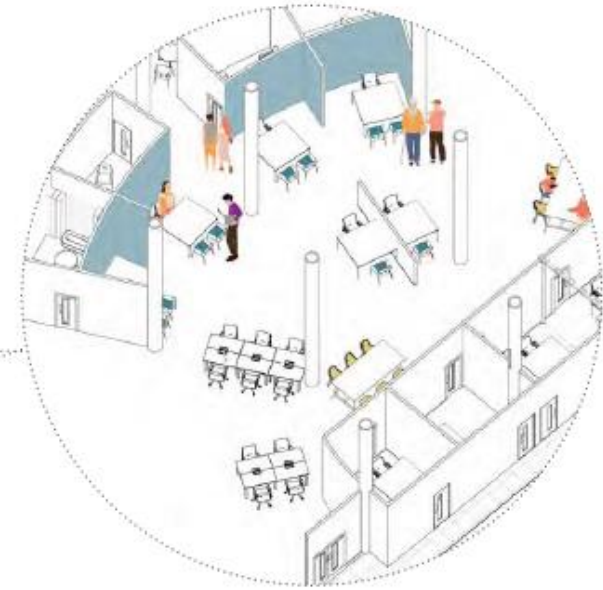
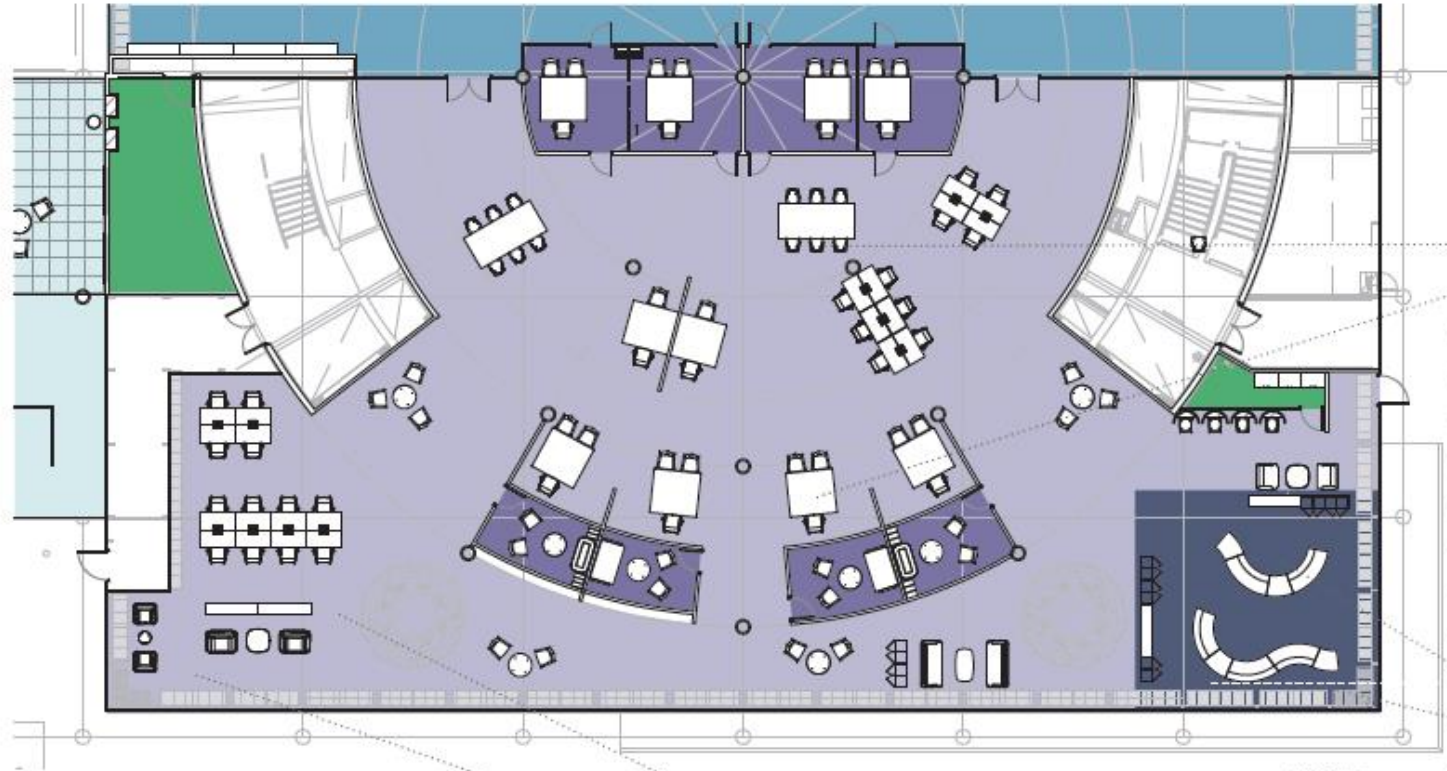



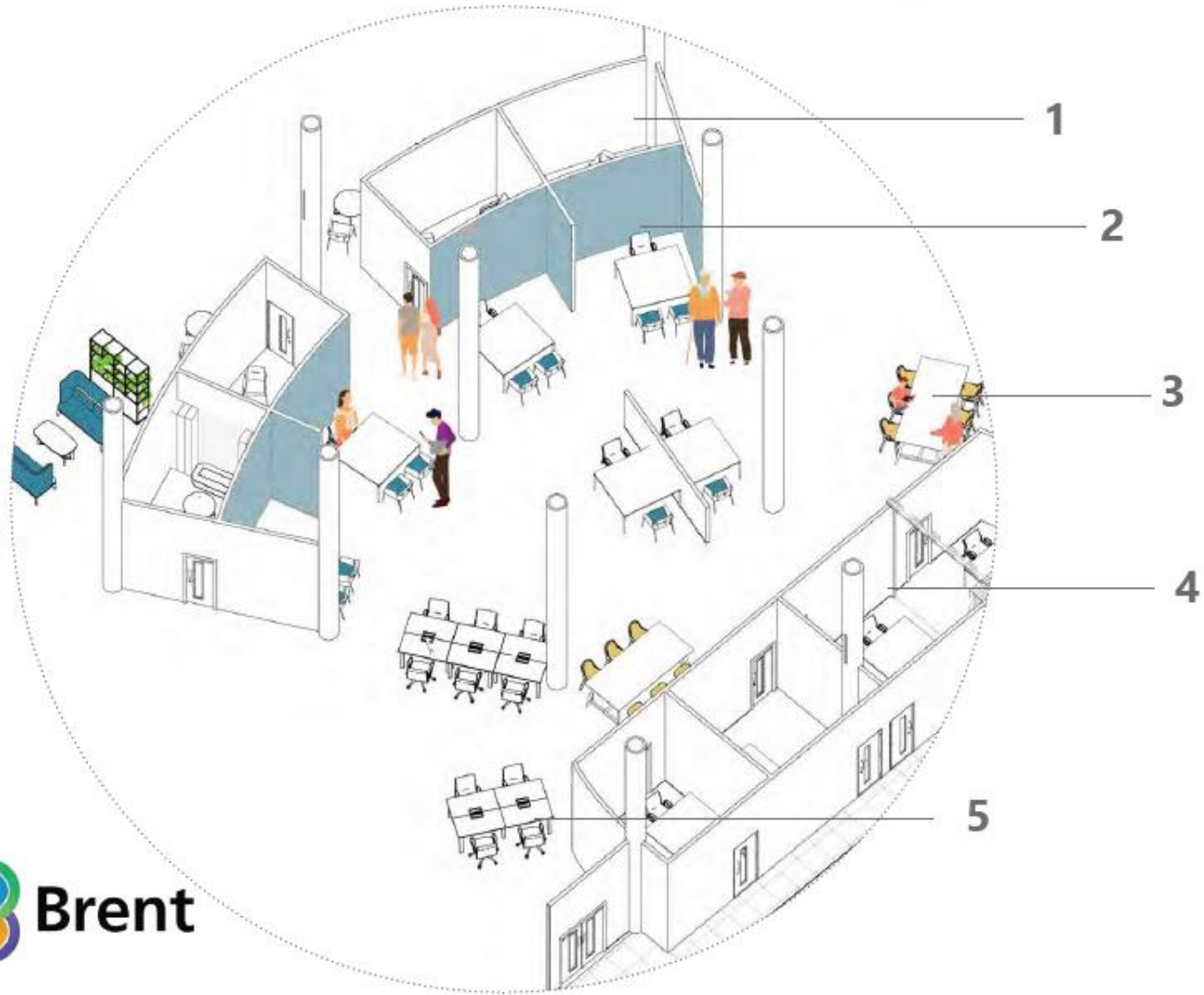

**KEY**

- 1 PRIVATE MEETING ROOMS**  
Comfortable and secure rooms, suitable for meetings and families awaiting resources
- 2 WORK STATIONS**  
Formal seating arrangements for staff to assist members of the community, set up to provide appropriate accommodations for staff, giving 1 meter safe distance
- 3 COLLABORATION AREAS**  
High Tables for appointments or for individuals to work
- 4 MEETING ROOMS**  
Meeting rooms with double entry / escape. Meeting rooms to be bookable. One meeting room with movable partition to create one large meeting room
- 5 COMPUTER DESKS**  
6 Computer Desks in close proximity to staff for customers who need additional support



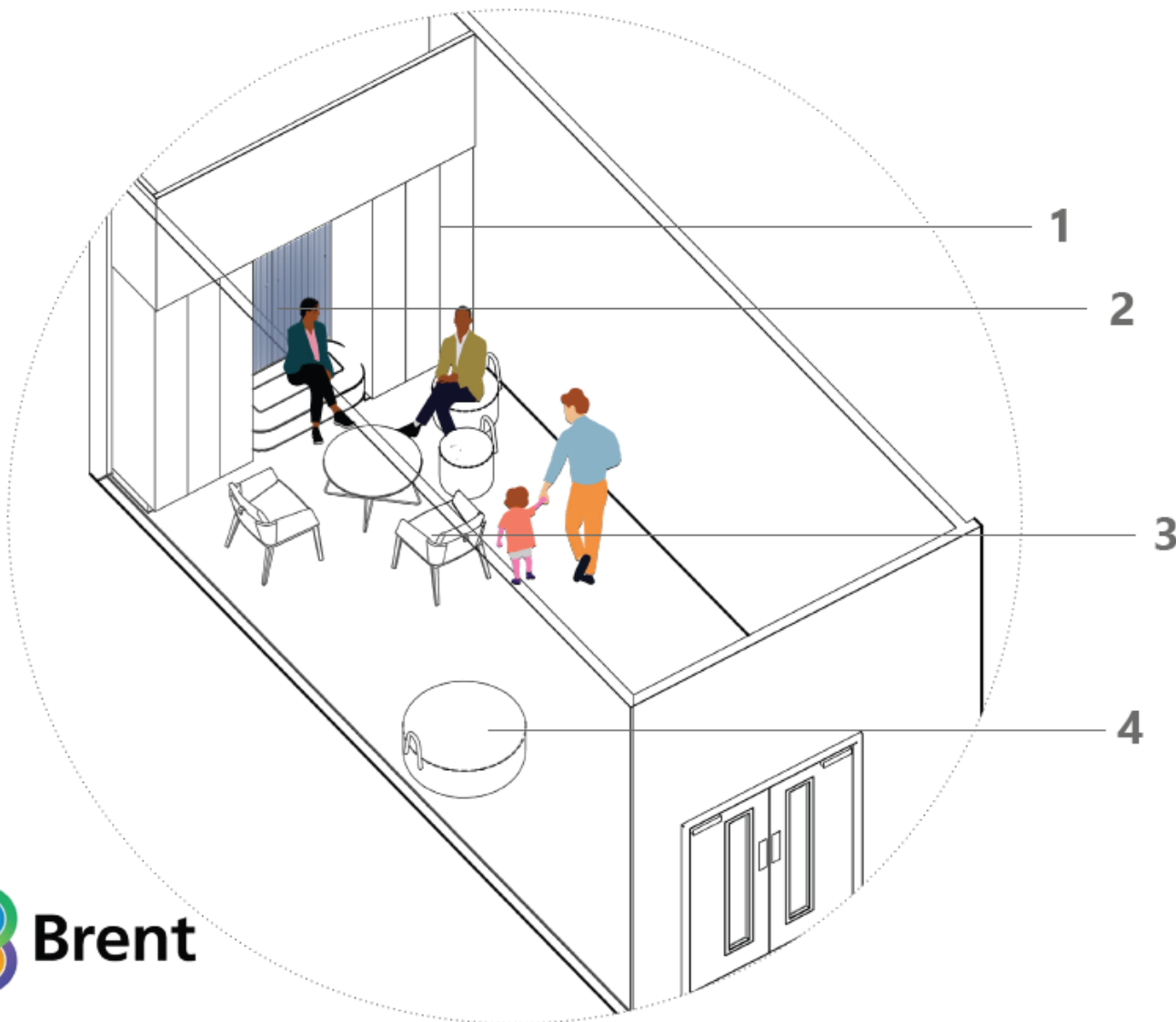

**KEY**

- 1 BUILT-IN STORAGE CABINETS**  
To store supplies + materials for meetings
- 2 ACOUSTIC PANEL**  
Wall panels in addition to absorbant ceiling finishes will ensure better room acoustic conditions and aide communication inside
- 3 SOFT SEATING**  
Allows for approachable configurations to support a safe and comforting space for difficult meetings
- 4 FLEXIBLE SEATING**  
Gives the opportunity to reconfigure the space depending on the needs of the meeting  
Poufs are easily moved and varying sizes to give comfort to young people





## Brent Civic Centre | Preliminary Images

The following images are extracted from the initial desktop model used for space analysis.

We are not showing colours or textures at this stage, as the current purpose of this model is to synthesise the spatial, volumetric response to the Customer brief.

Further development and integration of buildability, colours and textures will happen on the next RIBA stages.



Customer Service Area Concept View



Customer Service Area Concept View

