

**LEGEND**

- S = Smoke Detector
- FA = Fire Alarm
- FB = Fire Blanket
- CO2 = Fire Extinguisher

**IMPORTANT:-** Licensable activities can take place anywhere within the red line. The position of loose furniture and equipment is shown for diagrammatic purposes only. Firefighting equipment is indicated but may be moved subject to the fire risk assessment carried out under the Regulatory Reform (Fire Safety) Order 2005 or by agreement with the fire officer.

Bay Type	Quantity
Unizinc Racking (1200 x 600)	120 (120)
Unizinc Racking For Dispatch/Storage	3
Low G7 Chiller (1320x640)	15 (14)
True GDM Freezer (1197x759)	8 (7)
Chest Freezer	1
Walk In Chiller (32ft x 8ft)	260ft <sup>2</sup>
Walk In Freezer (20ft x 8ft)	160ft <sup>2</sup>

Area	m <sup>2</sup>	ft <sup>2</sup>
Gross Internal Area (GIA)	506	5447
Product Collection Area	363	3907

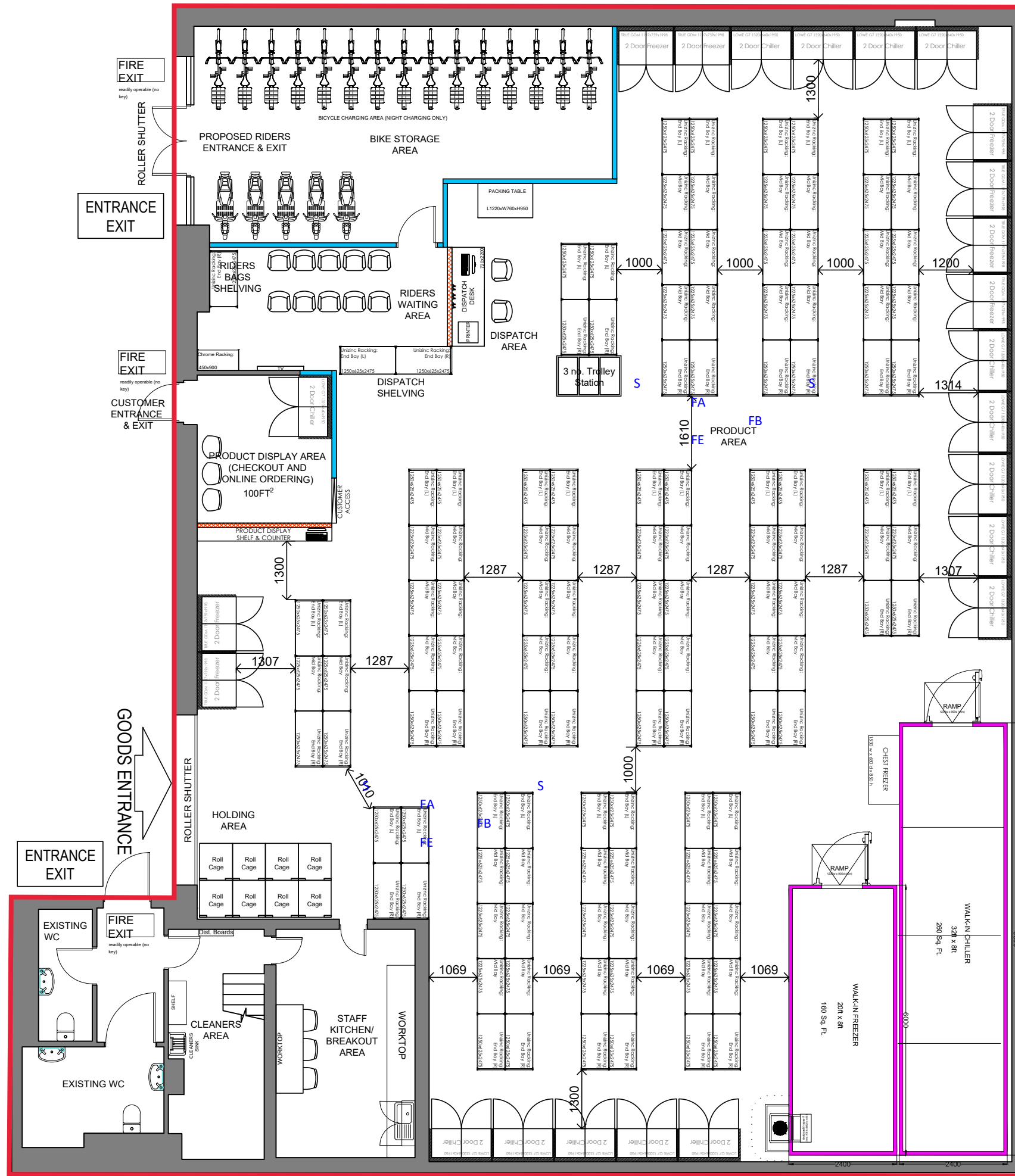
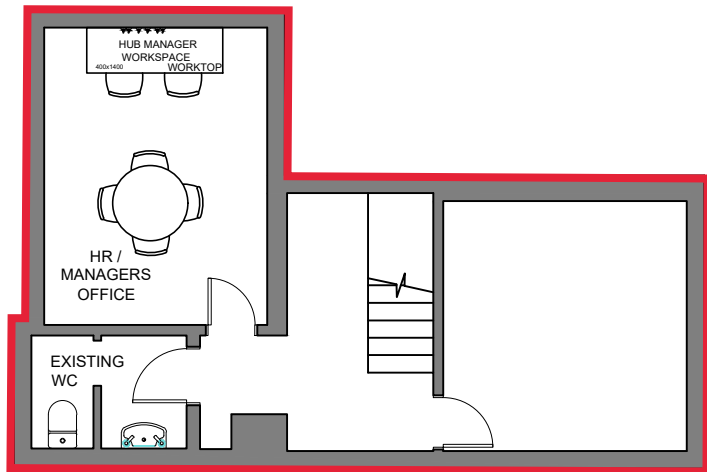

Revision	Date	By	Chk.
--	08.12.21	WN	PT
A	23.12.21	WN	PT

**KEY BUILDING REGS & FIRE SAFETY NOTES:**

- All travel distances have been calculated and comply with Table 2 on page 34 of the Approved Document B, Vol 2.
- All alterations to the building fire detection system to be designed and installed to BS 5839 pt1.
- All alterations to the buildings emergency lighting system to comply with BS 5266 pt1.
- Walls and ceilings in circulation spaces to have class 0 surface spread of flames, with class 1 in other spaces.
- All new ductwork to be installed as part of requirements stated under part F and to have dampers where penetrating fire rated construction.
- Once works are complete the owners and users of the building acknowledge their continuing requirement to carry out continual assessment under the RRO.

**CDM / H&S - HAZARD WARNING SCHEDULE**

LOCATION	HAZARD	SEVERITY	COMMENTS / ACTION	RISK RATED
Line Services	HIGH	LOW	Contractor to ensure adequate support of existing services during the works	LOW
Working at height	HIGH	LOW	Contract selection of MEWP to be utilized at all times including weekly inspections	LOW
Means of Escape	HIGH	LOW	Area in front of means of escape to be kept clear for complete access in case of emergency	LOW
Slips trips and falls	HIGH	LOW	New steel floors and concrete surfaces to be slip resistant. Existing floors being removed, etc. hazardous to be removed	LOW
Risk associated with electricity	HIGH	LOW	Contractor to ensure adequate support of existing services during the works	LOW

Status: **SCOPING**

Client: **gopuff**

Architect: **CUBE**

Project Title: **62-66 PARK PARADE HARLESDEN, LONDON NW10 4JB**

Drawing Title: **PROPOSED GROUND AND FIRST FLOOR LAYOUT PLAN**

Project Number: <b>A00212</b>	Drawing Number: <b>110</b>	Revision: <b>A</b>
Drawn: <b>WN</b>	Checked: <b>PT</b>	Scale: <b>AS SHOWN@A3</b>
Date: <b>08.12.2021</b>		

The content of this drawing is the property of RPM Consult and may not be copied in whole or part without formal consent.