



Alcohol and Entertainment Licensing Sub-Committee

Wednesday 31 July 2019 at 10.00 am

Board Room 5 - Brent Civic Centre, Engineers Way,
Wembley HA9 0FJ

Membership:

Members

Councillors:

Ahmed (Chair)
Hector
Long

Substitute Members

Councillors:

Allie, Chohan, Kennelly, McLeish, W Mitchell Murray,
Maurice and RS Patel

For further information contact: Devbai Bhanji, Governance Assistant
Tel: 020 8937 4011; Email: devbai.bhanji@brent.gov.uk

For electronic copies of minutes, reports and agendas, and to be alerted when the minutes of this meeting have been published visit:

www.brent.gov.uk/committees

The press and public are welcome to attend this meeting

Notes for Members - Declarations of Interest:

If a Member is aware they have a Disclosable Pecuniary Interest* in an item of business, they must declare its existence and nature at the start of the meeting or when it becomes apparent and must leave the room without participating in discussion of the item.

If a Member is aware they have a Personal Interest** in an item of business, they must declare its existence and nature at the start of the meeting or when it becomes apparent.

If the Personal Interest is also significant enough to affect your judgement of a public interest and either it affects a financial position or relates to a regulatory matter then after disclosing the interest to the meeting the Member must leave the room without participating in discussion of the item, except that they may first make representations, answer questions or give evidence relating to the matter, provided that the public are allowed to attend the meeting for those purposes.

***Disclosable Pecuniary Interests:**

- (a) **Employment, etc.** - Any employment, office, trade, profession or vocation carried on for profit gain.
- (b) **Sponsorship** - Any payment or other financial benefit in respect of expenses in carrying out duties as a member, or of election; including from a trade union.
- (c) **Contracts** - Any current contract for goods, services or works, between the Councillors or their partner (or a body in which one has a beneficial interest) and the council.
- (d) **Land** - Any beneficial interest in land which is within the council's area.
- (e) **Licences** - Any licence to occupy land in the council's area for a month or longer.
- (f) **Corporate tenancies** - Any tenancy between the council and a body in which the Councillor or their partner have a beneficial interest.
- (g) **Securities** - Any beneficial interest in securities of a body which has a place of business or land in the council's area, if the total nominal value of the securities exceeds £25,000 or one hundredth of the total issued share capital of that body or of any one class of its issued share capital.

****Personal Interests:**

The business relates to or affects:

- (a) Anybody of which you are a member or in a position of general control or management, and:
 - To which you are appointed by the council;
 - which exercises functions of a public nature;
 - which is directed is to charitable purposes;
 - whose principal purposes include the influence of public opinion or policy (including a political party or trade union).
- (b) The interests of a person from whom you have received gifts or hospitality of at least £50 as a member in the municipal year;

or

A decision in relation to that business might reasonably be regarded as affecting the well-being or financial position of:

- You yourself;
- a member of your family or your friend or any person with whom you have a close association or any person or body who is the subject of a registrable personal interest.

Agenda

Introductions, if appropriate.

Item	Page
1 Apologies for absence and clarification of alternate members	
2 Declarations of Interests	
Members are invited to declare at this stage of the meeting, the nature and existence of any relevant disclosable pecuniary or personal interests in the items on this agenda and to specify the item(s) to which they relate.	
3 Application for a New Premises Licence by Star Pubs & Bars Limited for the premises known as The Rising Sun, 25 Harlesden Road, NW10 2BY, pursuant to the provisions of the Licensing Act 2003	1 - 76

Date of the next meeting: Date Not Specified



- Please remember to ***SWITCH OFF*** your mobile phone during the meeting.
- The meeting room is accessible by lift and seats will be provided for members of the public.

This page is intentionally left blank

LICENSING ACT 2003

Application for New Premises Licence

1. The Application

Name of Applicant:	Star Pubs & Bars Limited
Name & Address of Premises:	The Rising Sun, 25 Harlesden Road, NW10 2BY
Applicants Agent:	Flint Bishop LLP

The application is for a new premises licence:

- 1 For regulated entertainment until 00:00hrs Monday to Sunday, the sale & supply of alcohol from 11:00hrs to 00:00hrs Sunday to Thursday and 01:00hrs Friday & Saturday and to remain open from 11:00hrs to 00:30hrs Sunday to Thursday and 01:30hrs Friday & Saturday.

2. Background

None.

3. Promotion of the Licensing Objectives

See page 16/17 of the application.

4. Relevant Representations

Representations have been received from the Licensing Officers and local residents. Representations were received and withdrawn from Public Safety Officers.

5. Interested Parties

None

6. Policy Considerations

Paragraph Nos: 7.2 8.1 – 8.4

8.1 Where responsible authorities and interested parties do not raise any relevant representations regarding the application made to the council, the council will grant the licence or certificate subject only to the conditions that are consistent with the operating schedule or club operating schedule and any mandatory conditions prescribed in the Act itself.

8.2 Where responsible authorities and interested parties raise relevant representations, the council may, if it is satisfied at a hearing or otherwise, impose conditions where considered necessary for the promotion of the licensing objectives.

8.3 Any conditions attached by the council or submitted by the applicant must focus on the direct impact of the activities taking place at licensed premises, on those attending the premises and residents and persons working in the area.

8.4 Any conditions attached to licences will be tailored to the individual needs, style and characteristics of the particular premises and events concerned and will be drawn from a 'model pool of conditions' (where appropriate) to the particular premises.

7. Determination of the Application

Members can take the following steps when determining a new premises licence application:

- grant the licence;
- exclude from the scope of the licence any of the licensable activities to which the application relates;
- refuse to specify a person in the licence as the premises supervisor;
- reject the application

8. Associated Papers

- A. Application Form & plan
- B. Licensing Rep
- C. Resident Reps
- D. Public Safety Rep & withdrawal
- E. OS Map

**Application for a premises licence to be granted under the Licensing Act
2003**

PLEASE READ THE FOLLOWING INSTRUCTIONS FIRST

Before completing this form please read the guidance notes at the end of the form.
If you are completing this form by hand please write legibly in block capitals. In all cases ensure that your answers are inside the boxes and written in black ink. Use additional sheets if necessary.

You may wish to keep a copy of the completed form for your records.

I/WE Star Pubs & Bars Limited (Insert name(s) of applicant)

apply for a premises licence under section 17 of the Licensing Act 2003 for the premises described in Part 1 below (the premises) and I/we are making this application to you as the relevant licensing authority in accordance with section 12 of the Licensing Act 2003

Part 1 – Premises Details

Postal address of premises or, if none, ordnance survey map reference or description Rising Sun 25 Harlesden Road Willesden Green			
Post Town	London	Postcode	NW10 2BY
Telephone number at premises			
Non-domestic rateable value of premises		£18,000.00	

Part 2 - Applicant Details

Please state whether you are applying for a premises licence as

Please tick yes

- | | | |
|--|-------------------------------------|-----------------------------|
| a) an individual or individuals | <input type="checkbox"/> | please complete section (A) |
| b) a person other than an individual | <input type="checkbox"/> | please complete section (B) |
| i. as a limited company | <input checked="" type="checkbox"/> | please complete section (B) |
| ii. as a partnership | <input type="checkbox"/> | please complete section (B) |
| iii. as an unincorporated association or | <input type="checkbox"/> | please complete section (B) |
| iv. other | <input type="checkbox"/> | |
| (for example a statutory corporation | <input type="checkbox"/> | please complete section (B) |
| c) a recognised club | <input type="checkbox"/> | please complete section (B) |
| d) a charity | <input type="checkbox"/> | please complete section (B) |
| e) the proprietor of an educational | <input type="checkbox"/> | |

- establishment ☐ please complete section (B)
- f) a health service body ☐ please complete section (B)
- g) a person who is registered under part 2 of the Care Standards Act 2000 (c14) in respect of an independent hospital in Wales ☐ please complete section (B)
- g(a) a person who is registered under Chapter 2 of Part 1 of the Health & Social Care Act 2008 (within the meaning of that Part) in an independent hospital in England ☐ Please complete section (B)
- h) the chief officer of police of a police force in England and Wales ☐ Please complete section (B)

If you are applying as a person described in (a) or (b) please confirm:

- I am carrying on or proposing to carry on a business which involves the use of the premises for licensable activities; or ☒
- I am making the application pursuant to a
 - Statutory function or ☐
 - A function discharged by virtue of Her Majesty's prerogative ☐

(A) INDIVIDUAL APPLICANTS (fill in as applicable)



Mr <input type="checkbox"/>	Mrs <input type="checkbox"/>	Miss <input type="checkbox"/>	Ms <input type="checkbox"/>	Other Title (for example, Rev)	
Surname			First names		
I am 18 years old or over <input type="checkbox"/>			Please tick yes		
Current postal address if different from premises address					
Post Town		Postcode			
Daytime contact telephone number					
E-mail address (optional)					

SECOND INDIVIDUAL APPLICANT (if applicable)

Mr <input type="checkbox"/>	Mrs <input type="checkbox"/>	Miss <input type="checkbox"/>	Ms <input type="checkbox"/>	Other Title (for example, Rev)	
Surname			First names		
I am 18 years old or over			<input type="checkbox"/>	Please tick yes	
Current postal address if different from premises address					
Post Town		Postcode			
Daytime contact telephone number					
E-mail address (optional)					

(B) OTHER APPLICANTS

Please provide name and registered address of applicant in full. Where appropriate please give any registered number. In the case of a partnership or other joint venture (other than a body corporate), please give the name and address of each party concerned.

Name Star Pubs & Bars Limited

Registered number (where applicable) 
Description of applicant (for example, partnership, company, unincorporated association etc.) Company
Telephone number (if any)
E-mail address (optional)

Part 3 Operating Schedule

When do you want the premises licence to start?

Day	Month	Year
<input type="text"/>	<input type="text"/>	<input type="text"/>

If you wish the licence to be valid only for a limited period, when do you want it to end?

Day	Month	Year
<input type="text"/>	<input type="text"/>	<input type="text"/>

Please give a general description of the premises (please read guidance note 1)

The premises operate as a public house with external area in London.

If 5,000 or more people are expected to attend the premises at any one time, please state the number expected to attend.

What licensable activities do you intend to carry on from the premises?

(Please see sections 1 and 14 and Schedules 1 and 2 to the Licensing Act 2003)

Provision of regulated entertainment (please read guidance note 2)

a) plays (if ticking yes, fill in box A)

Please tick yes

☐

b) films (if ticking yes, fill in box B)

☐

c) indoor sporting events (if ticking yes, fill in box C)

☒

d) boxing or wrestling entertainment (if ticking yes, fill in box D)

☐

e) live music (if ticking yes, fill in box E)

☒

f) recorded music (if ticking yes, fill in box F)

☒

g) performances of dance (if ticking yes, fill in box G)

☐

h) anything of a similar description to that falling within (e), (f) or (g)
(if ticking yes, fill in box H)

☐

Provision of late night refreshment (if ticking yes, fill in box I)

☐

Supply of alcohol (if ticking yes, fill in box J)

☒

In all cases complete boxes K, L and M

A

Plays Standard days and timings (please read guidance note 7)			Will the performance of a play take place indoors or outdoors or both – please tick (please read guidance note 3)	Indoors	<input type="checkbox"/>
				Outdoors	<input type="checkbox"/>
				Both	<input type="checkbox"/>
Day	Start	Finish	Please give further details here (please read guidance note 4)		
Mon					
Tue					
			State any seasonal variations for performing plays (please read guidance note 5)		
Wed					
Thur					
			Non standard timings. Where you intend to use the premises for the performance of plays at different times to those listed in the column on the left, please list (please read guidance note 6)		
Fri					
Sat					
Sun					

B

Films Standard days and timings (please read guidance note 7)			<u>Will the exhibition of films take place indoors or outdoors or both – please tick</u> (please read guidance note 2)	Indoors	<input type="checkbox"/>
				Outdoors	<input type="checkbox"/>
				Both	<input type="checkbox"/>
Day	Start	Finish	<u>Please give further details here</u> (please read guidance note 4)		
Mon					
Tue					
Wed					
Thur			<u>State any seasonal variations for the exhibition of films</u> (please read guidance note 5)		
Fri					
Sat					
Sun					
			<u>Non standard timings. Where you intend to use the premises for the exhibition of films at different times to those listed in the column on the left, please list</u> (please read guidance note 6)		

Indoor sporting events Standard days and timings (please read guidance note 7)			<u>Please give further details</u> (please read guidance note 4) To permit pub games that attract an audience, whether by advertisement or spontaneously, such as pool and darts. Please note that indoor sporting events are now deregulated between 08:00 and 23:00.
Day	Start	Finish	
Mon	23:00	00:00	
Tue	23:00	00:00	<u>State any seasonal variations for indoor sporting events</u> (please read guidance note 5)
Wed	23:00	00:00	
Thur	23:00	00:00	
Fri	23:00	00:00	<u>Non standard timings. Where you intend to use the premises for indoor sporting events at different times to those listed in the column on the left, please list</u> (please read guidance note 6) St George's Day, St Patrick's Day, Christmas Eve, Boxing Day and Bank Holidays – 23:00 until 01:00 the following day.
Sat	23:00	00:00	
Sun	23:00	00:00	

D

Boxing or wrestling entertainments Standard days and timings (please read guidance note 7)			<u>Will the boxing or wrestling entertainment take place indoors or outdoors or both – please tick</u> (please read guidance note 3)	Indoors	<input type="checkbox"/>
				Outdoors	<input type="checkbox"/>
				Both	<input type="checkbox"/>
Day	Start	Finish	<u>Please give further details here</u> (please read guidance note 4)		
Mon					
Tue					
Wed			<u>State any seasonal variations for boxing or wrestling entertainment</u> (please read guidance note 5)		
Thur					
Fri					
Sat			<u>Non standard timings. Where you intend to use the premises for boxing or wrestling entertainment at different times to those listed in the column on the left, please list</u> (please read guidance note 6)		
Sun					

E

Live music Standard days and timings (please read guidance note 7)			<u>Will the performance of live music take place indoors or outdoors or both – please tick</u> (please read guidance note 3)		Indoors <input checked="" type="checkbox"/>
					Outdoors <input type="checkbox"/>
					Both <input type="checkbox"/>
Day	Start	Finish	<u>Please give further details here</u> (please read guidance note 4) Please note that live music is deregulated between 08:00 and 23:00. One or two musicians only. This will be held in the rear bar only with exception of holidays when the front bar could be used as well. Live acoustic and amplified music and amplified voice.		
Mon	23:00	00:00			
Tue	23:00	00:00	<u>State any seasonal variations for the performance of live music</u> (please read guidance note 5)		
Wed	23:00	00:00			
Thur	23:00	00:00	<u>Non standard timings. Where you intend to use the premises for the performance of live music at different times to those listed in the column on the left, please list</u> (please read guidance note 6) St George's Day, St Patrick's Day, Christmas Eve, Boxing Day and Bank Holidays – 23:00 until 01:00 the following day.		
Fri	23:00	00:00			
Sat	23:00	00:00			
Sun	23:00	00:00			

Recorded music Standard days and timings (please read guidance note 7)			<u>Will the playing of recorded music take place indoors or outdoors or both – please tick</u> (please read guidance note 3)	Indoors	<input checked="" type="checkbox"/>
				Outdoors	<input type="checkbox"/>
				Both	<input type="checkbox"/>
Day	Start	Finish	<u>Please give further details here</u> (please read guidance note 4) Please note that recorded music is deregulated between 08:00 and 23:00. Recorded music including from jukebox and TV with or without a DJ during normal business hours or as part of a function and maybe including audience participation.		
Mon	23:00	00:00			
Tue	23:00	00:00	<u>State any seasonal variations for the playing of recorded music</u> (please read guidance note 5)		
Wed	23:00	00:00			
Thur	23:00	00:00	<u>Non standard timings. Where you intend to use the premises for the playing of recorded music at different times to those listed in the column on the left, please list</u> (please read guidance note 6) St George's Day, St Patrick's Day, Christmas Eve, Boxing Day and Bank Holidays – 23:00 until 01:00 the following day.		
Fri	23:00	00:00			
Sat	23:00	00:00			
Sun	23:00	00:00			

Supply of alcohol Standard days and timings (please read guidance note 7)			Will the supply of alcohol be for consumption (Please tick box) (please read guidance note 8)	On the premises	<input type="checkbox"/>
				Off the premises	<input type="checkbox"/>
				Both	<input checked="" type="checkbox"/>
Day	Start	Finish	State any seasonal variations for the supply of alcohol (please read guidance note 5)		
Mon	11:00	00:00			
Tue	11:00	00:00			
Wed	11:00	00:00			
Thur	11:00	00:00	Non standard timings. Where you intend to use the premises for the supply of alcohol at different times to those listed in the column on the left, please list (please read guidance note 6) St George's Day, St Patrick's Day, Christmas Eve, Boxing Day and Bank Holidays – 11:00 until 01:00 the following day.		
Fri	11:00	01:00			
Sat	11:00	01:00			
Sun	11:00	00:00			

State the name and details of the individual whom you wish to specify on the licence as designated premises supervisor (Please see declaration about the entitlement to work in the checklist at the end of the form):

Name Michaela Grealis
Date of Birth [REDACTED]
Address [REDACTED] [REDACTED] [REDACTED] [REDACTED]
Personal Licence number (if known) [REDACTED]
Issuing licensing authority (if known) [REDACTED]

Late night refreshment Standard days and timings (please read guidance note 7)			Will the provision of late night refreshment take place indoors or outdoors or both – please tick (please read guidance note 3)	Indoors	<input type="checkbox"/>
				Outdoors	<input type="checkbox"/>
				Both	<input type="checkbox"/>
Day	Start	Finish			
Mon			<u>Please give further details here</u> (please read guidance note 4)		
Tue					
Wed			<u>State any seasonal variations for the provision of late night refreshment</u> (please read guidance note 5)		
Thur					
Fri			<u>Non standard timings. Where you intend to use the premises for the provision of late night refreshment at different times, to those listed in the column on the left, please list</u> (please read guidance note 6)		
Sat					
Sun					

Anything of a similar description to that falling within (e), (f) or (g) Standard days and timings (please read guidance note 7)			<u>Please give a description of the type of entertainment you will be providing</u>	
Day	Start	Finish	<u>Will this entertainment take place indoors or outdoors or both – please tick</u> (please read guidance note 3)	Indoors <input type="checkbox"/>
Mon				Outdoors <input type="checkbox"/>
				Both <input type="checkbox"/>
Tue			<u>Please give further details here</u> (please read guidance note 4)	
Wed				
Thur			<u>State any seasonal variations for entertainment of a similar description to that falling within (e), (f) or (g)</u> (please read guidance note 5)	
Fri				
Sat			<u>Non standard timings. Where you intend to use the premises for the entertainment of a similar description to that falling within (e), (f) or (g) at different times to those listed in the column on the left, please list</u> (please read guidance note 6)	
Sun				

G

Performances of dance Standard days and timings (please read guidance note 7)			Will the performance of dance take place indoors or outdoors or both – please tick (please read guidance note 3)	Indoors	<input type="checkbox"/>
				Outdoors	<input type="checkbox"/>
				Both	<input type="checkbox"/>
Day	Start	Finish			
Mon			Please give further details here (please read guidance note 4)		
Tue					
Wed			State any seasonal variations for the performance of dance (please read guidance note 5)		
Thur					
Fri			Non standard timings. Where you intend to use the premises for the performance of dance at different times to those listed in the column on the left, please list (please read guidance note 6)		
Sat					
Sun					

K

Please highlight any adult entertainment or services, activities, other entertainment or matters ancillary to the use of the premises that may give rise to concern in respect of children (please read guidance note 9)

NONE

L

Hours premises are open to the public Standard days and timings (please read guidance note 7)			State any seasonal variations (please read guidance note 5)
Day	Start	Finish	
Mon	11:00	00:30	Non standard timings. Where you intend the premises to be open to the public at different times from those listed in the column on the left, please list (please read guidance note 6) St George's Day, St Patrick's Day, Christmas Eve, Boxing Day and Bank Holidays – 11:00 until 01:00 the following day.
Tue	11:00	00:30	
Wed	11:00	00:30	
Thur	11:00	00:30	
Fri	11:00	01:30	
Sat	11:00	01:30	
Sun	12:00	00:30	

M - Describe the steps you intend to take to promote the four licensing objectives:

a) General – all four licensing objectives (b,c,d,e) (please read guidance note 10)

Please note that this application is made following the lapsing of the previous Licence. The intention is to exactly reproduce the conditions on the previous Licence. The previous condition number is given to assist in this regard.

Snacks shall be available during the whole of licensed hours in all parts of the premises where intoxicants are provided. (7)

b) The prevention of crime and disorder

CCTV shall be installed to Home Office guidance standards and maintained in a good working condition and recordings shall be kept for 31 days and shall be made available to Police and authorised officers from Brent Council upon request. This must comply with the Data Protection Act including signage.(1)

A copy of the Premises Licence Summary including the hours which licensable activities are permitted shall be visible from the outside of each entrance of the premises.(2)

Customers shall not be permitted to take open glass containers outside the premises as defined on the plan submitted to and approved by the Licensing Authority.(3)

A personal licence holder shall be present on the premises and supervise the sale of alcohol throughout the permitted hours for the sale of alcohol when the premises are holding a private function.(4)

The total number of people permitted on the premises including staff and performers shall not exceed 150.(5)

No entry or re-entry shall be permitted after 23:00 hours Sunday to Thursday and 23:30 hours Friday and Saturday and on Mondays where seasonal variations apply.(8)

An incident log shall be kept on the premises and made available for inspection on request to an authorised officer of Brent Council or the Police which will record the following:

- All crimes reported to the venue
- All ejections of patrons
- Any complaints received
- Any incidents of disorder
- All seizures of drugs or offensive weapons
- Any faults in the CCTV system or searching equipment or scanning equipment
- Any refusal of the sale of alcohol
- Any visit by a relevant authority or emergency service (19)

Any staff directly involved in selling alcohol for retail to consumers, staff who provide training including managers shall undergo regular training of the Licensing Act 2003 legislation. The training shall be documented and signed off by the DPS and the member of staff receiving the training. This training log shall be kept on the premises and made available for inspection by the Police and relevant authorities upon request.(20)

On the days when door supervisors are required a door supervisor shall be located at the entrance of the beer garden to supervise the area. (25)

c) Public safety

d) The prevention of public nuisance

A noise limiting device set at a level agreed by Environmental Health shall be installed and shall be operated at all times when the premises are open to the public and when regulated entertainment is taking place.(11)

Both sets of entrance/exit doors to the back room shall be lobbied doors.(12)

No music shall be audible at or within the site boundary or any residential property.(13)

No form of loudspeaker or sound amplification shall be sited on or near the exterior of the premises or in any foyer, doorway, window or opening to the premises.(14)

Signs shall be placed in the beer garden/on the frontage instructing patrons to recognise the residential nature of the area and conduct their behaviour accordingly. The management shall reserve the right to ask patrons to move inside the premises or leave if it felt that they could be disturbing neighbours.(15)

There shall be no queuing outside the premises.(16)

When door supervisors are employed they shall ensure patrons leave the premises in a prompt and courteous manner. (17)

When door supervisors are employed they shall patrol the curtilage of the premises to prevent patrons urinating in public areas.(18)

No regulated entertainment or television shall be permitted in the beer garden.(26)

No alcohol shall be consumed in the beer garden after 23:00 hours.(27)

No smoking shall be permitted at the front of the premises.(28)

e) The protection of children from harm

A Challenge 25 policy shall be adopted and adhered to.(6)

No children shall be permitted on the premises after 22:00 hours.(10)

No children shall be admitted unless accompanied by a responsible adult. (9)

Checklist

**Please tick to
indicate agreement**

- I have made or enclosed payment of the fee ☒
- I have enclosed the plan of the premises ☒
- I have sent copies of this application and the plan to responsible authorities and others where applicable ☒
- I have enclosed the consent form completed by the individual I wish to be premises supervisor, if applicable ☒
- I understand that I must now advertise my application ☒
- I understand that if I do not comply with the above requirements my application will be rejected

- [Applicable to all individual applicants, including those in a partnership which is not a limited liability partnership, but not companies or limited liability partnerships] I have included documents demonstrating my entitlement to work in the United Kingdom (please read note 15). ☒

IT IS AN OFFENCE, UNDER SECTION 158 OF THE LICENSING ACT 2003, TO MAKE A FALSE STATEMENT IN OR IN CONNECTION WITH THIS APPLICATION. THOSE WHO MAKE A FALSE STATEMENT MAY BE LIABLE ON SUMMARY CONVICTION TO A FINE OF ANY AMOUNT.

IT IS AN OFFENCE UNDER SECTION 24B OF THE IMMIGRATION ACT 1971 FOR A PERSON TO WORK WHEN THEY KNOW, OR HAVE REASONABLE CAUSE TO BELIEVE, THAT THEY ARE DISQUALIFIED FROM DOING SO BY REASON OF THEIR IMMIGRATION STATUS. THOSE WHO EMPLOY AN ADULT WITHOUT LEAVE OR WHO IS SUBJECT TO CONDITIONS AS TO EMPLOYMENT WILL BE LIABLE TO A CIVIL PENALTY UNDER SECTION 15 OF THE IMMIGRATION, ASYLUM AND NATIONALITY ACT 2006 AND PURSUANT TO SECTION 21 OF THE SAME ACT, WILL BE COMMITTING AN OFFENCE WHERE THEY DO SO IN THE KNOWLEDGE, OR WITH REASONABLE CAUSE TO BELIEVE, THAT THE EMPLOYEE IS DISQUALIFIED.

Part 4 – Signatures (please read guidance note 11)

Signature of applicant or applicant's solicitor or other duly authorised agent (See guidance note 12). If signing on behalf of the applicant please state in what capacity.

Declaration	<ul style="list-style-type: none"> • [Applicable to individual applicants only, including those in a partnership which is not a limited liability partnership] I understand I am not entitled to be issued with a licence if I do not have the entitlement to live and work in the UK (or if I am subject to a condition preventing me from doing work relating to
--------------------	---

	<p>the carrying on of a licensable activity) and that my licence will become invalid if I cease to be entitled to live and work in the UK (please read guidance note 15).</p> <ul style="list-style-type: none"> The DPS named in this application form is entitled to work in the UK (and is not subject to conditions preventing him or her from doing work relating to a licensable activity) and I have seen a copy of his or her proof of entitlement to work, if appropriate (please see note 15)
Signature	<i>Andrew Cochrane</i>
Date	12.6.19
Capacity	Solicitor

For joint applications signature of 2nd applicant or 2nd applicant's solicitor or other authorised agent. (please read guidance note 13). If signing on behalf of the applicant please state in what capacity.

Signature	
Date	
Capacity	

<p>Contact name (where not previously given) and postal address for correspondence associated with this application (please read guidance note 14)</p> <p>Andrew Cochrane Flint Bishop LLP St. Michael's Court St. Michael's Lane Derby DE1 3HQ</p>	
Telephone number (if any)	01332 226142
<p>If you would prefer us to correspond with you by e-mail your e-mail address (optional)</p> <p>andrew.cochrane@flintbishop.co.uk</p>	

Notes for Guidance

- Describe the premises, for example the type of premises, its general situation and layout and any other information which could be relevant to the licensing objectives. Where your application includes off-supplies of alcohol and you intend to provide a place for consumption of these off-supplies, you must include a description of where the place will be and its proximity to the premises.
- In terms of specific regulated entertainments please note that:
 - Plays: no licence is required for performances between 08:00 and 23.00 on any day, provided that the audience does not exceed 500.

- **Films:** no licence is required for 'not-for-profit' film exhibition held in community premises between 08.00 and 23.00 on any day provided that the audience does not exceed 500 and the organiser (a) gets consent to the screening from a person who is responsible for the premises; and (b) ensures that each such screening abides by age classification ratings.
- **Indoor sporting events:** no licence is required for performances between 08.00 and 23.00 on any day, provided that the audience does not exceed 1000.
- **Boxing or Wrestling Entertainment:** no licence is required for a contest, exhibition or display of Greco-Roman wrestling, or freestyle wrestling between 08.00 and 23.00 on any day, provided that the audience does not exceed 1000. Combined fighting sports – defined as a contest, exhibition or display which combines boxing or wrestling with one or more martial arts – are licensable as a boxing or wrestling entertainment rather than an indoor sporting event.
- **Live music:** no licence permission is required for:
 - a performance of unamplified live music between 08.00 and 23.00 on any day, on any premises.
 - a performance of amplified live music between 08.00 and 23.00 on any day on premises authorised to sell alcohol for consumption on those premises, provided that the audience does not exceed 500.
 - a performance of amplified live music between 08.00 and 23.00 on any day, in a workplace that is not licensed to sell alcohol on those premises, provided that the audience does not exceed 500.
 - a performance of amplified live music between 08.00 and 23.00 on any day, in a church hall, village hall, community hall, or other similar community premises, that is not licensed by a premises licence to sell alcohol, provided that (a) the audience does not exceed 500, and (b) the organiser gets consent for the performance from a person who is responsible for the premises.
 - a performance of amplified live music between 08.00 and 23.00 on any day, at the non-residential premises of (i) a local authority, or (ii) a school, or (iii) a hospital, provided that (a) the audience does not exceed 500, and (b) the organiser gets consent for the performance on the relevant premises from: (i) the local authority concerned, or (ii) the school or (iii) the health care provider for the hospital.
- **Recorded Music:** no licence permission is required for:
 - any playing of recorded music between 08.00 and 23.00 on any day on premises authorised to sell alcohol for consumption on those premises, provided that the audience does not exceed 500.
 - any playing of recorded music between 08.00 and 23.00 on any day, in a church hall, village hall, community hall, or other similar community premises, that is not licensed by a premises licence to sell alcohol, provided that (a) the audience does not exceed 500, and (b) the organiser gets consent for the performance from a person who is responsible for the premises.
 - any playing of recorded music between 08.00 and 23.00 on any day, at the non-residential premises of (i) a local authority, or (ii) a school, or (iii) a hospital, provided that (a) the audience does not exceed 500, and (b) the organiser gets consent for the performance on the relevant premises from: (i) the local authority concerned, or (ii) the school proprietor or (iii) the health care provider for the hospital.

- 6 FEB 2019

Plan Applicable to Licence

No: 161325

- 6 FEB 2019

Plan Applicable to Licence
No: 161325

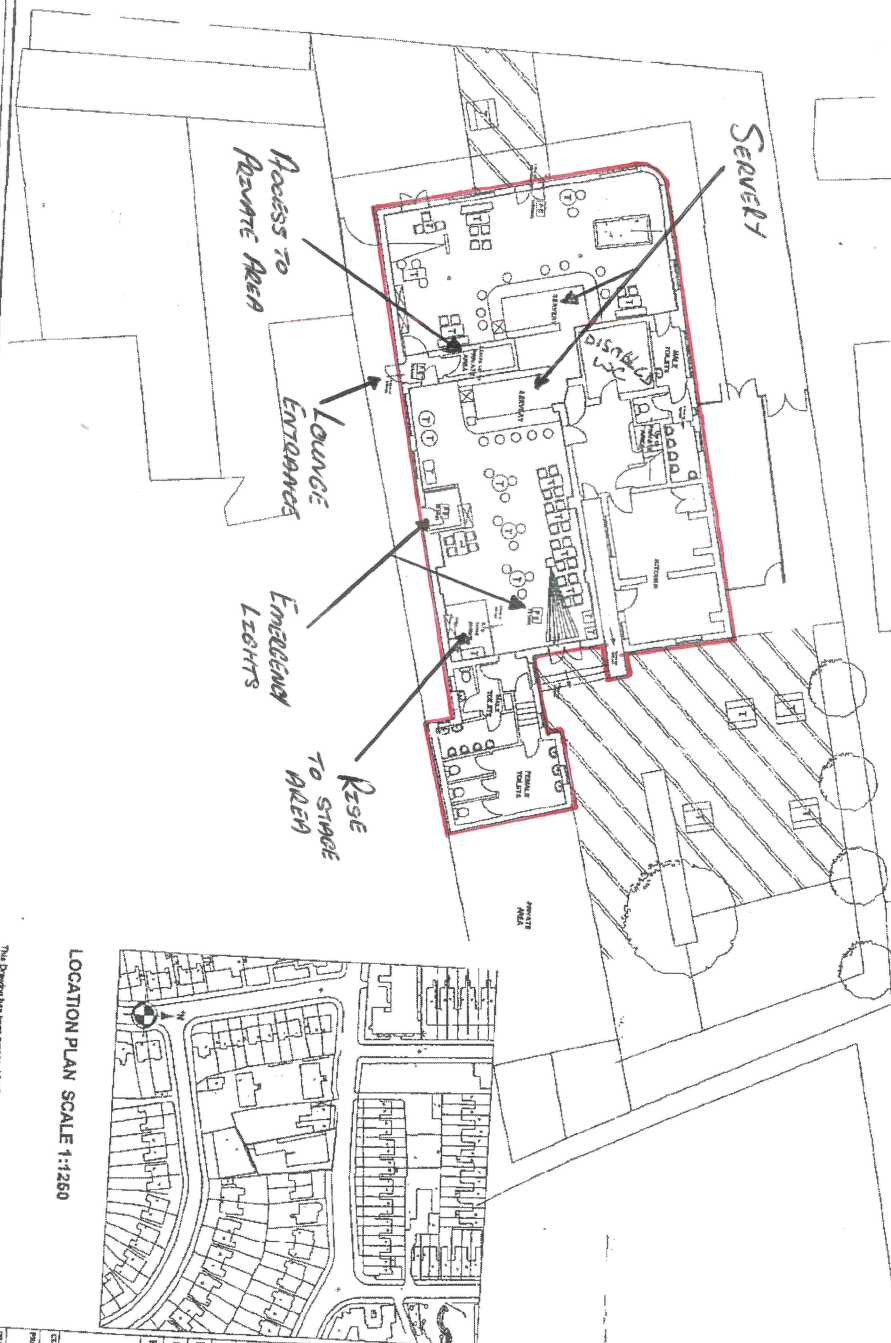

LOCATION PLAN SCALE 1:1250

The Rising Sun,
26 Harleston Road,
London.
NW10 2BY

-
- 7.1 Monitor.
- CRIM.
- TRUCK.
- Pool
Tosh.
- Bar
Stool.
- ANALOGY Video and
ATM.
- Ductwork.
- PROJECT & SURVE.
- Maintained EXIT Sign.
- Emergency Light.
- Broad Glass Fire Alarm Call Point.
- Fire Alarm Horn.
- Ionisation Smoke Detector.
- Heat Detector.
- AIRFF extinguisher - 6 litre
capacity
- CO2 Extinguisher - 2kg capacity
- Dry Powder Extinguisher -
2.2kg w/ 4kg capacity
- Water Extinguisher - 9 litre
capacity
- Fire Blanket - 1.2m x 1.2m

[illegible]

LOADING FLOOR AREA	
EVA, drinking area and entrance lockable internal	8.4 m
Gross Floor Area: Everything less lift area's accommodation (internal)	144.00
Kitchen Floor Area	232.75
Dining Corridor	22.69
External Drinking Areas	6.9
	445.83

IT DESIGN

JEFF MASON DESIGN ASSOCIATES
HOTEL & LEISURE DESIGN CONSULTANTS

LEIBERSON DESIGN CONSULTANTS
 10000 Highway 100 • Suite 100 • Overland Park, KS 66210
 913-666-1100 • Telex: 154141 • Fax: 913-666-1101

Moving from Travel to Health • Health and a Real Business Opportunity for You
 \$499/yr

Scottish & Newcastle Pub Enterprises

The Rising Sun, 25 Harleston Road

London: WW10 2E

Licensing Layout

DATE TIME DAY

1:100 JAN 1981 12.07.01

All documents are the property of the publisher. This document is copyrighted and

.....

This page is intentionally left blank

Star Pubs & Bars Limited
Rising Sun
25 Harlesden Road
London
NW10 2BY

9 July 2019

Our Ref: 16434

Dear Sir/Madam,

Licensing Representation to the Initial Application for the Premises Licence at Rising Sun, 25 Harlesden Road, London, NW10 2BY

I certify that I have considered the application shown above and I wish to make a representation that the likely effect of the grant of the application is detrimental to the Licensing Objectives for the reasons indicated below.

An officer of the Licensing Authority, in whose area the premises are situated, who is authorised for the purposes of exercising its statutory function as a 'Responsible Authority' under the Licensing Act 2003.

The application has been made for a new premises licence under section 17 of the Act.

The Licensing Authority representations are primarily concerned with the four licensing objectives;

- the prevention of crime and disorder;
- public safety;
- the prevention of public nuisance; and
- the protection of children from harm.

Complaint

As you are already aware, my letter dated to you on 11th June 2019, describes a complaint that has been received from a resident that alleges nuisance outside the front of the premises. This includes: -

- Customers drinking outside the front of the premises
- Customers smoking outside the front of the premises
- Issues with dispersal – loud talking, shouting and offensive language

There were a number of conditions on the lapsed premises licence that existed in order to avoid nuisance externally but it appears these conditions were not being met. These include: -

- No smoking shall be permitted at the front of the premises.
- Customers shall not be permitted to take open glass containers outside the premises as defined on the plan submitted to and approved by the Licensing Authority.

It is recognised that customers will want to smoke during the time the premises is open, but this must be done in a controlled manner so as not to disturb neighbouring residents. The conditions below should reflect this.

Consumption of Alcohol

The plan submitted with the application does not include the rear external area but one of the proposed conditions below asks that customers do not take open drink containers off the plans of the premises. This mirrors the condition on the lapsed premises licence. In order to ensure customers can consume alcohol in the rear external area, the plan must be modified to include the rear external area and then be emailed to business.licence@brent.gov.uk

Licence Conditions

The Licensing Authority require the following points to be included in the operating schedule or added as conditions on the premises licence:

1. CCTV shall be installed to Home Office Guidance standards and maintained in a good working condition and recordings shall be kept for 31 days and shall be made available to police and authorised Officers from Brent Council.
2. The CCTV system shall be capable of obtaining clear facial recognition images and a clear head and shoulders image of every person entering or leaving the premises.
3. A member of staff shall always be present on the premises whilst they are open who is capable operating the CCTV system and able to facilitate immediate viewing of CCTV footage upon the request of the Police and Authorised Officer of the Licensing Authority.
4. CCTV cameras shall be installed to cover the entrance of the premises, the servery counter and all of the external areas.
5. A "Challenge 25" policy shall be adopted and adhered to at all times
6. A sign stating "No proof of age – No sale" shall be displayed at the point of sale.
7. A copy of the premises licence summary including the hours which licensable activities are permitted shall be visible from the outside of each entrance to the premises.
8. Any staff directly involved in selling alcohol for retail to consumers, staff who provide training including managers shall undergo regular training of the Licensing Act 2003 legislation. The training shall be documented and signed off by the DPS and the member of staff receiving the training. This training log shall be kept on the premises and made available for inspection by police and relevant authorities upon request.
9. An incident log shall be kept at the premises, and made available for inspection on request to an authorised officer of Brent Council or the Police, which will record the following:
 - (a) all crimes reported to the venue
 - (b) all ejections of patrons
 - (c) any complaints received

- (d) any incidents of disorder
 - (e) all seizures of drugs or offensive weapons
 - (f) any faults in the CCTV system or searching equipment or scanning equipment
 - (g) any refusal of the sale of alcohol
 - (h) any visit by a relevant authority or emergency service.
10. Notices asking customers to leave quietly shall be conspicuously displayed at all exits, including outside of the front external area.
11. No noise or vibration shall be detectable at any neighbouring noise sensitive premises.
12. A personal licence holder shall be present on the premises and supervise the sale of alcohol throughout the permitted hours for the sale of alcohol.
13. The rear external area shall cease use at 23.00hrs.
14. Customers shall not be permitted to take open drink containers outside the premises as defined on the plan submitted to and approved by the Licensing Authority.
15. Snacks shall be available during the whole of licensed hours in all parts of the premises where intoxicants are provided.
16. No entry or re-entry shall be permitted after 23:00 hours Sunday to Thursday and 23:30 hours Friday and Saturday and on Monday's where seasonal variations apply.
17. No children shall be admitted unless accompanied by a responsible adult.
18. No children shall be permitted on the premises after 22:00 hours.
19. There shall be no queuing outside the premises.
20. Both sets of entrance/exit doors to the back room shall be lobbied doors.
21. Signs shall be placed in the beer garden/on the frontage instructing patrons to recognise the residential nature of the area and conduct their behaviour accordingly -- The management shall reserve the right to ask patrons to move inside the premises or leave if it felt that they could be disturbing neighbours.
22. The front external area shall not be used by customers with the exception of the following: - After 23.00hrs when the rear external area ceases use, the designated smoking area (DSA) shall be located at the front of the premises facing Harlesden Road. Smoking shall be limited to 5 persons. This shall be in a cordoned off area and shall be monitored by the members of staff on duty at the premises.
23. The premises shall have a comprehensive written dispersal policy in place. This document shall be cascaded in the form of training to all members of staff and provided to the police or an officer from Brent Council upon request.

The Licensing Authority reserve the right to add additional conditions if required prior/during the Licensing hearing, should any be required.

In order for the Licensing Authority to withdraw this representation, it will be necessary for you to confirm that your client accept the above conditions in writing and provide an up to date plan by Monday 22nd October 2018 .

Yours faithfully



Esther Chan
Licensing Inspector
Planning, Transportation & Licensing

From: Nikki Rennie **On Behalf Of** Andrew Cochrane
Sent: 12 July 2019 10:35
To: Chan, Esther <Esther.Chan@brent.gov.uk>
Cc: Business Licence <business.licence@brent.gov.uk>
Subject: RE: CONSULT: New Premises - Rising Sun, 25 Harlesden Road, Willesden Green, NW10 2BY - 16434

Dear Esther

Thank you for your letter of the 9 July.

Your proposed conditions are agreed although, in large part, they duplicate what has already been offered although we accept there are some differences and this will obviously need to be considered in the drafting of the Licence.

Please also find attached the revised plan as requested.

Yours sincerely

Andrew Cochrane
Chairman and Senior Partner
Head of Licensing

DD 01332 226 142 ext: 231
M 07720 414 598
F 01332 207 601
DX 729320 DERBY 24

Flint Bishop LLP St. Michael's Court, St. Michael's Lane, Derby, DE1 3HQ



This page is intentionally left blank

10-07-2019

with all the respect. With our 2 babies living behind the pub we cannot live in peace with such a loud schedule



This page is intentionally left blank

04-07-2019

I object to the extended opening times and serving extended alcohol serving times as the pub is situated in the hear of a quiet residential area. We do not need more noise from loud music from the pub which can be heard in our home! Also, we do not need the anti social behaviour which so often occurs as a result of later opening / drinking hours

This page is intentionally left blank

Sent: 10 July 2019 09:14

To: Business Licence <business.licence@brent.gov.uk>

Subject: The Rising Sun Pub, Harlesden Road, London NW10 2BY

Dear Sir/Madam,

I hereby write to lodge my vehement objection to the licence application submitted recently by the above establishment.

I own flat [REDACTED] which is situated [REDACTED] to the public house.

At present there are frequent occasions where the loutish behaviour of some members of the public who come out of the pub inebriated causes a noise disturbance.

If the licence is extended as proposed this will only lead to more unsocial behaviour. There is precious little parking available in the area. This will lead to more litter being left in the surrounding vicinity. Already there have been frequent sightings of rodents in the vicinity.

Ultimately this will lead to property values dropping.

I have made my representation to the my local MP and will do so to my local councillor as well.

Regards

This page is intentionally left blank

10-07-2019

We, the affected and named residents, hereby expressed our objection to renewing Star Pubs & Bars Limited's (t/a The Rising Sun) licencing application (number 16434) made under The Licensing Act 2003 for Alcohol and Entertainment including the licence to carry out after the hours of 9pm weekdays (Mondays to Fridays) the following activities: Supply of alcohol on/off sale Recorded/Live music Indoor In carrying out its functions under the Licencing Act 2003 (the Act), Brent Council must do so with a view to promoting the licensing objectives set out under Part 2, Section 4 of the Act. We believe that a grant of the application (at least in the terms requested) is not appropriate for the promotion of the licensing objectives, which are: (a) prevention of crime and disorder (b) public safety (c) prevention of public nuisance and (d) protection of children from harm Prevention of crime and disorder: We and our neighbours have observed people in heavily intoxicated states coming out of The Rising Sun and being involved in illegal behaviour. These directly affect our basic rights to rest and leisure, and our rights to adequate living standards and personal security. On the 24/05/2019, the police were called to an incident at the Rising Sun where it was discovered that the management had been operating without a proper licence. We believe this is why the Rising Sun is applying to renew and extend its licence. Another incident took place again on the 26/05/2019, which caused some residents to again call the police. Endorsing these trading hours during the weeknights will not only lead to an increase in this type of behaviours which are causing the residents unreasonable and substantial discomfort, but it will also encourage and promote the already high crime rate in the area. Please note, in the case of *East Lindsey District Council v Abu Hanif (t/a Zara's Restaurant)*(2016) Mr Justice Jay said: "[T]he prevention of crime and disorder requires a prospective consideration of what is warranted in the public interest, having regard to the twin considerations of prevention and deterrence." Public Safety: It has been witnessed and reported by several neighbours that often crowds of drinkers outside the pub and the customers or pub staff/owners cars parked right outside the pub entrance force pedestrians to walk in the road, posing a risk to public safety. Prevention of public nuisance: In the last year or two it has been noticed a substantial increase in the amount of noise coming from the pub; not only from music but also from people yelling, mainly on weekends but a marked increased during the week nights too. It is not only the noise from the entertainment/ band rehearsals, patrons inside and in the garden (which is adjacent to ours) that is concerning, but also from the people who regularly loiter outside the pub, often inebriated, shouting obscenities at each other which sometimes leads to physical altercations late at night. The litters, urination and bottles being left around make our neighbourhood look unpleasant, and make it less pleasant to live. We believe that the above objective will continued to be undermined if the licence is granted in the terms requested. There will be nuisance caused to residents through late night noise and anti-social behaviour. Having regard to the existing levels of alcohol-related crime and anti-social behaviour, I believe that this will be worsened if this application is granted. Protection of children from harm: A licence to play live/recorded music or for band rehearsals during weeknights until 12.30am in a residential area will have a significant and negative impact on the well-being of the residents within a 6 house radius of the pub. For example, a neighbour 6 houses away has complained to us of how loud the music has become. Granting this licence application in the terms requested will have a detrimental effect on residents' quantity and quality of sleep, impact on the elderly as the working age residents. Moreover, granting this licence application in the terms requested will have a detrimental effect on the educational outcomes of children and young people who live in this vicinity. We have already taken measures to alleviate our concerns including wearing earplugs, turning our television sets up, etc. to no much effect. Our property already has measures in place to reduce noise i.e double glazing, etc., however the music coming from the pub is often so loud and well beyond 9pm on weeknights that even when our windows are closed the noise makes hard for us to sleep or rest in peace and quiet. The Council must appreciate that having all windows closed to try and sleep during summer nights makes it extremely uncomfortable. The issue with the pub playing music on their

premises is the lack of control to measure the maximum level of decibel allowed in a residential area. We have seen no measures that the Rising Sun are proposing to combat and reduce the noise level emanating from the live and/or recorded music it is seeking licence to play. We hence request that the local authority monitor that level of noise and/or impose conditions to the licence, if granted, including the installation of adequate sound proof barriers to reduce the noise and alleviate its effects on the residents. We also request that the Council reduce the hours during which the Rising Sun is allowed to sell alcohol and play music during weekdays to 9pm. Objection to Application number 16434

https://mylicence.brent.gov.uk/registers/index.html?fa=licence_register&_ga=2.24208634.1509090247.1562018357-1083108785.1488736435

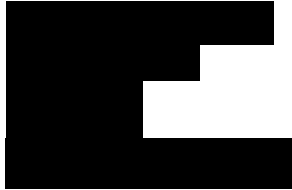

I strongly object to this application - [REDACTED] This is a residential area and the pub already regularly holds parties and discos on Fridays and Saturday nights which go on up to 2am the next morning. I am usually unable to sleep until 2am during the pub's party nights and have often called the pub at 2am in the morning to remind them of their licence obligations. In other words, the pub already pays little heed to existing licensing obligations. I can also hear screaming rows and fighting between pub users in the smoking corridor adjacent to our property late into the night. Extending the pub's licence to midnight and/or extending the existing hours of serving alcohol at weekends will be of great detriment to local peoples' lives. Brent Council should reject this application and instead make more effort to ensure that the pub does not continue to infringe its existing licensing restrictions.

[REDACTED]

[REDACTED]

This page is intentionally left blank

A NOTE TO REGISTER VERY PROFOUND DISAGREEMENT WITH THE PROPOSED NOTICE OF APPLICATION FOR A PREMISES LICENCE IN THE RISING SUN

[REDACTED]

IT IS ALREADY VERY NOISY

THERE ARE OFTEN FIGHTS IN THE NIGHTS

I DO NOT THINK THE PUB'S TIME SHOULD BE EXTENDED – WITH MORE ALCOHOL, MORE SPORT, MORE MUSIC LIVE AND RECORDED, AND GREATER OPENING TIMES

THE PUB IS ALREADY SUFFICIENTLY ACTIVE AND OPEN ENOUGH OF THE TIME

I PROFOUNDLY DISAGREE WITH THE SCOPE OF ITS BEING EXTENDED AND I AM ENTIRELY SURE THAT THE ENTIRETY OF OUR STREET WOULD BE IN AGREEMENT

YOURS VERY SINCERELY

[REDACTED]

[REDACTED]

This page is intentionally left blank

From: ED
Sent: 26 June 2019 11:42
To: Andrew Cochrane
Cc: Business Licence <business.licence@brent.gov.uk>
Subject: RE: (C003865) - Rising Sun, 25 Harlesden Road, Willesden Green, London - application for new Premises Licence

Dear Andrew

Thank you. The note I received made explicit reference to the hours being extended. Is this not the case?

Best regards

Edward

From: Nikki Rennie **On Behalf Of** Andrew Cochrane
Sent: Wednesday, June 26, 2019 11:31 AM
To: ED
Cc: Business Licence
Subject: (C003865) - Rising Sun, 25 Harlesden Road, Willesden Green, London - application for new Premises Licence

Dear

I have been forwarded your representation by the Licensing Officer at Brent Council in respect of this application.

I would be very happy to discuss this matter with you, you can contact me on the telephone number given below. Alternatively I can arrange for the site operators to meet with you if you think that would be of use.

I would however like to offer this reassurance and that is that it is not proposed to extend the hours of operation of the premises which appears to be your principal concern.

For technical reasons, it was necessary for us to apply for a new Premises Licence, which largely mirrors that that was previously in force for the premises including as to hours.

I hope this provides the reassurance that you require.

Yours sincerely

Andrew Cochrane
Chairman and Senior Partner
Head of Licensing

Flint Bishop LLP St. Michael's Court, St. Michael's Lane, Derby, DE1 3HQ

**Flint
Bishop**
SOLICITORS

This page is intentionally left blank

I wish to object most vigorously to any extension to The Rising Sun's licencing or entertainment hours . This pub is already a problem and should never be allowed to operate in the centre of a residential area. As it is residence are disturbed by rowdy behaviour, noise , and some very unpleasant characters , generated by and frequenting the pub . A pub such as this needs to be situated in a high street not a residential street where children should be able to walk freely and young women safe . Police have already been called to the pub and the unpleasant atmosphere generated can only get worse with any extension to its opening hrs/music licence. Further It is likely that Harlesden Road will seriously deteriorate with residents particularly those with children being forced to move away .

This page is intentionally left blank

Sent: 01 July 2019 11:17

To: Business Licence <business.licence@brent.gov.uk>

Subject: Application for extended licence at NW10 2BY

Dear Sirs,

Re: licence application for Rising Sun pub, 25 Harlesden Road

As owners of a flat at [REDACTED] we would like to present our opposition to the extended licence applied for at the above address.

Many residents of this property, as in the rest of the neighbourhood, are families with school age children. Extending music and alcohol sales until midnight on weekdays is likely to be disruptive due to noise and potentially anti-social behaviour with police intervention. We request that this extension be at the most granted only for Fridays and Saturdays.

Additional factors from homeowners' and tenants' point of view are the extra disturbance to that already caused by cars being parked outside [REDACTED] and the potential reduction in property and rental values as a result of all the above.

Please keep us informed by email of any developments with this application. We sincerely hope that your department will take seriously the concerns of all local residents.

Kind regards

This page is intentionally left blank

11-07-2019

I am opposed to this and hereby express my strong objection to renewing Star Pubs & Bars Limited's (t/a The Rising Sun) licencing application (number 16434) made under The Licensing Act 2003 for Alcohol and Entertainment including the licence to carry out after the hours of 9pm weekdays (Mondays to Fridays) the following activities: Supply of alcohol on/off sale Recorded/Live music Indoor In carrying out its functions under the Licencing Act 2003 (the Act), Brent Council must do so with a view to promoting the licensing objectives set out under Part 2, Section 4 of the Act. We believe that a grant of the application (at least in the terms requested) is not appropriate for the promotion of the licensing objectives, which are: (a) prevention of crime and disorder (b) public safety (c) prevention of public nuisance and (d) protection of children from harm

Prevention of crime and disorder: We and our neighbours have observed people in heavily intoxicated states coming out of The Rising Sun and being involved in illegal behaviour. These directly affect our basic rights to rest and leisure, and our rights to adequate living standards and personal security. On the 24/05/2019, the police were called to an incident at the Rising Sun where it was discovered that the management had been operating without a proper licence. We believe this is why the Rising Sun is applying to renew and extend its licence. Another incident took place again on the 26/05/2019, which caused some residents to again call the police. Endorsing these trading hours during the weeknights will not only lead to an increase in this type of behaviours which are causing the residents unreasonable and substantial discomfort, but it will also encourage and promote the already high crime rate in the area. Please note, in the case of *East Lindsey District Council v Abu Hanif (t/a Zara's Restaurant)*(2016) Mr Justice Jay said: "[T]he prevention of crime and disorder requires a prospective consideration of what is warranted in the public interest, having regard to the twin considerations of prevention and deterrence."

Public Safety: It has been witnessed and reported by several neighbours that often crowds of drinkers outside the pub and the customers or pub staff/owners cars parked right outside the pub entrance force pedestrians to walk in the road, posing a risk to public safety.

Prevention of public nuisance: In the last year or two it has been noticed a substantial increase in the amount of noise coming from the pub; not only from music but also from people yelling, mainly on weekends but a marked increased during the week nights too. It is not only the noise from the entertainment/ band rehearsals, patrons inside and in the garden (which is adjacent to ours) that is concerning, but also from the people who regularly loiter outside the pub, often inebriated, shouting obscenities at each other which sometimes leads to physical altercations late at night. The litters, urination and bottles being left around make our neighbourhood look unpleasant, and make it less pleasant to live. We believe that the above objective will continued to be undermined if the licence is granted in the terms requested. There will be nuisance caused to residents through late night noise and anti-social behaviour. Having regard to the existing levels of alcohol-related crime and anti-social behaviour, I believe that this will be worsened if this application is granted.

Protection of children from harm: A licence to play live/recorded music or for band rehearsals during weeknights until 12.30am in a residential area will have a significant and negative impact on the well-being of the residents within a 6 house radius of the pub. For example, a neighbour 6 houses away has complained to us of how loud the music has become. Granting this licence application in the terms requested will have a detrimental effect on residents' quantity and quality of sleep, impact on the elderly as the working age residents. Moreover, granting this licence application in the terms requested will have a detrimental effect on the educational outcomes of children and young people who live in this vicinity. We have already taken measures to alleviate our concerns including wearing earplugs, turning our television sets up, etc. to no much effect. Our property already has measures in place to reduce noise i.e double glazing, etc., however the music coming from the pub is often so loud and well beyond 9pm on

weeknights that even when our windows are closed the noise makes hard for us to sleep or rest in peace and quiet. The Council must appreciate that having all windows closed to try and sleep during summer nights makes it extremely uncomfortable. The issue with the pub playing music on their premises is the lack of control to measure the maximum level of decibel allowed in a residential area. We have seen no measures that the Rising Sun are proposing to combat and reduce the noise level emanating from the live and/or recorded music it is seeking licence to play. We hence request that the local authority monitor that level of noise and/or impose conditions to the licence, if granted, including the installation of adequate sound proof barriers to reduce the noise and alleviate its effects on the residents. We also request that the Council reduce the hours during which the Rising Sun is allowed to sell alcohol and play music during weekdays to 9pm.

[REDACTED]

[REDACTED]

[REDACTED]

According to the Licencing ACT 2003, Part 2, Section 4, objectives that licencing authorities are required to promote are (a) prevention of crime and disorder (b) public safety (c) prevention of public nuisance and (d) protection of children from harm. I understand that Friday to Saturday nights are typical nights out for people, however, a licence to play music or for band rehearsals during weeknights until midnight in a residential area is inconsiderate and will have a significant and negative impact on the well being of the residents within a 6 house radius of the pub (for example a neighbour 6 houses away has complained to us of how loud the music has become). Granting this permission will have a detrimental effect on residents quatity and quality of sleep, impacting on the elderly and those of us who need to work, thus affecting our quality of life but more importantly impacting on the educational outcomes of children and young people who live in this vacinity. This application therefore breaches part C of the legislation as stated above. In the last year or two we have noticed a substantial increase in the amount of noise coming from the pub (not only music but people yelling, mainly on weekends but a marked increased during the week nights too). Our family have already taken measures to dampen the noise and music coming from the pub and we have recently installed triple glazed windows which when closed still does not provide an adequate barrier to sound and our family are still subject to this exposure well beyond 9pm on weeknights. Having all windows closed to try and sleep during summer nights makes it extremely uncomfortable. I am not only concerned about the noise from the entertainment/ band rehearsals and patrons inside and in the beer garden, but also with people who regularly loiter outside the pub, often inebriated, shouting obscenities at each other which sometimes leads to physical altercations late at night therefore, breaching The Licencing Act 2003, Part 2, Section 4, A, B and D. Endorsing these trading hours during the weeknights will not only lead to an increase in this type of behaviour causing the residents unreasonable and substantial discomfort, but it is also encouraging and promoting the already high crime rate in the area. Ourselves and our neighbours have observed people in heavily intoxicated states as well as involvement in illegal behaviour. These directly affect our basic rights to rest and leisure, our right to adequate living standards and our right to personal security. I am therefore asking Brent Council's Licencing Department to reconsider granting this licence in favor of the well being of its residents.

[REDACTED]

This page is intentionally left blank

11-07-2019

Please note that I am the owner of [REDACTED] and currently let the flat to tenants who have 2 small children. We, the affected and named residents, hereby expressed our objection to renewing Star Pubs & Bars Limited's (t/a The Rising Sun) licencing application (number 16434) made under The Licensing Act 2003 for Alcohol and Entertainment including the licence to carry out after the hours of 9pm weekdays (Mondays to Fridays) the following activities: Supply of alcohol on/off sale Recorded/Live music Indoor In carrying out its functions under the Licencing Act 2003 (the Act), Brent Council must do so with a view to promoting the licensing objectives set out under Part 2, Section 4 of the Act. We believe that a grant of the application (at least in the terms requested) is not appropriate for the promotion of the licensing objectives, which are: (a) prevention of crime and disorder (b) public safety (c) prevention of public nuisance and (d) protection of children from harm

Prevention of crime and disorder: Large numbers of inebriated pub goers have been observed, often aggressive and arguing loudly. This is a cause of great concern as a local resident. By allowing the proposed trading hours during the weeknights, this is likely to increase this type of behaviour as well as increase the likelihood of crime in the area. Public Safety: The number of cars parked right outside the pub entrance mean that pedestrians often have to walk on the road which poses a risk to safety. Prevention of public nuisance: There has been marked increase in the amount of noise coming from the pub over the last 4 years – from music and also from people shouting. I fear that if the licence is granted in the terms requested, there will be an increase in nuisance caused to residents through late night noise and anti-social behaviour. Protection of children from harm: Granting this licence application which will allow recorded and live music to be played until 12:30am in a residential area will have an extremely detrimental effect on residents' children's quantity and quality of sleep which in turn could negatively hinder their ability to perform at school. The volume at which the music is played is extremely antisocial and directly impacts being able to enjoy the garden which is adjacent to the pub.

This page is intentionally left blank

From: [REDACTED]
Sent: 10 July 2019 18:00
To: Business Licence <business.licence@brent.gov.uk>
Subject: (C003865) - Rising Sun, Willesden Green, London - 16434 (Effect on [REDACTED])

Attn: Brent Council Licensing
Attn: Ms. Vanesha Haulkhory

We agree with our neighbours. We understand that businesses want to develop but we are very, very concerned about the impact on our flats and the quality of life. This stretch of Harlesden road is quiet at night. Although we bedroom windows on the street (Harlesden Road) side, we are not bothered with traffic after 7 or 8 pm. The disturbances are only patrons of the pub next door at closing time. Also, the parking is not adequate for the pub and the vehicles block the pavement and sometimes our drive. Trash is left on our wall or thrown over the wall and there are always plentiful cigarette butts littering the area. At this time, the bother is tolerable. However, an increase in activity would greatly distress us.

We do not want to withdraw the complaint, we want to reiterate the issues. How will the parking issue be resolved? How will any noise on the street be controlled? Will the street in front of the pub and our building be cleaned? Once permission is granted, has it ever been revoked? What guarantees will the Council undertake regarding any negative impact?

We would like to avoid the inevitable problems.

Sincerely yours,

[REDACTED]

This page is intentionally left blank

07-07-2019

Dear Sir/Madam, We are living [REDACTED] and as a family with young children have material concerns with the licensing of the pub and issue our objection to the application based on the following:

- Crime: there is substance abuse and drug use occurring outside and adjacent to the premises evidenced by drug paraphernalia (small gas canisters) and the smell of cannabis. This occurs mostly in the weekend.
- Crime: there have been a number of fights breaking out outside the premise late at night, at times with police present.
- Public nuisance: regularly there is loud arguments outside our front door. And often drunk people speak on the phone with very foul language, which our children inside our homes are exposed to, which is very unpleasant.
- Public nuisance: noise levels from inside the pub (music), outside the pub garden (music and people), and from the people leaving the pub are too high.
- Public safety: cars are parked illegally in ways that make it unsafe to cross the road due to limited visibility of traffic, particularly for children. Also, the pavement is blocked as a result of this parking. Furthermore, several times access to our driveway was blocked.
- Public safety: I don't understand how the public footpath/ pavement effectively stops at the pub. With a full pub car park one has to walk on the street to get around. From my experience [REDACTED] to the requesting premises, by issuing the requested licence the council will undermine the prevention of crime and disorder, public safety, the prevention of public nuisance, the protection of children from harm.

[REDACTED]

This page is intentionally left blank

[REDACTED]
Sent: 30 June 2019 22:37

To: Business Licence <business.licence@brent.gov.uk>

Cc: Chan, Esther <Esther.Chan@brent.gov.uk>

Subject: Re: New Application Rising Sun - 25 Harlesden Road, London, Brent, NW10 2BY

Hi Vanesha

Please find my representation attached.

Can you please confirm if this will remain anonymous at the hearing? If we have to be named fine, but I'd rather know.

Just to let you know that we had further trouble with noise from the pub until the early hours of the morning. Customers were using the front and side of the pub as a smoking and drinking area, and were extremely loud. They were shouting and singing from around 10pm until 12.30am. Eventually I had to call the pub and while the noise did stop, the noise continued when the customers were leaving the pub.

Furthermore, there was a party being held in the beer garden which had a live DJ. Music was excessively loud from the mid afternoon until 11pm. We had to keep our doors shut because of the noise, as we could not hear the television. Not ideal in the middle of this hot weather.

Please let me know if you have any questions.

Thanks,
[REDACTED]

This page is intentionally left blank

To whom it may concern

Please find below our representation.

The premises licence for The Rising Sun, 25 Harlesden Road was reviewed in 2009 at the request of Brent Police Licensing Unit, on the grounds of prevention of public nuisance. The Alcohol & Entertainment Licensing Sub-Committee re-granted a licence, but outlined specific measures to prevent noise and public nuisance.

The agenda, decision & minutes can be found here

<http://democracy.brent.gov.uk/ieListDocuments.aspx?CId=134&MID=1176>

We are unclear as to whether these measures are still a requirement for the pub, but currently the pub does not do enough to prevent

- public nuisance and noise
- crime and disorder
- the safety of residents

See below for a list of incidents and ongoing issues we have faced in the last 6 months concerning customers from the pub.

- Loud noise from customers talking, shouting and singing at the front and side of the pub. This happens during the early evening through to after closing time. It is caused by customers using the front and side of the pub as smoking/drinking areas. It occurs most evenings. It is significantly worse and prolonged at weekends, including Sunday night. The disturbance goes on later at weekends because of the later opening hours.
- Customers drinking/smoking directly in front of resident's houses. Sitting on resident's garden walls.
- Glasses, bottles, cigarette butts, general litter left on the walls, hedges and in gardens.
- Customers fighting at the side of the pub (2 incidents in the past 2 months).
- When the pub gets very busy (usually at weekends) customers use the front of the pub and pavement in front of residents houses to drink. After the recent Champions League final customers took seats from inside the pub and were sitting on the pavement directly outside the entrance to our property, for most of the evening.
- The same night, a customer entered our property and urinated at the side of our house, next to our front door (11pm, Saturday 1st June).
- The same night (11.30pm, Saturday 1st June), 3 customers entered our garden at the front of the property and used our bins to use consume drugs. When approached the customers refused to leave the garden and were aggressive towards myself and my wife.
- Events held each weekend (Live music, DJs and parties) in the beer garden have excessive levels of music playing from mid-afternoon to 11pm. We should not have to keep our patio door closed (particularly in summer when it is hot) to be able to hear ourselves talk and watch television. While we expect music to be heard from time to time, every weekend for the whole afternoon and evening is unacceptable.
- The pub does not have enough commercial waste bins. Frequently the blue bin is left open (because it is overfilled) and refuse bags are left at the side of the pub. Each night bags are ripped open (presumably by foxes) and food/waste is dragged down the street and into our garden.
- Noise from customers and music played inside the pub late at night. This occurs because doors to the front and side of the pub are left open.

We urge the committee to consider residents when reviewing the licence terms. The incidents listed above cause actual nuisance, stress and have on occasions threatened the safety of residents. If the committee can set explicit conditions to prevent/mitigate such incidents, and the pub can realistically enforce these measures, we would have no objection to the licence being granted.

We would also like to specifically request that an extension to licensing hours is not granted. We feel this would exacerbate the current issues we face.

This page is intentionally left blank

From:

Sent: 09 July 2019 13:41

To: Business Licence <business.licence@brent.gov.uk>

Cc: Chan, Esther <Esther.Chan@brent.gov.uk>

Subject: Re: (C003865) - Rising Sun, Willesden Green, London - 16434

Hi Vanesha and Esther

After reviewing the licence application and conversations with yourselves and Susana, we would like to resubmit our representation which includes amendments to the original wording and suggestions to help mitigate issues. See attached.

This includes information pertaining to the licensing hours, which we would like to suggest are reduced.

Can you please confirm when this has been resubmitted?

Thanks,

This page is intentionally left blank

To whom it may concern

Please find below our representation.

The premises licence for The Rising Sun, 25 Harlesden Road was reviewed in 2009 at the request of Brent Police Licensing Unit, on the grounds of prevention of public nuisance. The Alcohol & Entertainment Licensing Sub-Committee re-granted a licence but outlined specific measures to prevent noise and public nuisance.

The agenda, decision & minutes can be found here

<http://democracy.brent.gov.uk/ieListDocuments.aspx?CId=134&MID=1176>

We are unclear as to whether these measures are still a requirement for the pub (given they do not have a licence), but currently the pub does not do enough to prevent

- public nuisance and noise
- crime and disorder
- the safety of residents

See below for a list of incidents and ongoing issues we have faced in the last 6 months concerning customers from the pub.

- Loud noise from customers talking, shouting and singing at the front and side of the pub. This happens during the early evening through to after closing time. It is caused by customers being at the front and side of the pub. It does not make a difference whether they are smoking, drinking area or doing both. It occurs most evenings during the week until late (00.30, sometimes later if the customers stay on the street after closing).
- Loud noise is significantly worse and prolonged at weekends, including Sunday night. The disturbance goes on later at weekends because of the later opening hours.
- Customers drinking/smoking directly in front of resident's houses. Sitting on resident's garden walls.
- Glasses, bottles, cigarette butts, general litter left on the walls, hedges and in gardens.
- Customers fighting at the side of the pub (2 incidents in the past 2 months). Physical violence and abusive language have made residents feel unsafe.
- When the pub gets very busy (usually at weekends) customers use the front of the pub and pavement in front of residents houses to drink. After the recent Champions League final customers took seats from inside the pub and were sitting on the pavement directly outside the entrance to our property, for most of the evening.
- The same night, a customer entered our property and urinated at the side of our house, next to our front door (11pm, Saturday 1st June).
- The same night (11.30pm, Saturday 1st June), 3 customers entered our garden at the front of the property and used our bins to use consume drugs. When approached the customers refused to leave the garden and were aggressive towards myself and my wife.
- Events held each weekend (Live music, DJs and parties) in the beer garden have excessive levels of music playing from mid-afternoon to 11pm. We should not have to keep our patio door closed (particularly in summer when it is hot) to be able to hear ourselves talk and watch television. While we expect music to be heard from time to time, every weekend for the whole afternoon and evening is unacceptable.
- The pub does not have enough commercial waste bins. Frequently the blue bin is left open (because it is overfilled) and refuse bags are left at the side of the pub. Each night bags are ripped open (presumably by foxes) and food/waste is dragged down the street and into our garden.
- Noise from customers and music played inside the pub late at night. This occurs because doors to the front and side of the pub are left open.

We would also like to make the following suggestions

- specifically request that an extension to licensing hours is not granted. We feel this would exacerbate the current issues we face.

- Licensing hours are reduced from
 - 1100-0000 to 1100-2300 in the week
 - 1100-01.00 to 1100-00.00 on Friday/Saturday
 - 1100-00.00 to 1100-2300 on Sundays.
- Stop customers from being at the front and side of the building at all times. Whether they are drinking, smoking or doing both.
- Close the beer garden at maximum 2200 during the week and Sunday. Friday and Saturday at 2300.
- Allow customers who need to smoke to use a small area of the beer garden (after beer garden closes) to do so, on the proviso that no shouting, singing or any noise occurs. Someone from the pub should be responsible to monitor the noise¹. This is preferable to the front of the premises which has the most exposure to the local residents.
- Ensure customers leave the premises quietly.
- Windows and doors to the front and side of the building be closed after 2200 to prevent noise from inside the pub.
- No live music or DJs in the beer garden.
- Additional commercial waste bin, both kept at the side of the premises and clear of the public paths.

We urge the committee to consider residents when reviewing the licence terms. The incidents listed above cause nuisance, stress and on occasions have threatened the safety of residents. If the committee can set explicit conditions to prevent/mitigate such incidents, and the pub can realistically enforce these measures, we would have no objection to the licence being granted.

¹ The beer garden as a smoking area is preferred to the front of the premises, as it has the minimum exposure to residents. The beer garden is surrounded by the pub to the front and side, and a fence runs directly behind the beer garden.

From:

Sent: 11 July 2019 21:25

To: Business Licence <business.licence@brent.gov.uk>

Cc: Chan, Esther <Esther.Chan@brent.gov.uk>

Subject: Re: (C003865) - Rising Sun, Willesden Green, London - 16434

Hi Vanesha

I have revised my representation again and removed the bit about the licence extension. Can you please submit this?

Thanks,

This page is intentionally left blank

To whom it may concern

Please find below our representation.

The premises licence for The Rising Sun, 25 Harlesden Road was reviewed in 2009 at the request of Brent Police Licensing Unit, on the grounds of prevention of public nuisance. The Alcohol & Entertainment Licensing Sub-Committee re-granted a licence but outlined specific measures to prevent noise and public nuisance.

The agenda, decision & minutes can be found here

<http://democracy.brent.gov.uk/ieListDocuments.aspx?CId=134&MID=1176>

We are unclear as to whether these measures are still a requirement for the pub (given they do not have a licence), but currently the pub does not do enough to prevent

- public nuisance and noise
- crime and disorder
- the safety of residents

See below for a list of incidents and ongoing issues we have faced in the last 6 months concerning customers from the pub.

- Loud noise from customers talking, shouting and singing at the front and side of the pub. This happens during the early evening through to after closing time. It is caused by customers being at the front and side of the pub. It does not make a difference whether they are smoking, drinking area or doing both. It occurs most evenings during the week until late (00.30, sometimes later if the customers stay on the street after closing).
- Loud noise is significantly worse and prolonged at weekends, including Sunday night. The disturbance goes on later at weekends because of the later opening hours.
- Customers drinking/smoking directly in front of resident's houses. Sitting on resident's garden walls.
- Glasses, bottles, cigarette butts, general litter left on the walls, hedges and in gardens.
- Customers fighting at the side of the pub (2 incidents in the past 2 months). Physical violence and abusive language have made residents feel unsafe.
- When the pub gets very busy (usually at weekends) customers use the front of the pub and pavement in front of residents houses to drink. After the recent Champions League final customers took seats from inside the pub and were sitting on the pavement directly outside the entrance to our property, for most of the evening.
- The same night, a customer entered our property and urinated at the side of our house, next to our front door (11pm, Saturday 1st June).
- The same night (11.30pm, Saturday 1st June), 3 customers entered our garden at the front of the property and used our bins to use consume drugs. When approached the customers refused to leave the garden and were aggressive towards myself and my wife.
- Events held each weekend (Live music, DJs and parties) in the beer garden have excessive levels of music playing from mid-afternoon to 11pm. We should not have to keep our patio door closed (particularly in summer when it is hot) to be able to hear ourselves talk and watch television. While we expect music to be heard from time to time, every weekend for the whole afternoon and evening is unacceptable.
- The pub does not have enough commercial waste bins. Frequently the blue bin is left open (because it is overfilled) and refuse bags are left at the side of the pub. Each night bags are ripped open (presumably by foxes) and food/waste is dragged down the street and into our garden.
- Noise from customers and music played inside the pub late at night. This occurs because doors to the front and side of the pub are left open.

We would also like to make the following suggestions

- Licensing hours are reduced from
 - 1100-0000 to 1100-2300 in the week

- 1100-01.00 to 1100-00.00 on Friday/Saturday
- 1100-00.00 to 1100-2300 on Sundays.
- Stop customers from being at the front and side of the building at all times. Whether they are drinking, smoking or doing both.
- Close the beer garden at maximum 2200 during the week and Sunday. Friday and Saturday at 2300.
- Allow customers who need to smoke to use a small area of the beer garden (after beer garden closes) to do so, on the proviso that no shouting, singing or any noise occurs. Someone from the pub should be responsible to monitor the noise¹. This is preferable to the front of the premises which has the most exposure to the local residents.
- Ensure customers leave the premises quietly.
- Windows and doors to the front and side of the building be closed after 2200 to prevent noise from inside the pub.
- No live music or DJs in the beer garden.
- No live or amplified music from 2100 hours inside the pub on weeknights. This can sometimes be heard from the pub despite the windows being closed.
- Additional commercial waste bin, both kept at the side of the premises and clear of the public paths.

We urge the committee to consider residents when reviewing the licence terms. The incidents listed above cause nuisance, stress and on occasions have threatened the safety of residents. If the committee can set explicit conditions to prevent/mitigate such incidents, and the pub can realistically enforce these measures, we would have no objection to the licence being granted.

¹ The beer garden as a smoking area is preferred to the front of the premises, as it has the minimum exposure to residents. The beer garden is surrounded by the pub to the front and side, and a greenhouse directly behind the beer garden.

Agent Response to Objectors

From: Nikki Rennie **On Behalf Of** Andrew Cochrane
Sent: 08 July 2019 10:01
To: Business Licence <business.licence@brent.gov.uk>
Subject: (C003865) - Rising Sun, Willesden Green, London

Dear Vanesha

Thank you for sending through further representations.

It seems that quite a few of these representations seem to think that we are trying to extend hours at the premises however this is not the case.

We cannot contact the residents direct as all their address information is redacted. Is there any way in which this fact can be communicated to the objectors?

Best wishes

Andrew

.....

Objector Response

Sent: 08 July 2019 13:12
To: Business Licence <business.licence@brent.gov.uk>
Subject: Re: FW: (C003865) - Rising Sun, Willesden Green, London - 16434

I do not feel my objection has been addressed

The application states that serving of alcohol is to be extended by 30 minutes from 11p. To

11

30pm

Also,

What about the playing of loud music outside which they don't currently have a licence for

.....

Objector Response

Sent: 08 July 2019 13:45
To: Business Licence <business.licence@brent.gov.uk>
Subject: Re: (C003865) - Rising Sun, Willesden Green, London - 16434

Many thanks for your email.

My objection was allowing the noise-loud music and band rehearsals to occur on weeknights beyond 9pm when there are elderly, children and working residents who need to sleep. Also, patrons behaving unruly late into the evenings and attracting criminal activity.

Thanks,

This page is intentionally left blank

From: ENS Public Safety
Sent: 05 July 2019 14:07
To: Andrew Cochrane <>; ENS Public Safety <ens.publicsafety@brent.gov.uk>
Cc: Legister, Linda <Linda.Legister@brent.gov.uk>; Business Licence <business.licence@brent.gov.uk>
Subject: RE: CONSULT: New Premises - Rising Sun, 25 Harlesden Road, Willesden Green, NW10 2BY - 16434

Dear Mr Cochrane,

Thank you for your correspondence dated 3rd July 2019, stating that you accept the conditions set out in our representation.

I would like to withdraw condition 2 as it replicates condition 3.

I confirm that the Public Safety Team now withdraw the current representation and do not make any further representations regarding the application.

We will require the agreed conditions to appear on the licence schedule.

Kind regards

Mr Chris Pearce
Public Safety Officer

From: Nikki Rennie [<mailto:nikki.ennie@flintbishop.co.uk>] **On Behalf Of** Andrew Cochrane
Sent: 03 July 2019 16:42
To: ENS Public Safety
Cc: Legister, Linda ; Business Licence
Subject: RE: CONSULT: New Premises - Rising Sun, 25 Harlesden Road, Willesden Green, NW10 2BY - 16434

Dear Sirs

We refer to your below mentioned conditions 1 – 6 and we can confirm that these are acceptable to our client.

We would be grateful if you could confirm that your representation will be withdrawn.

We thank you for your assistance in this matter.

Yours faithfully

Andrew Cochrane
Chairman and Senior Partner
Head of Licensing



From: ENS Public Safety <ens.publicsafety@brent.gov.uk>

Sent: 27 June 2019 12:17

To: Andrew Cochrane <Legister, Linda <Linda.Legister@brent.gov.uk>; Business Licence <business.licence@brent.gov.uk>

Subject: FW: CONSULT: New Premises - Rising Sun, 25 Harlesden Road, Willesden Green, NW10 2BY - 16434

Dear Mr Cochrane

I refer to the application for a new licence for the above named premises. After assessing the application, the Public Safety Team will be making the following representations to the Licensing Authority on the grounds of Public Safety.

Providing the licensee is willing to accept the following conditions Public Safety Team would withdraw the representation.

1. The locks and flush latches on the exit doors shall be unlocked and kept free from fastenings other than push bars or pads whilst the public are on the premises.
- ~~2. A residual current device (RCD), having a rated residual operating current not exceeding 30 milliamps, shall be provided to any socket or power supplies to be used for temporary stage, band or disco equipment, likely to be accessible to performers, staff or public.~~
3. Any socket outlets (or other power supplies used for DJ equipment, band equipment and other portable equipment) that are accessible to performers, staff or the public shall be suitably protected by a residual current device (RCD having a rated residual operating current not exceeding 30 milliamps).
4. No person shall be permitted to sit on the floor, on stairs or in gangways and passageways.
5. All roller shutters that are operational as exit points must be fixed/locked up in the open position whilst the public/staff are on the premises.
6. A capacity specific risk assessment shall be conducted by a professionally qualified risk assessor. This assessment will include holding capacity, exit capacity and the calculations to demonstrate how that was reached, the lower of the two numbers shall be the final capacity. The guidance used to reach this capacity must be quoted. This risk assessment shall be appraised annually or at the time of any building or layout structural works.

In order for the Public Safety Team to withdraw this representation, it will be necessary for you or your client to **confirm in writing or via Email** that you accept the above licence conditions.

We will require these conditions to appear on the licence schedule should the licence be granted.

Please let me know if I can assist you further.

Kind regards

Mr Chris Pearce
Public Safety Officer

Rising Sun 25 Harlesden Road NW10

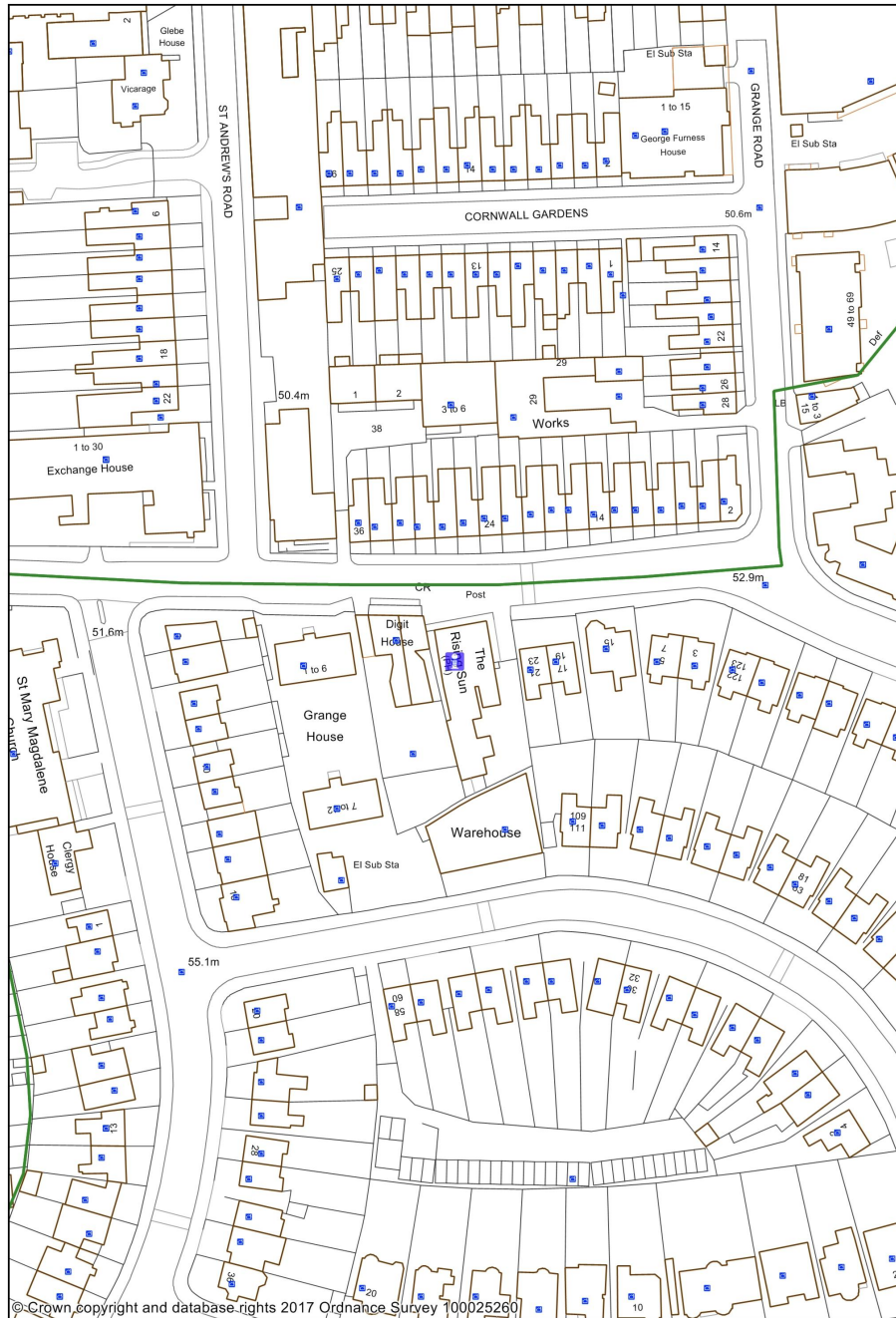

1:1250

0 0.02 0.04 kilometres



Brent

This page is intentionally left blank