



Alcohol and Entertainment Licensing Sub-Committee

Tuesday 12 March 2019 at 11.00 am
Pace Room, Ground Floor, Brent Civic Centre

Membership:

Members

Councillors:

Ahmed (Chair)

Hector

Maurice

Substitute Members

Councillors:

Allie, Chohan, Kennelly, Long, McLeish, Mitchell

Murray and RS Patel

For further information contact: Devbai Bhanji, Governance Assistant
Tel: 020 8937 4011; Email: devbai.bhanji@brent.gov.uk

For electronic copies of minutes, reports and agendas, and to be alerted when the minutes of this meeting have been published visit:
www.brent.gov.uk/committees

The press and public are welcome to attend this meeting

Notes for Members - Declarations of Interest:

If a Member is aware they have a Disclosable Pecuniary Interest* in an item of business, they must declare its existence and nature at the start of the meeting or when it becomes apparent and must leave the room without participating in discussion of the item.

If a Member is aware they have a Personal Interest** in an item of business, they must declare its existence and nature at the start of the meeting or when it becomes apparent.

If the Personal Interest is also significant enough to affect your judgement of a public interest and either it affects a financial position or relates to a regulatory matter then after disclosing the interest to the meeting the Member must leave the room without participating in discussion of the item, except that they may first make representations, answer questions or give evidence relating to the matter, provided that the public are allowed to attend the meeting for those purposes.

***Disclosable Pecuniary Interests:**

- (a) **Employment, etc.** - Any employment, office, trade, profession or vocation carried on for profit gain.
- (b) **Sponsorship** - Any payment or other financial benefit in respect of expenses in carrying out duties as a member, or of election; including from a trade union.
- (c) **Contracts** - Any current contract for goods, services or works, between the Councillors or their partner (or a body in which one has a beneficial interest) and the council.
- (d) **Land** - Any beneficial interest in land which is within the council's area.
- (e) **Licences** - Any licence to occupy land in the council's area for a month or longer.
- (f) **Corporate tenancies** - Any tenancy between the council and a body in which the Councillor or their partner have a beneficial interest.
- (g) **Securities** - Any beneficial interest in securities of a body which has a place of business or land in the council's area, if the total nominal value of the securities exceeds £25,000 or one hundredth of the total issued share capital of that body or of any one class of its issued share capital.

****Personal Interests:**

The business relates to or affects:

- (a) Anybody of which you are a member or in a position of general control or management, and:
 - To which you are appointed by the council;
 - which exercises functions of a public nature;
 - which is directed is to charitable purposes;
 - whose principal purposes include the influence of public opinion or policy (including a political party or trade union).
- (b) The interests of a person from whom you have received gifts or hospitality of at least £50 as a member in the municipal year;

or

A decision in relation to that business might reasonably be regarded as affecting the well-being or financial position of:

- You yourself;
- a member of your family or your friend or any person with whom you have a close association or any person or body who is the subject of a registrable personal interest.

Agenda

Introductions, if appropriate.

Item	Page
------	------

1	Apologies for absence and clarification of alternate members
---	---

2	Declarations of Interests
---	----------------------------------

Members are invited to declare at this stage of the meeting, the nature and existence of any relevant disclosable pecuniary or personal interests in the items on this agenda and to specify the item(s) to which they relate.

3	Application for a New Premises Licence by Co-operative Group Food Limited for the premises known as Co-op, 164 Watford Road, Wembley, HA0 3HB , pursuant to the provisions of the Licensing Act 2003	1 - 32
---	---	--------



- Please remember to **SWITCH OFF** your mobile phone during the meeting.
- The meeting room is accessible by lift and seats will be provided for members of the public.

This page is intentionally left blank

LICENSING ACT 2003

Application for New Premises Licence

1. The Application

Name of Applicant:	Co-operative Group Food Limited
Name & Address of Premises:	Co-op 164 Watford Road, Wembley, HA0 3HB
Applicants Agent:	Richard Arnot – Ward Hadaway

The application is for a new premises licence:

- 1 For the Sale & Supply of Alcohol and to remain open from 06:00hrs to 23:00hrs Monday to Sunday.

2. Background

None

3. Promotion of the Licensing Objectives

See page 8 & 9 of the application.

4. Relevant Representations

Representations have been received from the Police and Licensing Officers and local residents

5. Interested Parties

None

6. Policy Considerations

Paragraph Nos: 7.2 8.1 – 8.4

8.1 Where responsible authorities and interested parties do not raise any relevant representations regarding the application made to the council, the council will grant the licence or certificate subject only to the conditions that are consistent with the operating schedule or club operating schedule and any mandatory conditions prescribed in the Act itself.

8.2 Where responsible authorities and interested parties raise relevant representations, the council may, if it is satisfied at a hearing or otherwise, impose conditions where considered necessary for the promotion of the licensing objectives.

8.3 Any conditions attached by the council or submitted by the applicant must focus on the direct impact of the activities taking place at licensed premises, on those attending the premises and residents and persons working in the area.

8.4 Any conditions attached to licences will be tailored to the individual needs, style and characteristics of the particular premises and events concerned and will be drawn from a 'model pool of conditions' (where appropriate) to the particular premises.

7. Determination of the Application

Members can take the following steps when determining a new premises licence application:

- grant the licence;
- exclude from the scope of the licence any of the licensable activities to which the application relates;
- refuse to specify a person in the licence as the premises supervisor;
- reject the application

8. Associated Papers

- A. Copy of Application Form & Premises Plan
- B. Police Representation
- C. Licensing Representations
- D. Residents Representations
- E. OS Map

**Application for a premises licence to be granted
under the Licensing Act 2003**

PLEASE READ THE FOLLOWING INSTRUCTIONS FIRST

Before completing this form please read the guidance notes at the end of the form. If you are completing this form by hand please write legibly in block capitals. In all cases ensure that your answers are inside the boxes and written in black ink. Use additional sheets if necessary.

You may wish to keep a copy of the completed form for your records.

I/We Co-operative Group Food Limited

(Insert name(s) of applicant)

apply for a premises licence under section 17 of the Licensing Act 2003 for the premises described in Part 1 below (the premises) and I/we are making this application to you as the relevant licensing authority in accordance with section 12 of the Licensing Act 2003

Part 1 – Premises details

Postal address of premises or, if none, ordnance survey map reference or description Co-op 164 Watford Road Wembley			
Post town	London	Postcode	HA0 3HB
Telephone number at premises (if any)			
Non-domestic rateable value of premises		£32,250	

Part 2 - Applicant details

Please state whether you are applying for a premises licence as Please tick as appropriate

- | | | |
|--|-------------------------------------|-----------------------------|
| a) an individual or individuals * | <input type="checkbox"/> | please complete section (A) |
| b) a person other than an individual * | | |
| i as a limited company/limited liability partnership | <input checked="" type="checkbox"/> | please complete section (B) |
| ii as a partnership (other than limited liability) | <input type="checkbox"/> | please complete section (B) |
| iii as an unincorporated association or | <input type="checkbox"/> | please complete section (B) |
| iv other (for example a statutory corporation) | <input type="checkbox"/> | please complete section (B) |
| c) a recognised club | <input type="checkbox"/> | please complete section (B) |
| d) a charity | <input type="checkbox"/> | please complete section (B) |

- e) the proprietor of an educational establishment ☐ please complete section (B)
- f) a health service body ☐ please complete section (B)
- g) a person who is registered under Part 2 of the Care Standards Act 2000 (c14) in respect of an independent hospital in Wales ☐ please complete section (B)
- ga) a person who is registered under Chapter 2 of Part 1 of the Health and Social Care Act 2008 (within the meaning of that Part) in an independent hospital in England ☐ please complete section (B)
- h) the chief officer of police of a police force in England and Wales ☐ please complete section (B)

* If you are applying as a person described in (a) or (b) please confirm (by ticking yes to one box below):

I am carrying on or proposing to carry on a business which involves the use of the premises for licensable activities; or ☒

I am making the application pursuant to a
 statutory function or ☐
 a function discharged by virtue of Her Majesty's prerogative ☐

(A) INDIVIDUAL APPLICANTS (fill in as applicable)

Mr <input type="checkbox"/>	Mrs <input type="checkbox"/>	Miss <input type="checkbox"/>	Ms <input type="checkbox"/>	Other Title (for example, Rev)	
Surname			First names		
Date of birth		I am 18 years old or over <input type="checkbox"/>		Please tick yes	
Nationality					
Current residential address if different from premises address					
Post town				Postcode	
Daytime contact telephone number					
E-mail address (optional)					

SECOND INDIVIDUAL APPLICANT (if applicable)

Mr <input type="checkbox"/>	Mrs <input type="checkbox"/>	Miss <input type="checkbox"/>	Ms <input type="checkbox"/>	Other Title (for example, Rev)	
Surname			First names		

Date of birth		I am 18 years old or over <input type="checkbox"/> Please tick yes	
Nationality			
Current postal address if different from premises address			
Post town		Postcode	
Daytime contact telephone number			
E-mail address (optional)			

(B) OTHER APPLICANTS

Please provide name and registered address of applicant in full. Where appropriate please give any registered number. In the case of a partnership or other joint venture (other than a body corporate), please give the name and address of each party concerned.

Name Co-operative Group Food Limited
Address Dept 10227 1 Angel Square Manchester M60 0AG
Registered number (where applicable) [REDACTED]
Description of applicant (for example, partnership, company, unincorporated association etc.) Company
Telephone number (if any) [REDACTED]
E-mail address (optional) [REDACTED]

Part 3 Operating Schedule

When do you want the premises licence to start?

DD	MM	YYYY
<input type="text"/>	<input type="text"/>	<input type="text"/>

If you wish the licence to be valid only for a limited period, when do you want it to end?

DD		MM		YYYY			

Please give a general description of the premises (please read guidance note 1)
Convenience store open seven days a week, selling groceries, sundry items and alcohol for consumption off the premises

If 5,000 or more people are expected to attend the premises at any one time, please state the number expected to attend.

What licensable activities do you intend to carry on from the premises?

(please see sections 1 and 14 and Schedules 1 and 2 to the Licensing Act 2003)

Provision of regulated entertainment (please read guidance note 2)

Please tick all that apply

- a) plays (if ticking yes, fill in box A) ☐
- b) films (if ticking yes, fill in box B) ☐
- c) indoor sporting events (if ticking yes, fill in box C) ☐
- d) boxing or wrestling entertainment (if ticking yes, fill in box D) ☐
- e) live music (if ticking yes, fill in box E) ☐
- f) recorded music (if ticking yes, fill in box F) ☐
- g) performances of dance (if ticking yes, fill in box G) ☐
- h) anything of a similar description to that falling within (e), (f) or (g) (if ticking yes, fill in box H) ☐

Provision of late night refreshment (if ticking yes, fill in box I)

☐

Supply of alcohol (if ticking yes, fill in box J)

☒

In all cases complete boxes K, L and M

I

Late night refreshment Standard days and timings (please read guidance note 7)			Will the provision of late night refreshment take place indoors or outdoors or both – please tick (please read guidance note 3)	Indoors	<input type="checkbox"/>
				Outdoors	<input type="checkbox"/>
				Both	<input type="checkbox"/>
Day	Start	Finish			
Mon			<u>Please give further details here</u> (please read guidance note 4)		
Tue					
Wed			<u>State any seasonal variations for the provision of late night refreshment</u> (please read guidance note 5)		
Thur					
Fri			<u>Non standard timings. Where you intend to use the premises for the provision of late night refreshment at different times, to those listed in the column on the left, please list</u> (please read guidance note 6)		
Sat					
Sun					

J

Supply of alcohol Standard days and timings (please read guidance note 7)			Will the supply of alcohol be for consumption – please tick (please read guidance note 8)	On the premises	<input type="checkbox"/>
				Off the premises	<input checked="" type="checkbox"/>
				Both	<input type="checkbox"/>
Day	Start	Finish	State any seasonal variations for the supply of alcohol (please read guidance note 5)		
Mon	06:00	23:00			
Tue	06:00	23:00			
Wed	06:00	23:00			
Thur	06:00	23:00			
Fri	06:00	23:00	Non standard timings. Where you intend to use the premises for the supply of alcohol at different times to those listed in the column on the left, please list (please read guidance note 6)		
Sat	06:00	23:00			
Sun	06:00	23:00			

State the name and details of the individual whom you wish to specify on the licence as designated premises supervisor (Please see declaration about the entitlement to work in the checklist at the end of the form):

Name Rajendiran Raman	
Date of birth [REDACTED]	
Address [REDACTED] [REDACTED]	
Postcode	[REDACTED]
Personal licence number (if known) [REDACTED]	
Issuing licensing authority (if known) [REDACTED]	

□□□□

K

Please highlight any adult entertainment or services, activities, other entertainment or matters ancillary to the use of the premises that may give rise to concern in respect of children (please read guidance note 9).
NONE

L

Hours premises are open to the public Standard days and timings (please read guidance note 7)			State any seasonal variations (please read guidance note 5)
Day	Start	Finish	
Mon	06:00	23:00	Non standard timings. Where you intend the premises to be open to the public at different times from those listed in the column on the left, please list (please read guidance note 6)
Tue	06:00	23:00	
Wed	06:00	23:00	
Thur	06:00	23:00	
Fri	06:00	23:00	
Sat	06:00	23:00	
Sun	06:00	23:00	

M Describe the steps you intend to take to promote the four licensing objectives:

a) General – all four licensing objectives (b, c, d and e) (please read guidance note 10)

The applicant has given thought to the potential impact of the grant of this application on the four licensing objectives and, having regard to the locality, considers that the following conditions are appropriate.

b) The prevention of crime and disorder

1. The premises shall maintain a CCTV system which gives coverage of all entry and exit points. The system shall continually record whilst the premises are open and conducting licensable activities. All recordings shall be stored for a minimum period of 28 days and shall be capable of being easily downloaded. Recordings shall be made available upon the receipt of a request by an authorised Officer of the Police or the Local Authority.
2. There shall be "CCTV in Operation" signs prominently displayed at the premises.
3. An incident log (whether kept in a written or electronic form) shall be retained at the premises and made available to an authorised Officer of the Police or the Local Authority.
4. The premises shall operate a proof of age scheme, such as a Challenge 25, whereby the only forms of acceptable identification shall be either a photographic driving licence, a valid passport, military identification or any other recognised form of photographic identification incorporating the PASS logo, or any other form of identification from time to time approved by the secretary of the state.
5. The premises will be fitted with a burglar alarm system
6. The premises will be fitted with a panic button system for staff to utilise in the case of an emergency.

c) Public safety

The premises licence holder shall ensure that the appropriate fire safety, and health and safety regulations are applied at the premises.

d) The prevention of public nuisance

A complaints procedure will be maintained, details of which will be made available in store and upon request.

e) The protection of children from harm

1. All staff will receive comprehensive training in relation to age restricted products and in particular the sale of alcohol. No member of staff will be permitted to sell age restricted products until such time as they have successfully completed the aforementioned training.
2. An age till prompt system will be utilised at the premises in respect of age restricted products.
3. A refusals register (whether kept and written or electronic form) will be maintained at the premises and will be made available for inspection upon request by an authorised Officer of the Police or the Local Authority

Checklist:

Please tick to indicate agreement

- I have made or enclosed payment of the fee. ☒
- I have enclosed the plan of the premises. ☒
- I have sent copies of this application and the plan to responsible authorities and others where applicable. ☒
- I have enclosed the consent form completed by the individual I wish to be designated premises supervisor, if applicable. ☒
- I understand that I must now advertise my application. ☒
- I understand that if I do not comply with the above requirements my application will be rejected. ☒
- ☐
[Applicable to all individual applicants, including those in a partnership which is not a limited liability partnership, but not companies or limited liability partnerships] I have included documents demonstrating my entitlement to work in the United Kingdom (please read note 15).

IT IS AN OFFENCE, UNDER SECTION 158 OF THE LICENSING ACT 2003, TO MAKE A FALSE STATEMENT IN OR IN CONNECTION WITH THIS APPLICATION. THOSE WHO MAKE A FALSE STATEMENT MAY BE LIABLE ON SUMMARY CONVICTION TO A FINE OF ANY AMOUNT.

IT IS AN OFFENCE UNDER SECTION 24B OF THE IMMIGRATION ACT 1971 FOR A PERSON TO WORK WHEN THEY KNOW, OR HAVE REASONABLE CAUSE TO BELIEVE, THAT THEY ARE DISQUALIFIED FROM DOING SO BY REASON OF THEIR IMMIGRATION STATUS. THOSE WHO EMPLOY AN ADULT WITHOUT LEAVE OR WHO IS SUBJECT TO CONDITIONS AS TO EMPLOYMENT WILL BE LIABLE TO A CIVIL PENALTY UNDER SECTION 15 OF THE IMMIGRATION, ASYLUM AND NATIONALITY ACT 2006 AND PURSUANT TO SECTION 21 OF THE SAME ACT, WILL BE COMMITTING AN OFFENCE WHERE THEY DO SO IN THE KNOWLEDGE, OR WITH REASONABLE CAUSE TO BELIEVE, THAT THE EMPLOYEE IS DISQUALIFIED.

Part 4 – Signatures (please read guidance note 11)

Signature of applicant or applicant's solicitor or other duly authorised agent (see guidance note 12). If signing on behalf of the applicant, please state in what capacity.

Declaration	<ul style="list-style-type: none">• [Applicable to individual applicants only, including those in a partnership which is not a limited liability partnership] I understand I am not entitled to be issued with a licence if I do not have the entitlement to live and work in the UK (or if I am subject to a condition preventing me from doing work relating to the carrying on of a licensable activity) and that my licence will become invalid if I cease to be entitled to live and work in the UK (please read guidance note 15).• The DPS named in this application form is entitled to work in the UK (and is not subject to conditions preventing him or her from doing work relating to a licensable activity) and I have seen a copy of his or her proof of entitlement to work, if appropriate (please see note 15)
Signature	<i>Ward Hadaway</i>
Date	18 December 2018
Capacity	Solicitors for the Applicant

For joint applications, signature of 2nd applicant or 2nd applicant's solicitor or other authorised agent (please read guidance note 13). If signing on behalf of the applicant, please state in what capacity.

Signature	
Date	
Capacity	

Contact name (where not previously given) and postal address for correspondence associated with this application (please read guidance note 14) Mrs Cheryl Scott Ward Hadaway Sandgate House 102 Quayside			
Post town	Newcastle upon Tyne	Postcode	NE1 3DX
Telephone number (if any)	[REDACTED]		
If you would prefer us to correspond with you by e-mail, your e-mail address (optional) [REDACTED]			

No

SHOP FLOOR - 1:50

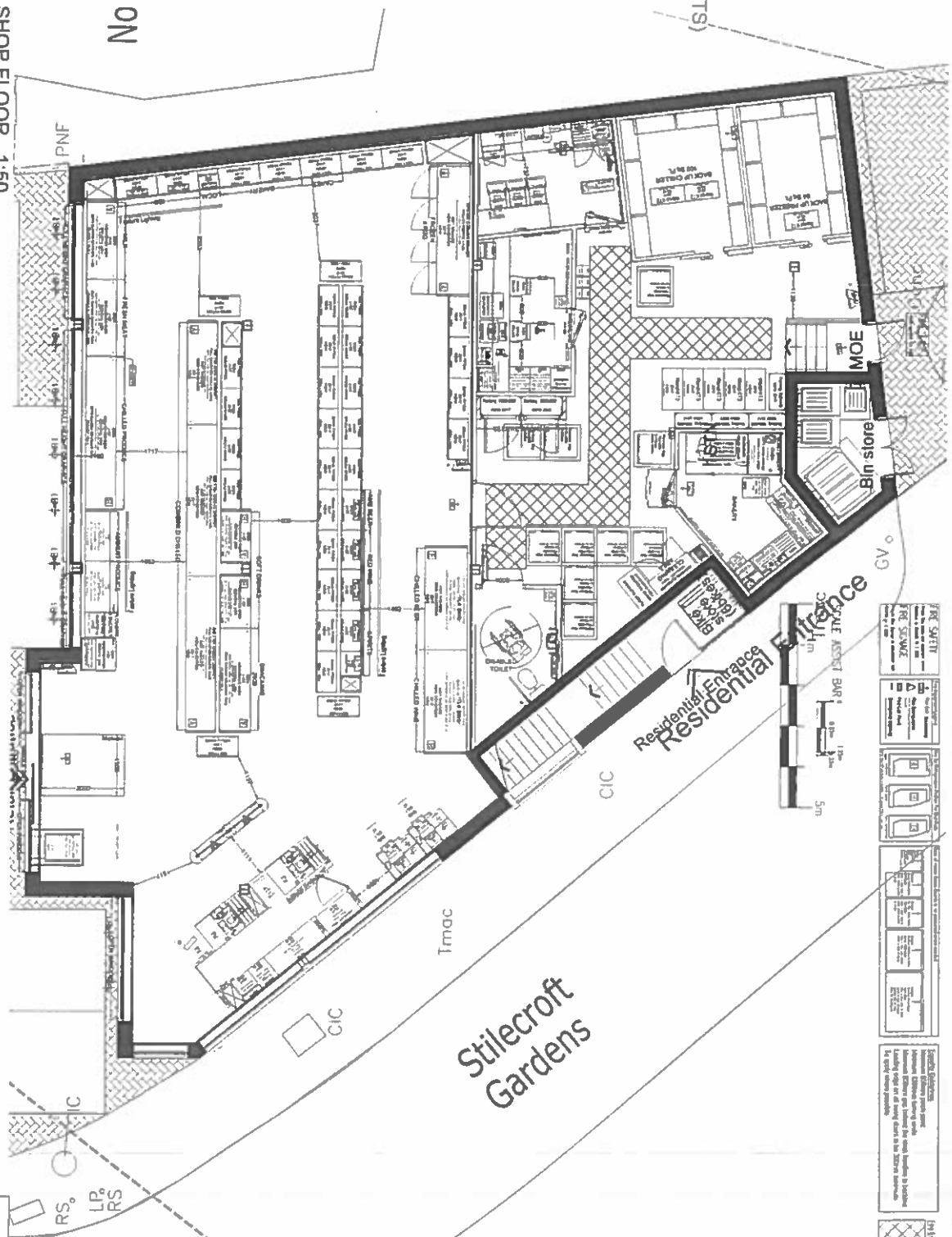
[illegible][illegible]

This page is intentionally left blank



**METROPOLITAN
POLICE**

Working together for a safer London

TERRITORIAL POLICING

Brent Police Licensing Unit

*Brent Civic Centre
Engineers Way
Wembley
Middlesex
HA9 0FJ*

Your ref: 14462

Our ref: 01QK/41/19/lic/2157

**Brent Borough Licensing
NW CU**

*South Harrow Police Station
74 Northolt Road
South Harrow
HA2 0DN*

Tel: 020 8733 4530

Email:

NWmailbox.licensingbrent@met.police.uk

Web: www.met.police.uk

Date: 4th Feb 2019

Police representation to the Premises Licence application for 'Co-operative Group Food Ltd', 174 Watford Road, Wembley, HA0 3HB.

I certify that I have considered the application shown above and **I wish to make representations** that the likely effect of the grant of the application is detrimental to the Council's Licensing Objectives for the reasons indicated below.

I am of the opinion that the risk to the Council's objectives can be mitigated by removing the requested variations or attaching conditions to the Licence as shown below.

If these conditions were accepted in full **I would** withdraw my representation.

Officer: **Nicola McDonald**
Licensing Constable PC 157QK

An officer of the Metropolitan Police, in whose area the premises are situated, who is authorised for the purposes of exercising its statutory function as a 'Responsible Authority' under the Licensing Act 2003.

The application has been made for a premises licence under section 17 of the act.

The Police representations are primarily concerned with crime and disorder and protection of children.

The location of this shop is in a predominantly residential area with a primary school opposite.

Because of this Police request that sales of alcohol do not start until 0900 hours when the pedestrian traffic of young impressionable children has ceased. Between the hours of 0600 to 0900 hours Police request that either the alcohol is out of display behind lockable shutters or the area coned off and the electronic till system prevents alcohol sales taking place.

Police require the following points should be included in the operating schedule or added as conditions in annex 2 of the premises licence.

CCTV shall be installed to Home Office Guidance standards and maintained in a good working condition and recordings shall be kept for 31 days and shall be made available to police and authorised Officers from Brent Council upon request.

CCTV cameras shall be installed to cover the entrance of the premises.

The CCTV system shall be capable of obtaining clear facial recognition images and a clear head and shoulders image of every person entering or leaving the premises.

A copy of the premises licence summary including the hours which licensable activities are permitted shall be visible from the outside the entrance to the premises.

No high strength beers, lagers, and ciders above 6.0% ABV shall be stocked or sold.

A "Challenge 25" policy shall be adopted and adhered to.

A sign stating "No proof of age – No sale" shall be displayed at the point of sale.

A suitable intruder alarm complete with panic button shall be fitted and maintained.

Any staff directly involved in selling alcohol for retail to consumers, staff who provide training and all managers will undergo regular training of Licensing Act 2003 legislation. This will be documented and signed for by the DPS and the member of staff receiving the training. This training log shall be kept on the premises and made available for inspection by police and relevant authorities upon request.

An incident log shall be kept at the premises, and made available for inspection on request to an authorised officer of Brent Council or the Police, which will record the following:

All crime reported to the venue

Any complaints received

Any faults in the CCTV system

Any refusal of the sale of alcohol

Any visit by a relevant authority or emergency service.

Yours Sincerely,

Nicola McDonald PC 157QK
Licensing Constable Brent Police

Co-operative Group Food Limited
164 Watford Road
Wembley
HA0 3HB

4 February 2019

Our Ref: 14462

Dear Sir/Madam,

Licensing Representation to the Initial Application for the Premises Licence at Co-op, 164 Watford Road, Wembley, HA0 3HB

I certify that I have considered the application shown above and I wish to make a representation that the likely effect of the grant of the application is detrimental to the Licensing Objectives for the reasons indicated below.

An officer of the Licensing Authority, in whose area the premises are situated, who is authorised for the purposes of exercising its statutory function as a 'Responsible Authority' under the Licensing Act 2003.

The application has been made for a new premises licence under section 17 of the Act.

The Licensing Authority representations are primarily concerned with the four licensing objectives;

- the prevention of crime and disorder;
- public safety;
- the prevention of public nuisance; and
- the protection of children from harm.

Timings

The area in which this premises is positioned is in close proximity to a primary school. In the interest of protecting children from harm, I would request that the following hours be modified:-

Supply of Alcohol

Monday- Sunday 06.00hrs-23.00hrs

This should be amended to:-

Monday-Sunday 09.00hrs – 23.00hrs

Conditions to be added to the Premises Licence

1. A CCTV system shall be installed and maintained in a good working order at the premises.

2. CCTV cameras shall be installed to cover the entrance of the premises.
3. CCTV recordings shall be kept for 31 days and shall be made available to the police or an authorised officer of Brent Council upon request. The CCTV images shall be kept in an easily downloadable format
4. The CCTV system shall be capable of obtaining clear facial recognition images and a clear head and shoulders image of every person entering or leaving the premises.
5. The CCTV images shall be kept in an easily downloadable format.
6. An age verification scheme, such as Challenge 25, shall be implemented at the premises. The only forms of identification which shall be acceptable for the purposes of identification shall be a valid passport, UK driving licence, any form of identification incorporating the PASS logo, military identification or any other form of identification from time to time approved by the Secretary of State.
7. An age till prompt system shall be utilised at the premises in respect of age restricted products.
8. A summary of the premises licence including the hours which licensable activities are permitted shall be visible from the outside of each entrance to the premises.
9. Any staff directly involved in selling alcohol for retail to consumers and staff who provide training including managers shall undergo regular training of the Licensing Act 2003 legislation (at least every 12 months). The training shall be documented and signed off by the DPS and the member of staff receiving the training. This training log shall be kept centrally and made available for inspection by police and relevant authorities upon request.
10. Outside of the hours authorised for the sale of alcohol, all alcohol within the trading area is to be secured behind locked grills, locked screens or locked cabinet doors so as to prevent access to the alcohol by customers.
11. A sign stating "No proof of age - No sale" shall be displayed at the point of sale.
12. An incident log shall be kept at the premises, and made available for inspection on request to an authorised officer of Brent Council or the Police, which will record the following:
 - a) All crime reported to the venue
 - b) Any complaints received in respect of the sale and consumption of alcohol
 - c) Any faults in the CCTV system
 - d) Any refusal of the sale of alcohol
 - e) Any visit by a relevant authority or emergency service.
13. No high strength beers, lagers, and ciders above 6.0% ABV shall be stocked.
14. A suitable intruder alarm complete with panic button shall be fitted and maintained.

In order for the Licensing Authority to withdraw this representation, it will be necessary for you to confirm that you accept the above conditions in writing.

Yours faithfully



Susana Figueiredo
Licensing Inspector
Planning, Transportation & Licensing

This page is intentionally left blank

To:
Licensing Authority
Brent Council
Brent Civic Centre
Engineers Way
Wembley
HA9 0FJ

25th January 2019

Dear Licensing Authority Team,

Re: **Notice of application for a New Premises License at 164 Watford Road, Wembley, HA0 3HB by Applicant 'Co-operative Group Food Limited'. (A copy of this correspondence has also been posted to Brent Civic Centre -Tracking no. GK083450040GB & delivered on 29-01-2019 at 7.42am - & signed for)**

I live [REDACTED] - [REDACTED] - & have seen that an application for a New Premises Licence has been submitted for the sale of alcohol between 06:00-23:00 Monday-Sunday. I would like to object to the application for the reasons below:

1) Increased Litter from Alcohol Bottles & Beer Cars:

I personally already experience regular littering due to discarded beer cans & alcohol bottles thrown into my front garden. I have to clear these on a regular basis, putting myself at risk. The sale of alcohol at 164 Watford Road will further encourage this type of litter especially given the close proximity. It will also infringe on my right to enjoy my front garden. If this type of litter increases, I will need to pay for professional services for the removal, meaning I will also incur financial expense.

2) Increased Anti-Social Behaviour due to Alcohol selling hours:

We already have regular anti-social behaviour in the area, mostly in the way of the drunken fights & noise – which is very intimidating for local residents. The cheaper & more widely-available option for alcohol on sale 17hours daily, 7 days a week is only going to increase this anti-social behaviour.

3) Alternative Retail Outlet selling Alcohol is already available in the immediate area:

Alcohol is already available for purchase at Premier Vineyards & Food at 10 Court Parade, East Lane, Wembley HA0 3HU - approximately 100 yards away from 164 Watford Road. This has been the case for many years now. In view of this, I cannot see the reason an additional retail outlet selling alcohol in the immediate area is needed.

To Conclude:

The construction of the new mixed-use building within [REDACTED] of my home is already causing me much stress & concern, but this is heightened further by the proposal to sell alcohol.

Having spoken to my neighbours at Watford Rd, they are also concerned about this Licensing application & will also be submitting their objections.

I look forward to your response.

Kind regards,

[REDACTED]

This page is intentionally left blank

JS 0426 8249 0GB

SD 1pm

From:

To:
Licensing Authority
Brent Council
Brent Civic Centre
Engineers Way
Wembley
HA9 0FJ



Received

05 FEB 2019

DIGITAL POSTROOM
10

2th February 2019

Dear Sirs,

Re: Notice of application for a New Premises License at 164 Watford Road, Wembley, HA0 3HB by Applicant 'Co-operative Group Food Limited'.

I am writing to register my objection to the application referenced, on the basis that approval of this application would not promote the licensing objectives of the Licensing Act 2003, particularly the prevention of crime, disorder and anti-social behaviour, public safety and prevention of harm to children.

I am a resident at [REDACTED] which is only [REDACTED] away from 164 Watford Road.

I have seen that an application for a New Premises Licence has been submitted for the sale of alcohol between 06:00-23:00 Monday-Sunday. My reasons for my objection are as follows;

I experience litter lying on and surrounding my property quite often, mostly being from alcoholic drink bottles and cans which I am left to clean up which is not only a risk to myself but is a great inconvenience and is unfair. If this licence was to be approved, this would only get worst. I want to be able to enjoy my front garden without having it abused by trash.

Also Despite that it is situated on a main road, it is still a residential neighbourhood where people have the right to enjoy their home without the disruption of noise and disruption. Should late night opening with the sale of alcohol be approved it will encourage late night noise, disruption and activities which will impact on the ability of the surrounding residents to enjoy decent sleep and impact their well-being. This is also the case in the early morning where the applicant seeks to open at 6 am. Again, we currently enjoy relative

quietness through to about 8am when work and school traffic builds. I feel I should have a reasonable expectation to a decent sleep in my home.

Licensing Act 2003 Objective - Public safety

Consideration of the proposed application gives incentive for public nuisance vice prevention of public nuisance as the hours proposed (specifically the anti-social licensing hours) do not benefit the amenity enjoyed by residents surrounding 164 Watford Road. All prior businesses at 164 Watford Road closed up between 6 and 7 pm and opened between 8 and 10 am. Those business hours had minimal impact on the neighbouring residents.

Licensing Act 2003 Objective - Prevention of Harm to Children

I have a young child who lives with me [REDACTED] This recent application has raised huge concern to me of the safety of my child. If the front gardens of the residences surrounding 164 Watford Road become increasingly littered with broken bottles and sharp cans as a result of the sale of alcohol, especially the late night anti-social hours proposed, it will pose a direct threat to the health and safety of not only of my child but to to children living in, or visiting the surrounding homes, and indeed to any residents and pets. This is cause for distress.

There are already many stores that have a licence to sell alcohol for residents in this area (East Lane, Shell Garage, Sudbury, North Wembley, John Lyon Roundabout). We are not in need for another licenced premise as this will only encourage disruptive behaviour to the area.

It is completely unclear why the very late night and very early morning sale of alcohol would be under consideration, when the partial outcome would be negative and detrimental to the immediate residential population. Residents should have a reasonable expectation that they can enjoy a nights sleep in their own homes and enjoy their gardens without litter deposition and also being able to feel safe.

Alcohol is already available for purchase at Premier Vineyards & Food at 10 Court Parade, East Lane, Wembley HA0 3HU - approximately 100 yards away from 164 Watford Road. This has been the case for many years now. In view of this, I cannot see the reason an additional retail outlet selling alcohol in the immediate area is needed.

To Conclude: . . .

The construction of the new mixed-use building within 2 metres of my home is already causing me much stress & concern, but this is heightened further by the proposal to sell alcohol.

Having spoken to my neighbours at Watford Rd, they are also concerned about this Licensing application & will also be submitting their objections.

I look forward to your response.

Yours faithfully,

[Redacted signature]

This page is intentionally left blank



From:

[REDACTED]
[REDACTED]
[REDACTED]
[REDACTED]

To:

Licensing Authority

Brent Council

Brent Civic Centre

Engineers Way

Wembley

Middlesex, HA9 0FJ

27 January 2019

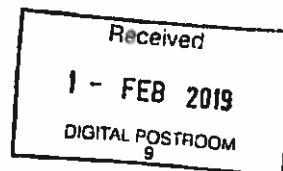

REF: Licensing Act 2003 Notice of application for a New Premises Licence at 164 Watford Road, Wembley, Middlesex, HA0 3HB, by Applicant 'Co-operative Group Food Limited' for the sale of alcohol for consumption off the premises between Monday-Sunday 06:00-23:00.

To Whom It May Concern,

I am writing to register my objection to the application referenced, on the basis that approval of this application would not promote the licensing objectives of the Licensing Act 2003, particularly the prevention of crime, disorder and anti-social behaviour, public safety and prevention of harm to children.

Representation is made on the following grounds:

Licensing Act 2003 Objective - Prevention of crime and disorder

Situated between two licensed premises on the Watford Road, my front garden is already used to dump alcohol bottles and beer cans. This means I have to collect and dispose of this litter. Approval of a licence application almost at my doorstep would increase this burden which would not be of my making and would detract from the enjoyment and use of my home.

Increased alcohol availability in the area especially during the anti-social operating hours proposed by the Co-operative Group for 164 Watford Road, would likely draw an element of anti-social and nuisance behaviour by loitering individuals or congregating groups of unruly people at some point. This kind of situation is already visible outside other outlets in the area selling alcohol, especially during the summer months. This can lead to threat, intimidation and abuse of people and property in the surrounding area. The application to sell alcohol late night, if approved would bring this type of environment right to our doorsteps.

As this is predominantly a residential neighbourhood, it is reasonably quiet aside from road noise, which, once the bulk of the work traffic has diminished coincides with the time the majority of the

working population seeks to sleep. Should late night opening with the sale of alcohol be approved it will encourage late night noise, disruption and activities which will impact on the ability of the surrounding residents to enjoy decent sleep and impact their well-being. This will also hold true in the early morning where the applicant seeks to open at 6 am. Again, we currently enjoy relative quietness through to about 8am when work and school traffic builds. I feel I should have a reasonable expectation to a decent sleep in my home.

Licensing Act 2003 Objective - Public safety

Consideration of the proposed application gives incentive for public nuisance vice prevention of public nuisance as the hours proposed (specifically the anti-social licensing hours) do not benefit the amenity enjoyed by residents surrounding 164 Watford Road. All prior businesses at 164 Watford Road closed up between 6 and 7 pm and opened between 8 and 10 am. Those business hours had minimal impact on the neighbouring residents.

Licensing Act 2003 Objective - Prevention of Harm to Children

If the front gardens of the residences surrounding 164 Watford Road become increasingly littered with broken bottles and sharp cans as a result of the sale of alcohol, especially the late night anti-social hours proposed, it will pose a direct threat to the health and safety of any children living in, or visiting the surrounding homes, and indeed to any residents and pets. This is cause for distress.

The applicant is applying to provide a further source of alcohol availability within an area currently saturated with licensed premises (East Lane, Shell Garage, Sudbury, North Wembley, John Lyon Roundabout) all of which are already convenient to residents in the this area for their use. Further saturation, especially with the proposed excessive opening hours is not in the interests of any of the residents surrounding the premises at 164 Watford Road, and is an unwelcome development. It is also the most aggressive opening plan proposed from all the Co-operative stores in the region.

It is completely unclear why the very late night and very early morning sale of alcohol would be under consideration, when the partial outcome would be negative and detrimental to the immediate residential population. Residents should have a reasonable expectation that they can enjoy a night's sleep in their own homes and enjoy their gardens without litter deposition.





From:



To:

Licensing Authority
Brent Council
Brent Civic Centre
Engineers Way
Wembley
Middlesex, HA9 0FJ
30 January 2019

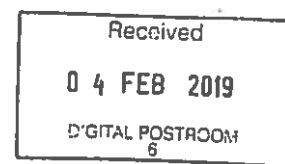

REF: Licensing Act 2003 Notice of application for a New Premises Licence at 164 Watford Road, Wembley, Middlesex, HA0 3HB by Applicant 'Co-operative Group Food Limited' for the sale of alcohol for consumption off the premises between Monday-Sunday 06:00-23:00.

To Whom It May Concern,

I am writing to register my objection to the application referenced on the basis that approval of this application would not promote the licensing objectives of the Licensing Act 2003, particularly the prevention of crime, disorder and anti-social behaviour, public safety and prevention of harm to children.

Representations are made on the following grounds:

Licensing Act 2003 Objective -Prevention of crime and disorder

Situated between two licensed premises on the Watford Road, my front garden is already used to dump alcohol bottles and beer cans. This means I have to collect and dispose of this litter. Approval of a licence application would increase this burden which is not of my making and detracts from the enjoyment and use of my garden.

Increased alcohol availability in the area especially at the proposed anti-social hours proposed at the new development, would likely draw anti-social and nuisance behaviour by individuals or congregating groups of unruly people. This kind of situation is visible outside other outlets in the area selling alcohol, especially during the summer months. This can lead to threat, intimidation and abuse of people and property in the surrounding area. Such an application, if approved would introduce this type of environment to our doorsteps.

As this is predominantly a residential neighbourhood, it is reasonably quiet aside from road noise, which, once the bulk of the work traffic has diminished coincides with the time the majority of the working population seeks to sleep. Should alcohol be for sale up to 11pm it will encourage late night noise and activities which will impact on the ability of us residents the premises at 164 Watford Road to enjoy decent sleep.

Licensing Act 2003 Objective -Public safety

Consideration of the proposed application gives incentive for public nuisance vice prevention of public nuisance as the hours proposed, and specifically the licensing hours do not benefit any amenity enjoyed by local residents by this premises. All prior businesses at 164 Watford Road closed up between 6 and 7 pm daily.

Licensing Act 2003 Objective –Prevention of Harm to Children

If the front gardens of the adjoining residences become littered with broken bottles and sharp cans, it will pose a direct threat to the health and safety of any children and indeed to any residents.

The applicant is applying to provide a further source alcohol within an area currently saturated with licensed premises (East Lane, Esso Garage, Sudbury, North Wembley, John Lyon Roundabout) all of which are already convenient to residents in the this area. Further saturation, especially with the proposed excessive opening hours is not in the interests of any of the residents surrounding the premises at 164 Watford Road. It is also the most aggressive opening plan proposed of all the Co-operative stores in the region. It is completely unclear why there would be a call for such opening hours in a residential area such as this.

Sincerely,

[REDACTED]

Co-op 164 Watford Road HA0 3HB

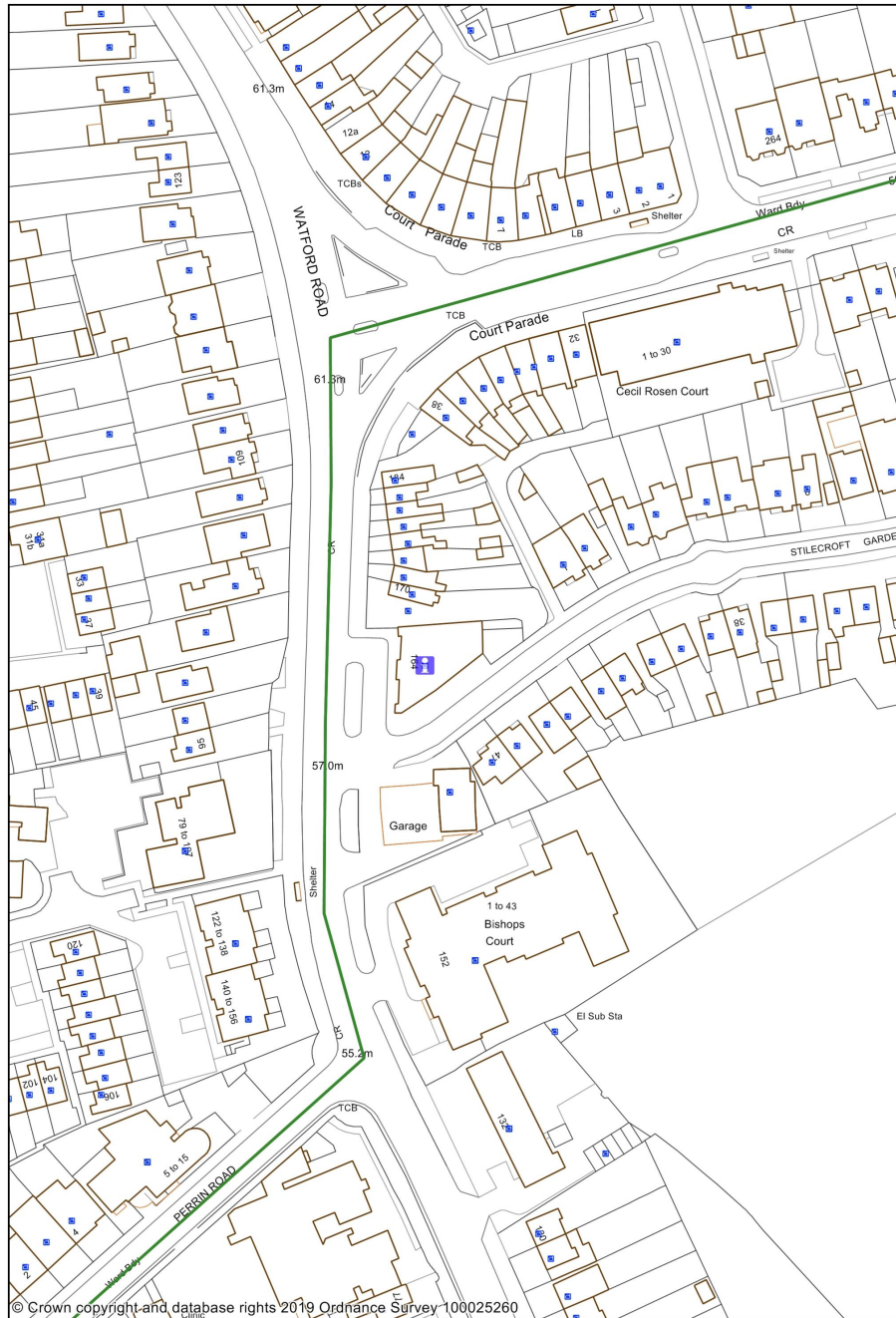

© Crown copyright and database rights 2019 Ordnance Survey 100025260

1:1250

0 0.02 0.04 kilometres



This page is intentionally left blank