



ENVIRONMENT & NEIGHBOURHOOD
REGULATORY SERVICES
BRENT CIVIC CENTRE
ENGINEERS WAY
WEMBLEY
HA9 0FJ

TEL: 020 8937 5359
EMAIL: business.licence@brent.gov.uk

London Borough of Brent

Premises Licence

PART A

*This Premises Licence was granted by Brent Council, Licensing Authority for the area of the Borough of Brent under the **Licensing Act 2003**.*

Signed.....
Director of Environment and Neighbourhood

Date: 1 October 2014

Licence number 201354

Licence start date: 24/11/2005

Premises Details

BAR07, 217 Kenton Road, Harrow, HA3 0HD
Telephone: 020 8907 0944

Licensable activities and the times authorised by this licence

Films:

Day	Start Time	End Time
Monday	10:00	01:30
Tuesday	10:00	01:30
Wednesday	10:00	01:30
Thursday	10:00	01:30
Friday	10:00	01:30
Saturday	10:00	01:30
Sunday	10:00	01:30

Non standard timings: An additional hour to the standard and non standard times on the day when British Summertime Commences.

New Years Eve from the end of permitted hours on New Years Eve to the start of permitted hours on New year's day.

Live music:

Day	Start Time	End Time
Monday	10:00	01:30
Tuesday	10:00	01:30
Wednesday	10:00	01:30
Thursday	10:00	01:30
Friday	10:00	01:30
Saturday	10:00	01:30
Sunday	10:00	01:30

Non standard timings: An additional hour to the standard and non standard times on the day when British Summertime Commences.

New years eve from the end of permitted hours on New years eve to the start of permitted hours on New year's day.

Performance of dance:

Day	Start Time	End Time
Monday	10:00	01:30
Tuesday	10:00	01:30
Wednesday	10:00	01:30
Thursday	10:00	01:30
Friday	10:00	01:30
Saturday	10:00	01:30
Sunday	10:00	01:30

Non standard timings: An additional hour to the standard and non standard times on the day when British Summertime Commences.

New years eve from the end of permitted hours on New years eve to the start of permitted hours on New year's day.

Provision of Entertainment Facilities for Making Music:

Day	Start Time	End Time
Monday	10:00	01:30
Tuesday	10:00	01:30
Wednesday	10:00	01:30
Thursday	10:00	01:30
Friday	10:00	01:30
Saturday	10:00	01:30
Sunday	10:00	01:30

Non standard timings: An additional hour to the standard and non standard times on the day when British Summertime Commences.

New years eve from the end of permitted hours on New years eve to the start of permitted hours on New year's day.

Provision of Entertainment Facilities for Dancing:

Day	Start Time	End Time
Monday	10:00	01:30
Tuesday	10:00	01:30
Wednesday	10:00	01:30
Thursday	10:00	01:30
Friday	10:00	01:30
Saturday	10:00	01:30
Sunday	10:00	01:30

Non standard timings: An additional hour to the standard and non standard times on the day when British Summertime Commences.

New years eve from the end of permitted hours on New years eve to the start of permitted hours on New year's day.

Provision of Late Night Refreshment:

Day	Start Time	End Time
Monday	23:00	01:30
Tuesday	23:00	01:30
Wednesday	23:00	01:30
Thursday	23:00	01:30
Friday	23:00	01:30
Saturday	23:00	01:30
Sunday	23:00	01:30

Non standard timings: An additional hour to the standard and non standard times on the day when British Summertime Commences.

New years eve from the end of permitted hours on New years eve to the start of permitted hours on New year's day.

Supply of alcohol:

Day	Start Time	End Time
Monday	10:00	01:30
Tuesday	10:00	01:30
Wednesday	10:00	01:30
Thursday	10:00	01:30
Friday	10:00	01:30
Saturday	10:00	01:30
Sunday	10:00	01:30

Non standard timings: An additional hour to the standard and non standard times on the day when British Summertime Commences.

New years eve from the end of permitted hours on New years eve to the start of permitted hours on New year's day.

Recorded Music may be provided throughout the premises without limitation.

Whether alcohol is authorised to be supplied on or off the premises: **On**

The Opening Hours of the Premises:

Day	Start Time	End Time
Monday	10:00	02:00
Tuesday	10:00	02:00
Wednesday	10:00	02:00
Thursday	10:00	02:00
Friday	10:00	02:00
Saturday	10:00	02:00
Sunday	10:00	02:00

Non standard timings: An additional hour to the standard and non standard times on the day when British Summertime Commences.

New years eve from the end of permitted hours on New year's eve to the start of permitted hours on New year's day.

Part 2

Details of Holder of Premises Licence:

Name: Mr. Louriston Michael Lorainey
Address:
Telephone:
Email:

Details of Designated Premises Supervisor:

Name: Mr Louriston Michael Lorainey
Address:
Personal
Issuing authority: London Borough of Brent

Annexe 1 - Mandatory Conditions

(a) No supply of alcohol may be made at a time when no designated premises supervisor has been specified in the licence or at a time when the designated premises supervisor does not hold a personal licence or his or her licence has been suspended.

(b) Every supply of alcohol under the premises licence must be made or authorised by a person who holds a personal licence.

(c) The premises licence holder or club premises certificate holder shall ensure that an age verification policy applies to the premises in relation to the sale or supply of alcohol.

(d) The responsible person shall take all reasonable steps to ensure that staff on relevant premises do not carry out, arrange or participate in any irresponsible promotions in relation to the premises.

An irresponsible promotion means any one or more of the following activities, or substantially similar activities, carried on for the purpose of encouraging the sale or supply of alcohol for consumption on the premises in a manner which carries a significant risk of leading or contributing to crime and disorder, prejudice to public safety, public nuisance, or harm to children:-

(i) games or other activities which require or encourage, or are designed to require or encourage, individuals to:

- drink a quantity of alcohol within a time limit (other than to drink alcohol sold or supplied on the premises before the cessation of the period in which the responsible person is authorised to sell or supply alcohol), or
- drink as much alcohol as possible (whether within a time limit or otherwise);

(ii) provision of unlimited or unspecified quantities of alcohol free or for a fixed or discounted fee to the public or to a group defined by a particular characteristic (other than any promotion or discount available to an individual in respect of alcohol for consumption at a table meal, as defined in section 159 of the Act);

(iii) provision of free or discounted alcohol or any other thing as a prize to encourage or reward the purchase and consumption of alcohol over a period of 24 hours or less;

(iv) provision of free or discounted alcohol in relation to the viewing on the premises of a sporting event, where that provision is dependent on–

- the outcome of a race, competition or other event or process, or
- the likelihood of anything occurring or not occurring;

(v) selling or supplying alcohol in association with promotional posters or flyers on, or in the vicinity of, the premises which can reasonably be considered to condone, encourage or glamorise anti-social behaviour or to refer to the effects of drunkenness in any favourable manner.

(e) The responsible person shall ensure that no alcohol is dispensed directly by one person into the mouth of another (other than where that other person is unable to drink without assistance by reason of a disability).

(f) The responsible person shall ensure that free tap water is provided on request to customers where it is reasonably available.

(g) The premises licence holder or club premises certificate holder shall ensure that an age verification policy applies to the premises in relation to the sale or supply of alcohol.

The policy must require individuals who appear to the responsible person to be under 18 years of age (or such older age as may be specified in the policy) to produce on request, before being served alcohol, identification bearing their photograph, date of birth and a holographic mark.

(h) The responsible person shall ensure that-

(i) where any of the following alcoholic drinks is sold or supplied for consumption on the premises (other than alcoholic drinks sold or supplied having been made up in advance ready for sale or supply in a securely closed container) it is available to customers in the following measures-

- beer or cider: half pint;
- gin, rum, vodka or whisky: 25ml or 35ml; and
- still wine in a glass: 125ml; and

(ii) customers are made aware of the availability of these measures.

(i) A relevant person shall ensure that no alcohol is sold or supplied for consumption on or off the premises for a price which is less than the permitted price.

Embedded Conditions

Not Applicable

Annexe 2 - Conditions Consistent With the Operating Schedule

- 1 A minimum of two door supervisors with a gender mix shall be employed from 21:00 hours on any day where the premises are open for sale of alcohol past midnight and that door supervisors wear high visibility clothing.
- 2 A register/log containing the names, badge number, dates & times of duty of security staff and any incidents that occur shall be kept and made available to the Police and Licensing Authority.
- 3 Customers shall not be permitted to take open glass containers outside the premises as defined on the plan submitted to and approved by the Licensing Authority.
- 4 CCTV shall be installed and maintained in a working condition.
- 5 All CCTV recordings shall be kept for 31 days and shall be made readily available to police and licensing officers on demand.
- 6 A copy of the premises licence summary including the hours which licensable activities are permitted shall be visible from the outside of each entrance to the premises.
- 7 The total number of people permitted on the premises including staff and performers shall not exceed 100.
- 8 Notices requesting customers to leave quietly shall be displayed at each exit.
- 9 Door supervisors or when no door supervisor is present a suitable member of staff shall supervise the exit of every person from the premises and instruct each person to leave the area quietly.
- 10 Notices shall be displayed throughout the premises advising that CCTV is in operation.
- 11 The licensee or his/her deputy shall be a member of, and actively participate in the local pubwatch scheme.
- 12 All alcohol and soft drinks shall be served in plastic or toughened glasses.
- 13 Any person who appears to be under the age of 18 shall be required to produce proof of age and the Licensee shall only accept photo I.D. such as passport or driving licence as proof of age or other form of identification agreed with the police.
- 14 A free "hot line" to a local taxi company shall be made available to customers.
- 15 Facilities within the premises shall be made available for customers to await taxis.
- 16 A refusal book shall be kept and maintained at all times and reasons for refusal to be cited in the book which is to be made readily available to police and licensing officers on demand.
- 17 Music shall be played at a quieter level for the last 30 minutes of trading during which time the levels of lighting shall be raised.

- 18 No person under the age of 18 shall be allowed to enter or remain on the premises after 21:00 hours.
- 19 No person under the age of 18 shall be admitted to any part of the premises where entertainment of an adult nature is being provided.
- 20 Toilets should be checked every two hours for the use of drugs and other illegal activities.
- 21 Notices clearly explaining the licensee's drugs and weapons policy shall be displayed at the entrance and at suitable places throughout the premises.
- 22 Any locks and bolts on exit doors shall be unlocked and kept free from fastenings other than push bars whilst the public are on the premises.
- 23 The gates from the rear yard shall be kept unlocked and be easily opened when the public are on the premises.
- 24 The roller shutter to the front entrance/exit door shall be fixed in the open position whilst the public are on the premises.
- 25 The socket outlets (or other power supplies used for DJ equipment, band equipment and other portable equipment) that are accessible to performers, staff or the public shall be suitably protected by a residual current device (RCD having a rated residual operating current not exceeding 30 milliamps).

Annexe 3 - Conditions Attached After a Hearing by the Licensing Authority

1. Door supervisors, or when no door supervisors are on duty a suitable member of staff, must supervise the exit of every person from the premises, and instruct each person to leave the area quietly
2. Signs must be displayed at each entry and exit to the premises and/or licensed area instructing customers to respect the surrounding neighbours and leave quietly.

Annexe 4 - Plans

See attached sheet.

MASTERS FREE HOUSE
 217 KENTON ROAD
 HA3 0HD

SCALE 1 : 100
 DRAWING: CH/L/4

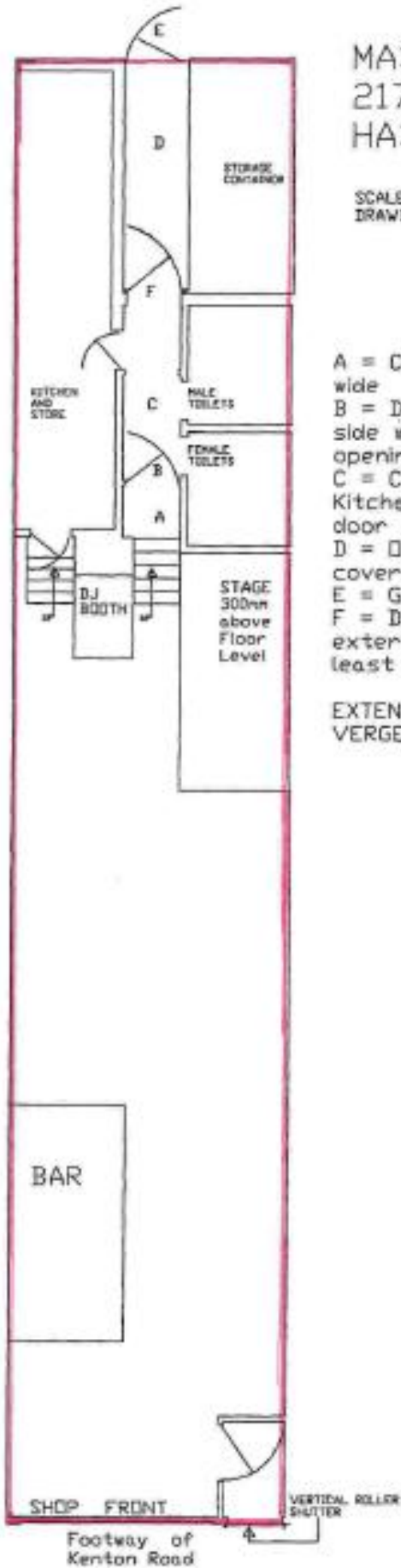

- A = Corridor at top of stairway 1120mm wide
- B = Door opening with frame set into side walls of corridor and giving a clear opening of at least 1050mm wide
- C = Corridor to Toilet Facilities and Kitchen and onwards to final rear exit door 1120mm wide
- D = Open area part of rear yard not covered
- E = Gate
- F = Door opening with frame secured externally to give clear opening of at least 1050mm wide

EXTENT OF PREMISES IS SHOWN
 VERGED RED