

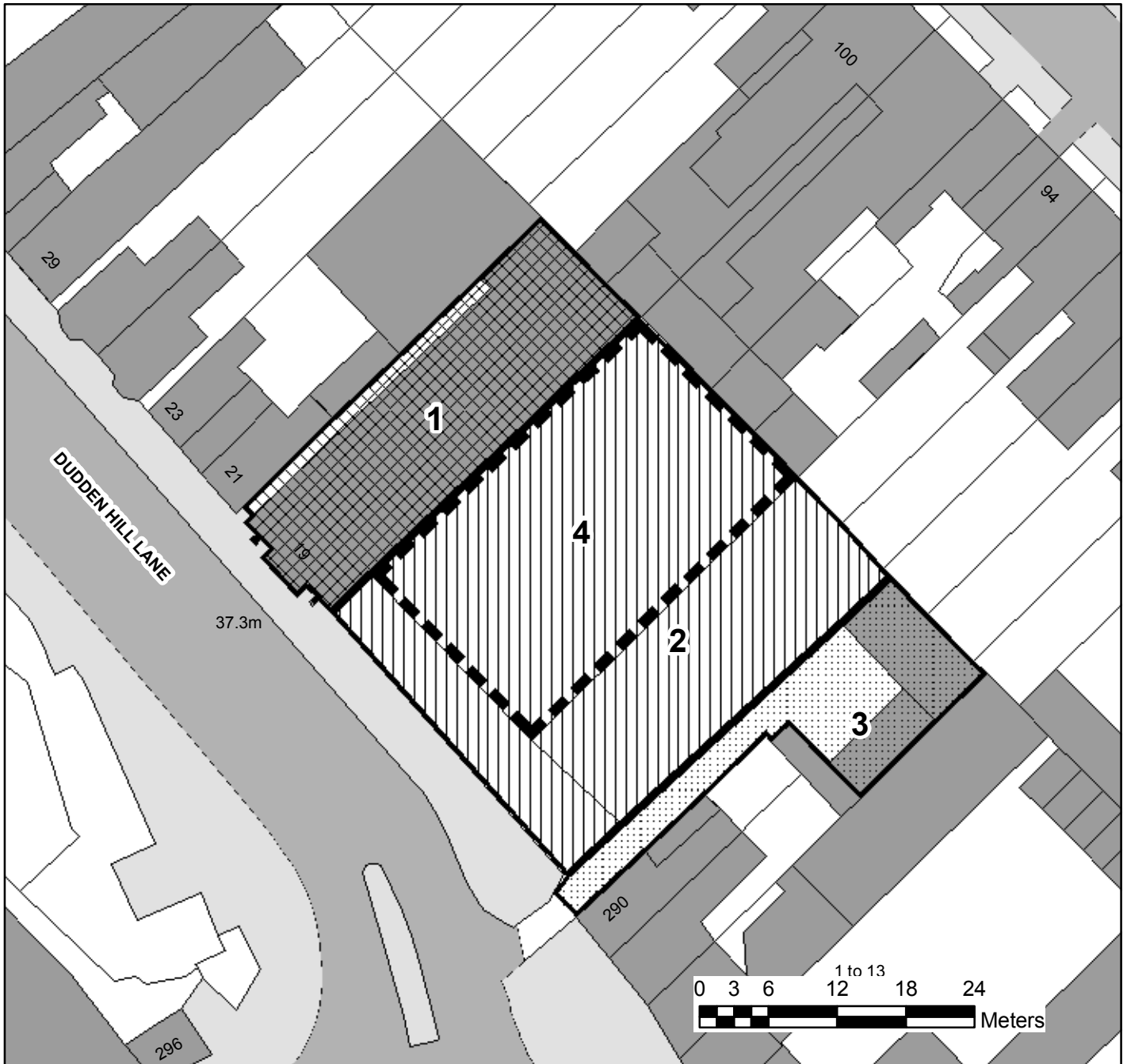



EXECUTIVE COMMITTEE

APPENDIX 1

Open Land Adjacent to 19 Dudden Hill Lane and 290 High Road, Willesden, NW10 2EU



-  1, Brent Indian Community Centre
-  2, Brent Council
-  3, JABAC Finances Ltd
-  4, Informal Space

Plan for information purposes only.

NORTH

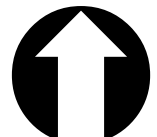

PSMA OS copyright statement

© Crown copyright and database rights 2013 Ordnance Survey 100025260

OS Open data copyright statement:

Contains Ordnance Survey data © Crown copyright and database right 2013