

THIS DRAWING MAY BE USED ONLY FOR THE PURPOSE INTENDED AND ONLY WRITTEN DIMENSIONS SHALL BE USED

NOTES

KEY

DIRECTION OF TRAFFIC IN TRAFFIC LANE (NORMAL OPERATION)

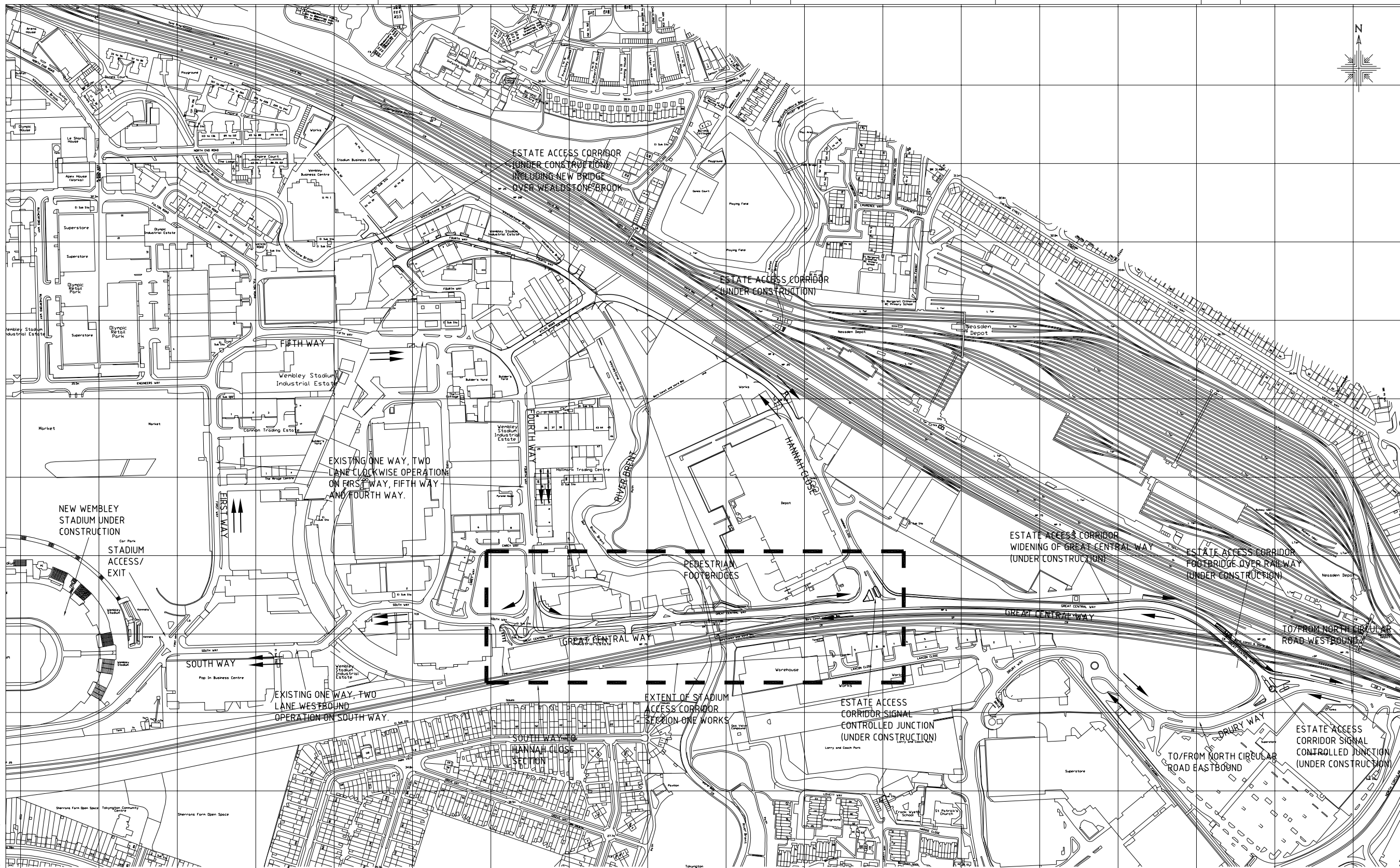

Revision Details	By	Date	Surfix

Drawing Status

Job Title

WEMBLEY PARK SAC SECTION 1

Drawing Title

SOUTH WAY TO HANNAH CLOSE

LOCATION PLAN

Scale at A1

1:5000 AT A3

Drawn AC	Approved
-------------	----------

Stage 1 check RPY	Stage 2 check DAJS	Originated BA	Date NOV 03
----------------------	-----------------------	------------------	----------------

Scott Wilson  
 Scott House  
 Basing View, Basingstoke  
 Hampshire, RG21 4JG  
 Telephone (01256) 461161  
 Fax (01256) 460562  
 www.scottwilson.com



Drawing Number	Rev
----------------	-----

FIGURE 1

BASED ON THE 2001 ORDNANCE SURVEY 1:2500 SCALE DIGITAL MAP WITH THE PERMISSION OF THE CONTROLLER OF HER MAJESTY'S STATIONERY OFFICE. © CROWN COPYRIGHT RESERVED. LICENCE No. AL 10018181  
 SCOTT WILSON KIRKPATRICK

Pld Date : 174Nov03 04:26 PM BY : 14069pe  
 AutoCAD File Name : [BA1] KCD 103832 - Wembley SAC/CAD/Drawings/Sheets/figures1 - Env.dwg [3 Xrefs] OSData.DWG Xref.DWG XSTAGE-LS.DWG